

03. Tremiti Island System

Modular central Unit

Drawers, vanity units, desks, pull-out trays, benches can be combined with each other to create a functional furniture accessory to complete the wardrobe area.

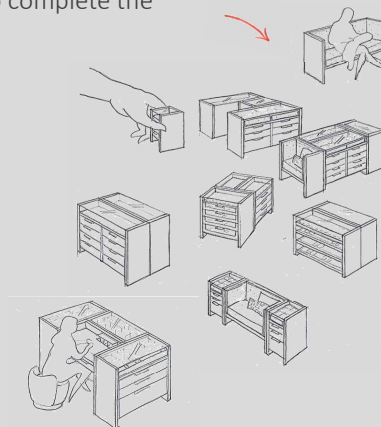

Modular Central Unit
for Walk-in & Wardrobe

TREMITI



Modular Central Unit
for Walk-in & Wardrobe

TREMITI



1. MODULAR CENTRAL UNIT FOR WALK-IN & WARDROBE

Tremiti, a name inspired by the archipelago located in the south of the Adriatic Sea, is a system of low cabinet made up of modular multifunction free standing units. Single “islands” that can be combined with each other to create a functional “archipelago” within the wardrobes and walk-in closets.

Tremiti, nome ispirato all'arcipelago situato nel sud del mare Adriatico, è un sistema di arredo composto da moduli multifunzione componibili free standing. Singole isole che possono essere combinate tra loro a creare un arcipelago funzionale all'interno del guardaroba e delle cabine armadio





Vanity & side units

2. THE MODULES

The Tremiti system is made up of free-standing modules that can be used individually or combined together.

The system provides six modules with six different functions: chest of drawers, pull-out tray, vanity, desk, bench, low bench.

Il sistema Tremiti è composto da moduli free standing utilizzabili singolarmente o combinabili tra loro.

Il sistema prevede sei moduli con sei diverse funzioni: cassetiera, vassoio estraibile, vanity, scrivania, vassoi estraibili, panca, panca bassa

There are six modules with six different functions:
chest of drawers, pull-out tray, vanity, desk, bench, low bench.

Sono disponibili sei moduli con sei differenti funzioni:
cassettiera, vassoio estraibile, vanity, scrivania, panca, panca bassa



Drawers

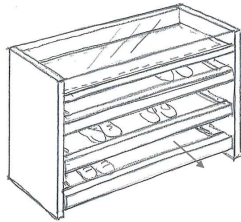

Pull-out Tray

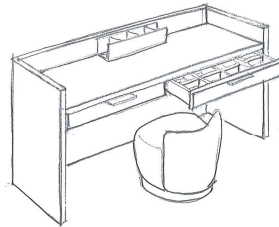

Vanity

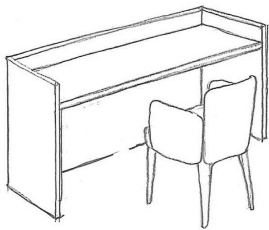

Desk

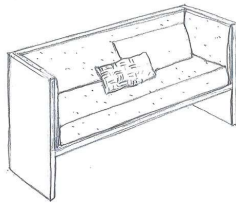

Bench

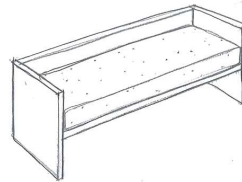

Low Bench



Vanity Unit, Bench and Pull-out Tray

3. TECHNICAL SHEET

The system consists of six modules proposed in two different depths and six different lengths. Each module is structured to be used alone or to be assembled with the other modules.

Il sistema si compone di sei moduli proposti in due diverse profondità e sei diverse lunghezze. Ogni modulo è strutturato per essere utilizzato da solo o per essere assemblato con gli altri moduli.

PLAN_depth & width

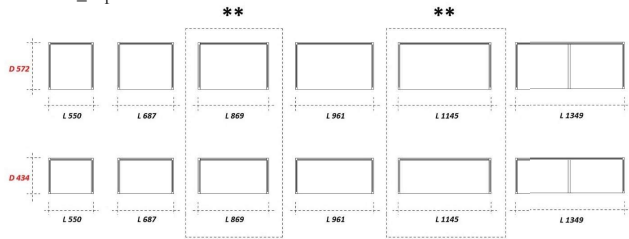

The modules are available in 2 different depths and 6 different lengths

I moduli sono disponibili in due diverse profondità e sei diverse lunghezze

ELEVATION_height

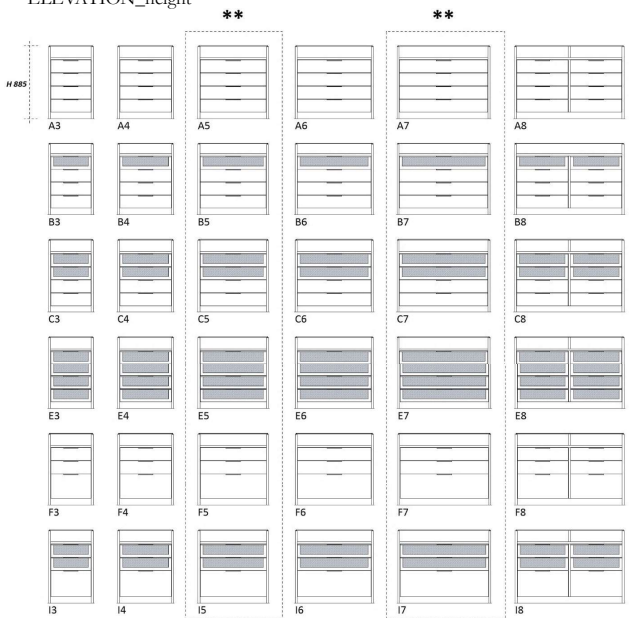

Chest of drawers

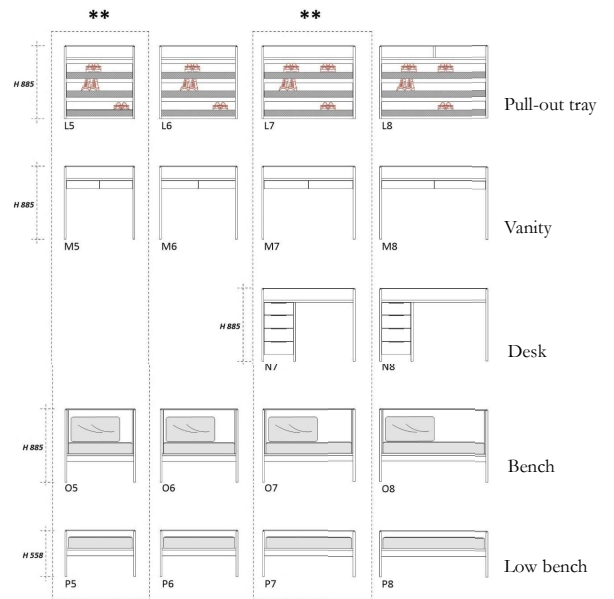

** Modules W 869 and W 1145 can also be used for side

4. COMPOSITIONS

The combination of the modules allows to adapt the composition to the available space. It is therefore possible to consider simple one-module compositions as well as more complex and articulated ones with shape that can be used on all four sides.

With this system it is possible to satisfy, in a flexible way, all the cases that the project seeks by solving any type of project request.

L'accostamento dei moduli permette di adeguare la composizione allo spazio disponibile. È possibile, quindi, considerare composizioni semplici a un modulo come a quelle più complesse ed articolate con composizioni utilizzabili sui quattro lati.

Con questo sistema è possibile soddisfare, in modo flessibile, tutti i casi che il progetto cerca risolvendo qualsiasi tipo di richiesta progettuale

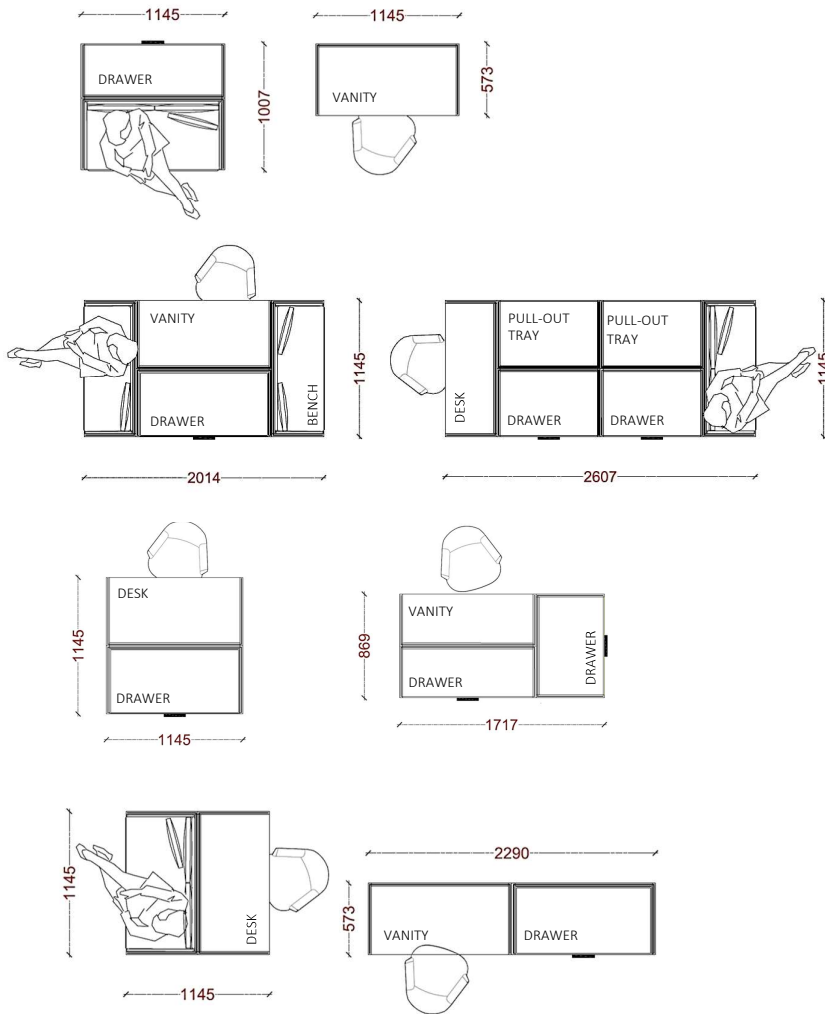

The system is designed to create maximum flexibility in combining the modules, each module can be chosen as needed.

il sistema è pensato per creare la massima flessibilità nell'accostare i moduli, ogni modulo può essere scelto per come serve.

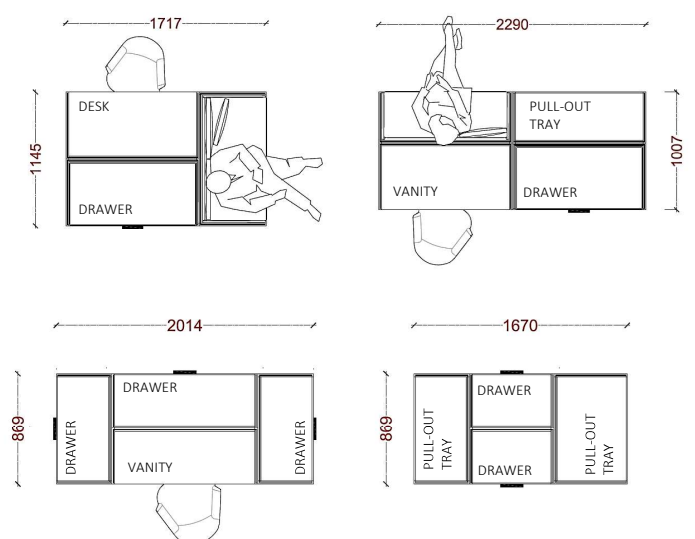

5. ACCESSORIES & FINISHES

The materials proposed to make the islands are those from the Lema collection.

The objective is to create a stylistic unicum with the wardrobes or walk-in wardrobes already selected for the furniture.

The modules can be completed and equipped with optional finishes that personalize and make precious the island.

I materiali proposti per realizzare le isole sono quelli della collezione Lema. L'obiettivo è creare un unicum stilistico con gli armadi o le cabine armadio già selezionati per l'arredo.

I moduli possono essere completati e attrezzati con finiture opzionali che personalizzano e rendono preziosa l'isola.



The modules can be completed and equipped with optional finishes.

Finishes proposed for top:

- Under top synthetic leather tray
- Synthetic leather Pad with stitched patterns for shelf top
- Gres shelf top

Finishes proposed for drawers & pull-out tray:

- Jewelry Belts & Eco leather holder
- Synthetic leather pad
- Drawer divider in melamine
- Drawer divider in synthetic leather



Gres top & drawer's divider



Synthetic leather top & pad



Under top synthetic leather tray



The modules can be completed and equipped with optional finishes.

Accessories proposed for vanity & desk

- Round Mirror
- Folding mirror
- Synthetic leather holder
- Gres top



Round mirror



Folding mirror



Synthetic leather holders

Structure and equipment melamine

Melaminici struttura e attrezzatura

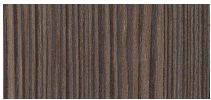

Moka Larch



Bleached Larch



Grey Larch

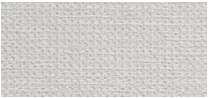

Canvas



Lino



Visone

Metals

Metalli

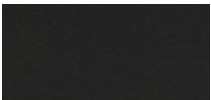

Epoxy bronze painted metal
M421

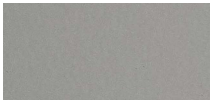

Epoxy sand painted metal
M455

Porcelain stoneware

Gres porcellanato



Gres Calacatta Gold



Gres Laurent Glossy

Transparent glass

Vetro trasparente



Extra light transparent glass



TREMITI

Home Projects Department

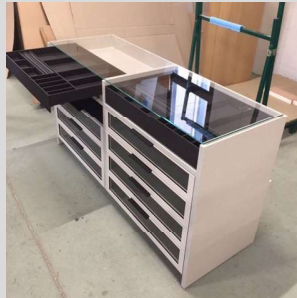

04. Victor & Victoria

Desk & Console Bespoke

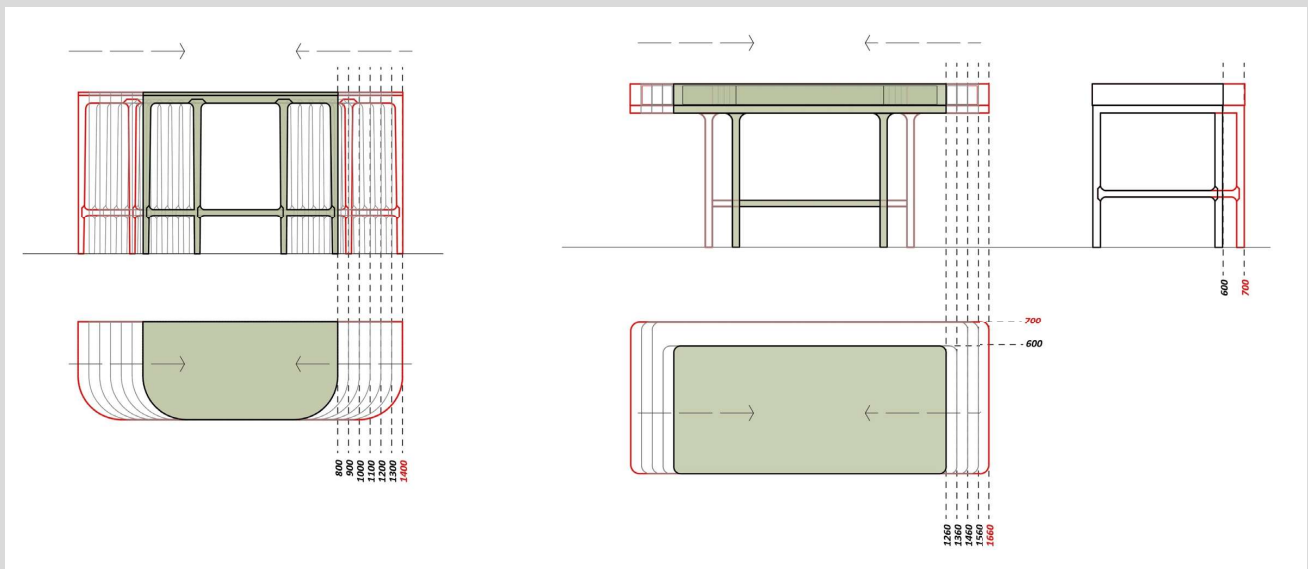





21.02.2022