

## 2. Accessory installation manual

# Plusminus<sup>+</sup><sub>-</sub>

Design by Diez Office



# VIBIA

Next step / Siguiete paso / Nächster Schritt / Passo successivo / L'étape suivante

- Layout composition with supplied paper tape
  - Trazar composición con cinta de papel
- Zusammensetzung mit Papierklebeband nachzeichnen
  - Tracciare la composizione con del nastro di carta
- Tracer la composition avec du ruban adhésif en papier

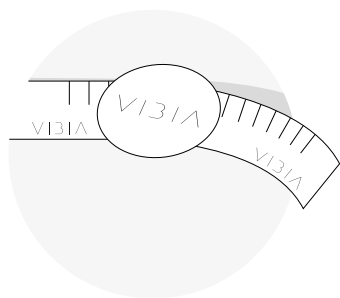
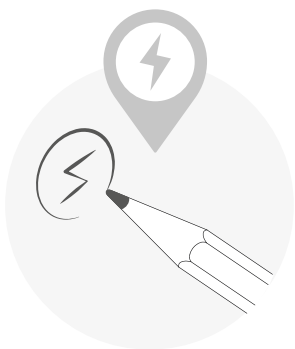
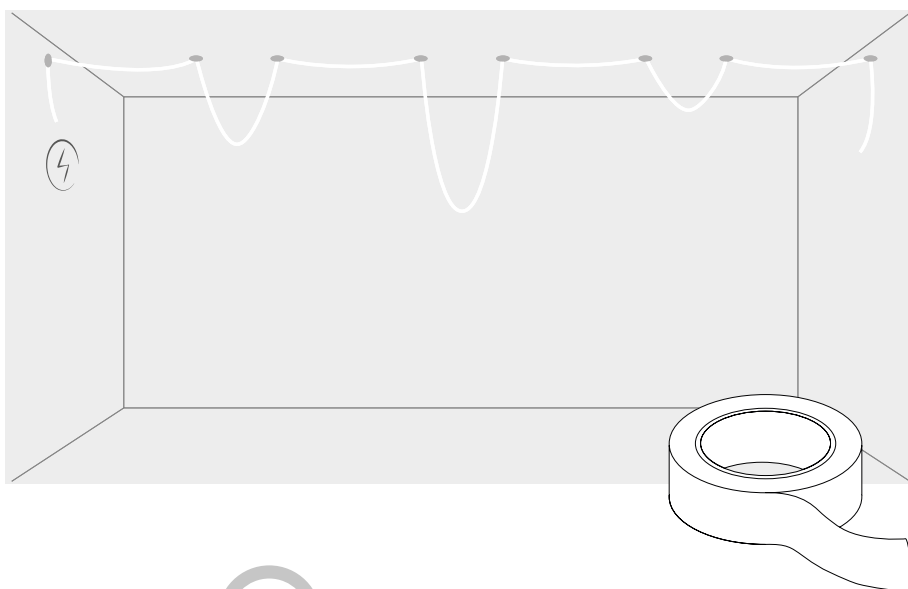

Index / Índice / Index / Indice / Index

## Installation Accessories

Belt Accessories		Fasten Accessories		Tension Clips	
<b>B3</b>	Belt End Cap	<b>7</b>	<b>F1</b>	Circular Ratchet	<b>10</b>
<b>B4</b>	Double End Cap	<b>8</b>	<b>F2</b>	Circular Anchor	<b>12</b>
<b>B5</b>	Pendant End Cap	<b>9</b>	<b>F3</b>	Belt Support	<b>14</b>
			<b>F4</b>	Counterweight	<b>15</b>
			<b>F5</b>	Corner Support	<b>16</b>
			<b>F6</b>	Freestyle Bar <i>Manual inside its box</i>	
			<b>T1</b>	Suspension Clip	<b>17</b>
			<b>T2</b>	V Tension Clip	<b>18</b>
			<b>T3</b>	Parallel Tension Clip S	<b>19</b>
			<b>T4</b>	Parallel Tension Clip M	<b>19</b>
			<b>T5</b>	Cable End Cap	<b>20</b>
			<b>T6</b>	Pendant Cable S	<b>21</b>
			<b>T7</b>	Pendant Cable M	<b>22</b>
			<b>+</b>	Tensor Support	<b>23</b>

## Electrical Connection Accessories

<b>E1</b>	Surface Canopy S Ø 205 mm	Wattage: < 60W	Voltage: 42V	CE	IP20	90-305V	50-60Hz	<b>26</b>
<b>E2</b>	Surface Canopy M Ø 260 mm	Wattage: 60W - 240W	Voltage: 42V	CE	IP20	90-305V	50-60Hz	<b>26</b>
<b>E3</b>	Built-in Canopy Ø 120 mm	Wattage: 25W - 240W	Voltage: 42V	CE	IP20	90-305V	50-60Hz	<b>46</b>
<b>E4</b>	Remote Built-in Canopy Ø 70 mm	Wattage: 25W - 240W	Voltage: 42V	CE	IP20	90-305V	50-60Hz	<b>56</b>
<b>E5</b>	Remote Surface Canopy Ø 60 mm	Wattage: 25W - 240W	Voltage: 42V	CE	IP20	90-305V	50-60Hz	<b>62</b>
<b>E6</b>	Plug-in Floor Switch Ø 90 mm	Wattage: < 60W	Voltage: 42V	CE	IP20	90-305V	50-60Hz	<b>66</b>
<b>E8</b>	Wire Connector Ø 50 mm	Wattage: 25W - 240W	Voltage: 42V	CE	IP20	90-305V	50-60Hz	<b>68</b>

# Installation Accessories

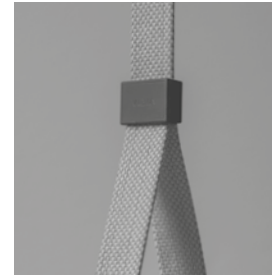
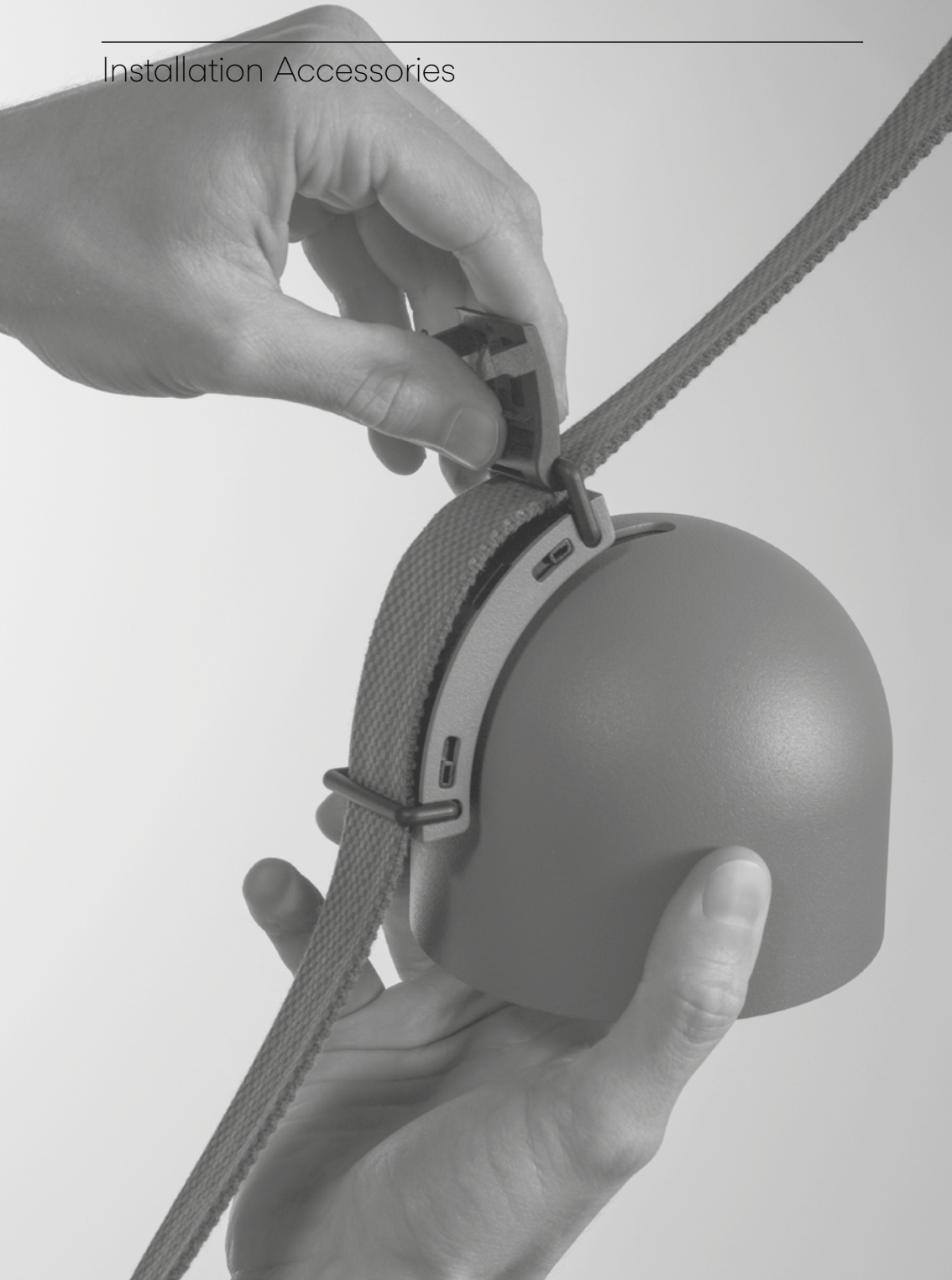

## Belt



**B3**  
Belt End Cap  
Page 7



**B4**  
Double End Cap  
Page 8



**B5**  
Pendant End Cap  
Page 9

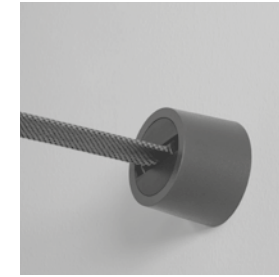

## Fasten



**F1**  
Circular Ratchet  
Page 10



**F2**  
Circular Anchor  
Page 12



**F3**  
Belt Support  
Page 14



**F4**  
Counterweight  
Page 15



**F5**  
Corner Support  
Page 16



**F6**  
Freestyle Bar  
Manual inside its box

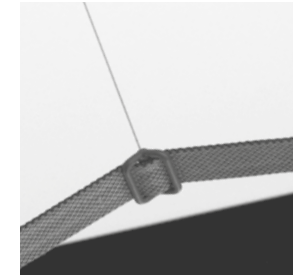

## Tension



**T1**  
Suspension Clip  
Page 30



**T2**  
V Tension Clip  
Page 34



**T3**  
Parallel Tension Clip S  
Page 36



**T4**  
Parallel Tension Clip M  
Page 38



**T5**  
Cable End Cap  
Page 40



**T6**  
Pendant Cable S  
Page 38



**T7**  
Pendant Cable M  
Page 38

## B3 Belt End Cap



Watch video

1.1

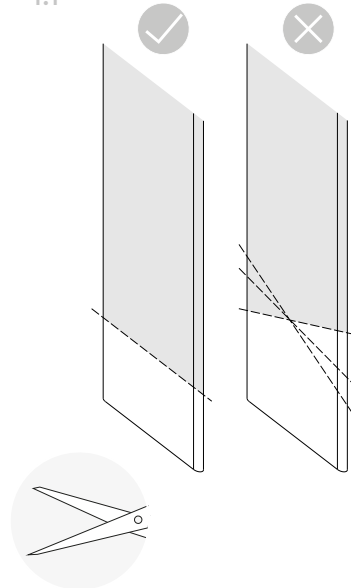

1.2

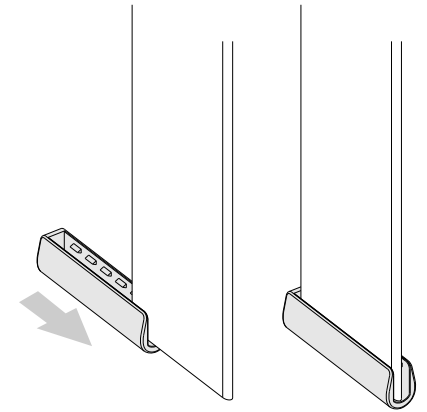

1.3

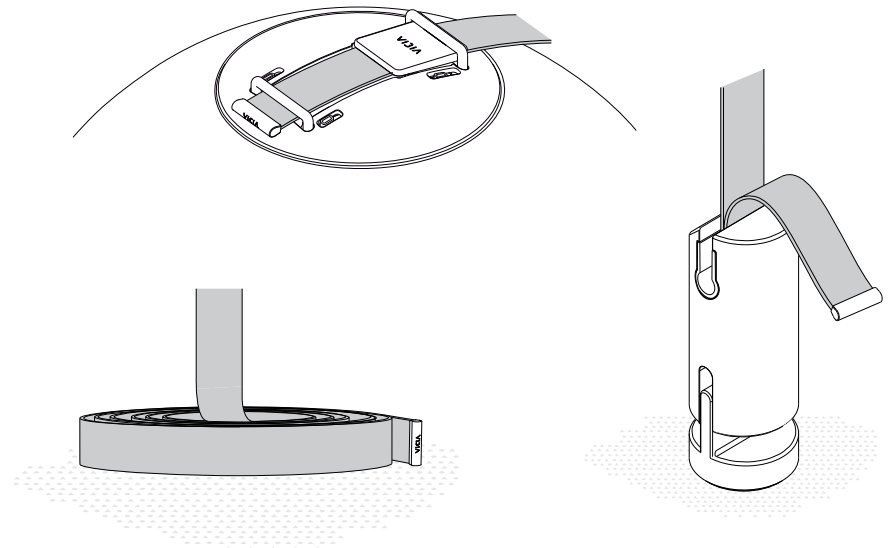



## B4 Double End Cap

Watch video



1.1

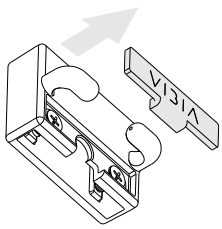

1.2

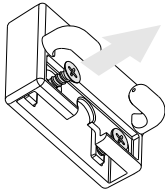

1.3

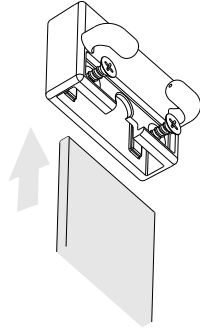

1.4

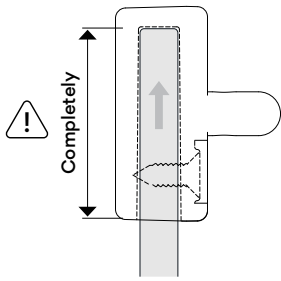

1.5

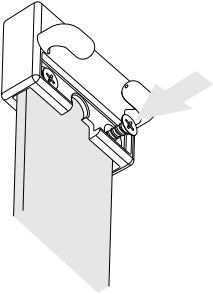

1.6

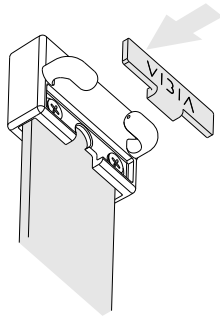

1.7

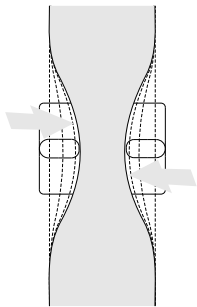

1.8

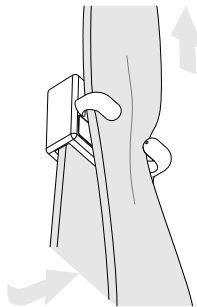

1.9

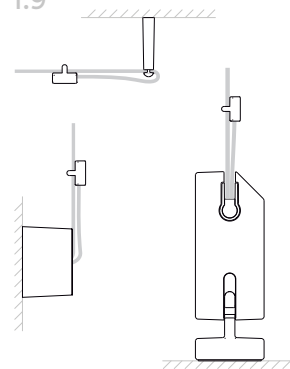

## B5 Pendant End Cap

Watch video



1.1

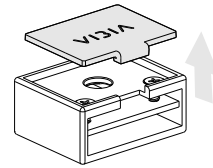

1.2

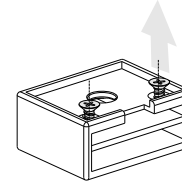

1.3

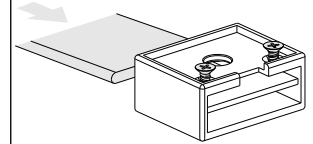

1.4

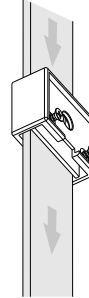

1.5

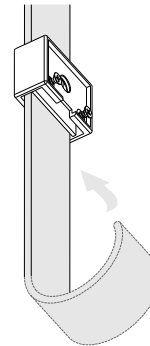

1.6

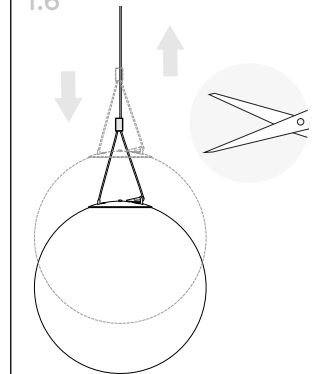

1.7

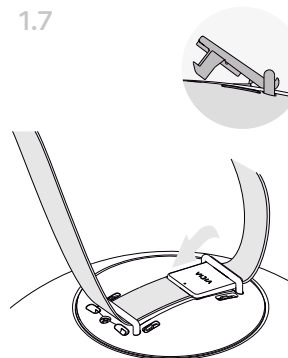

1.8

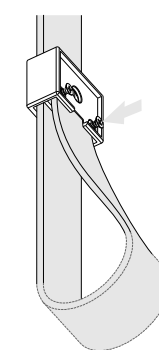

1.9

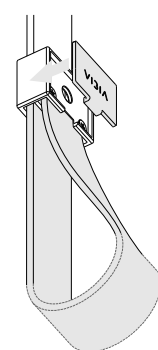

# F1 Circular Ratchet

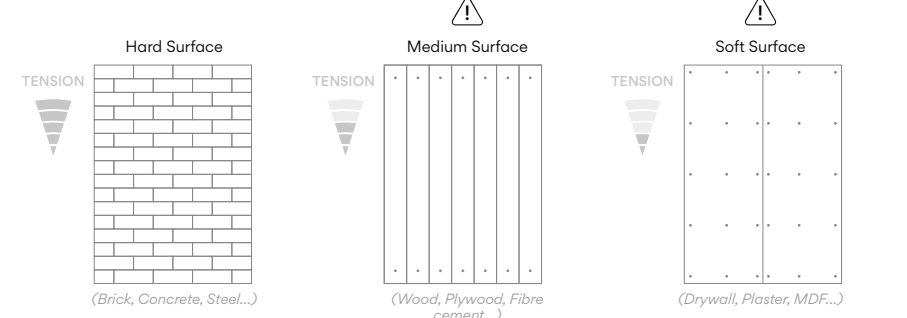
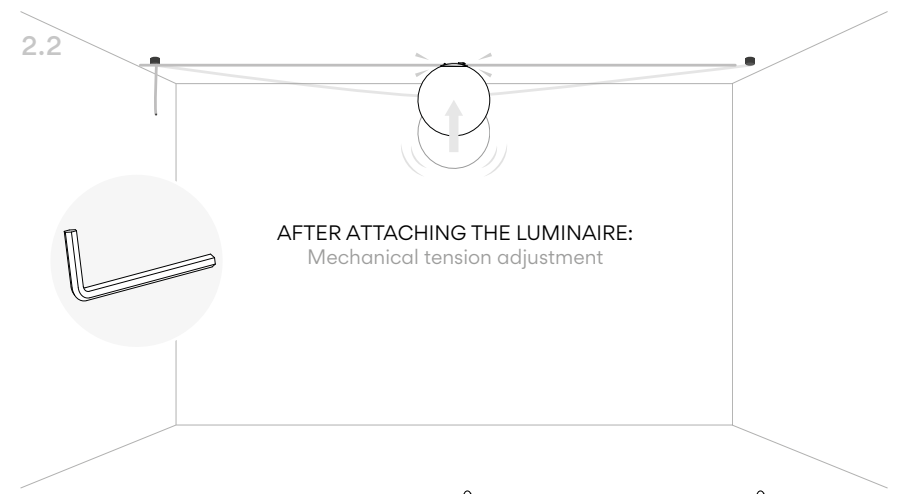
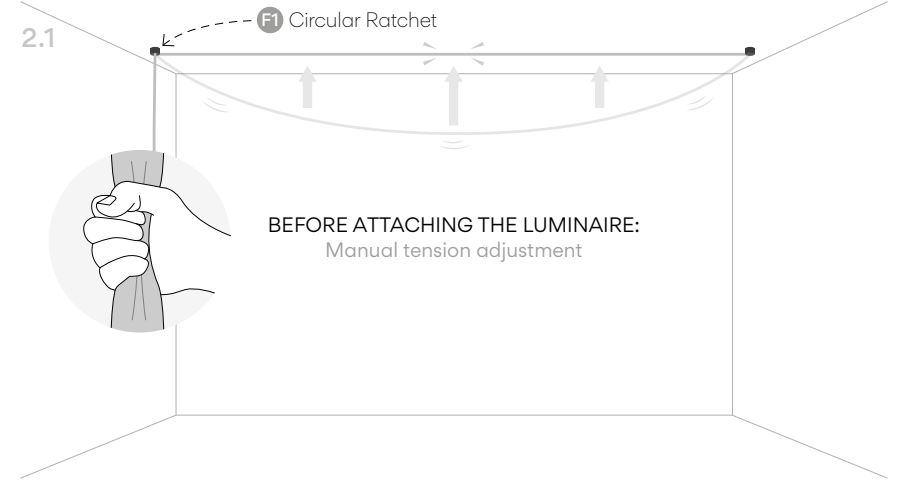
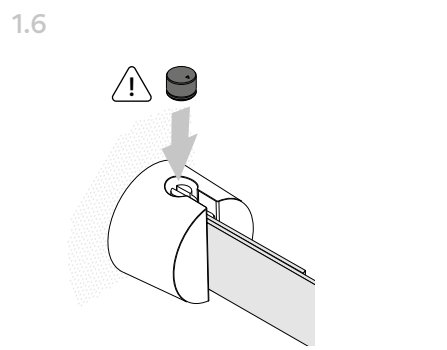
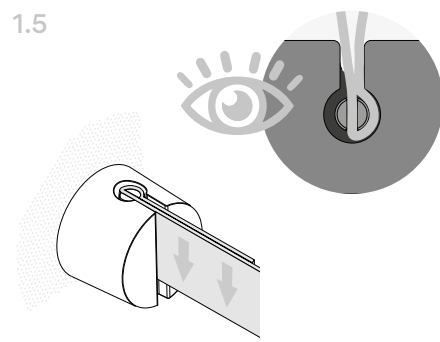
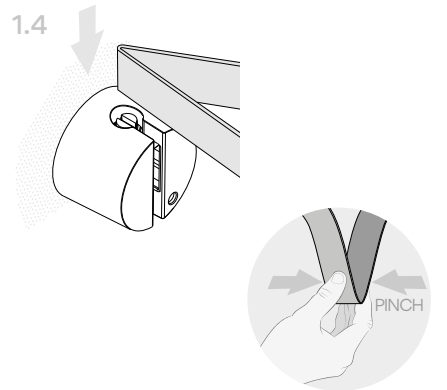
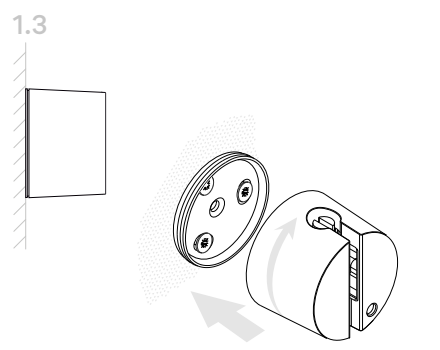
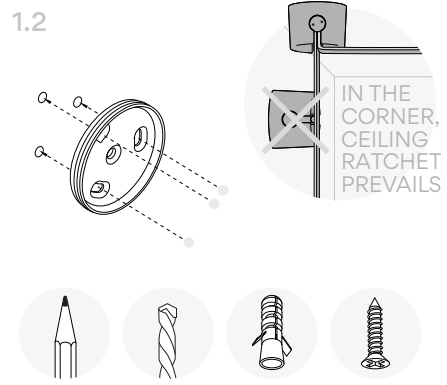
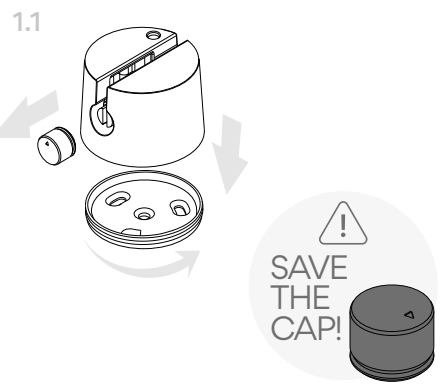

# F2 Circular Anchor

Watch video

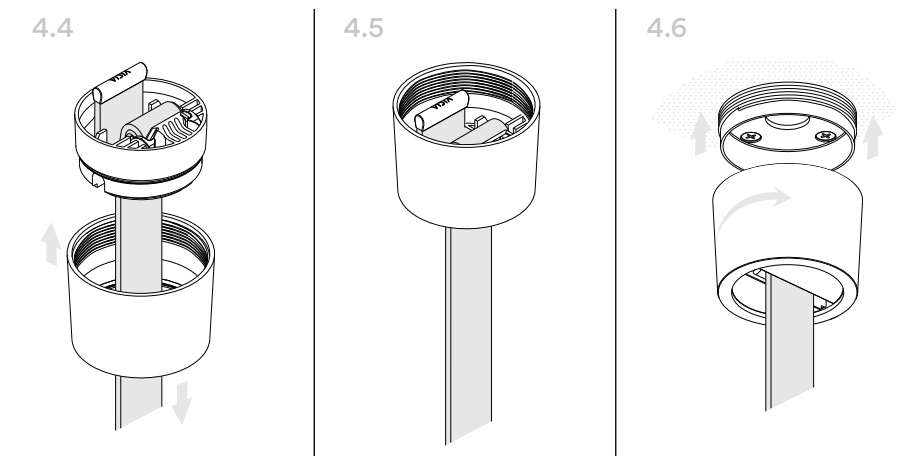
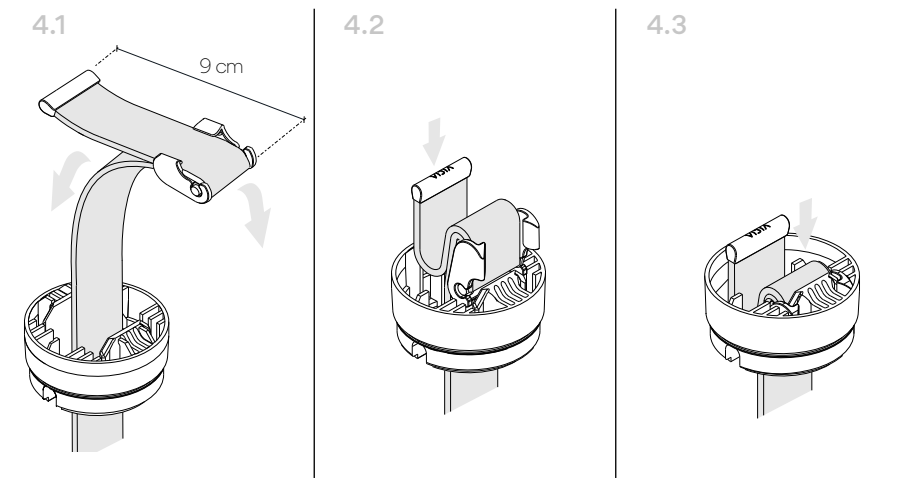
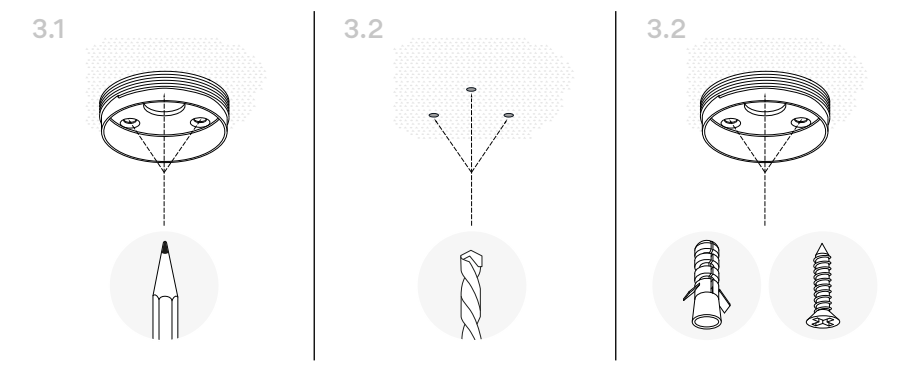
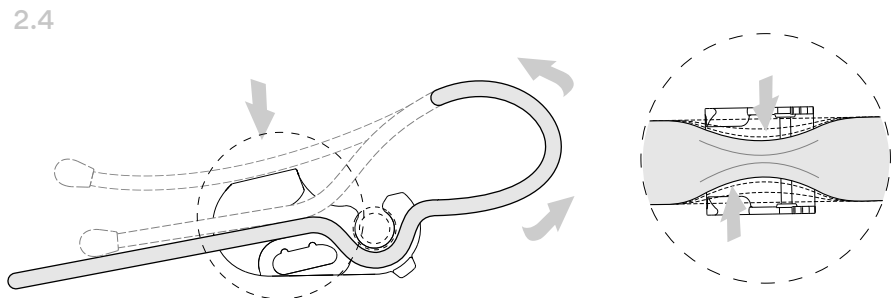
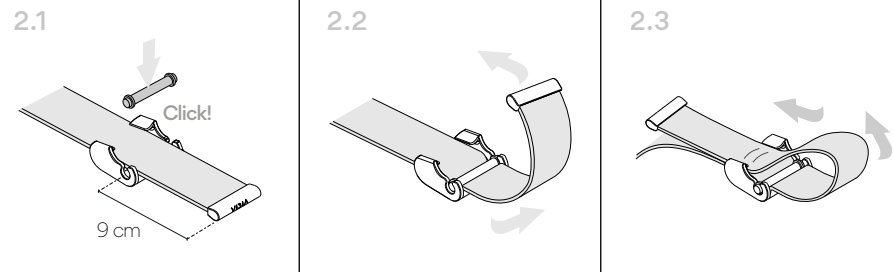
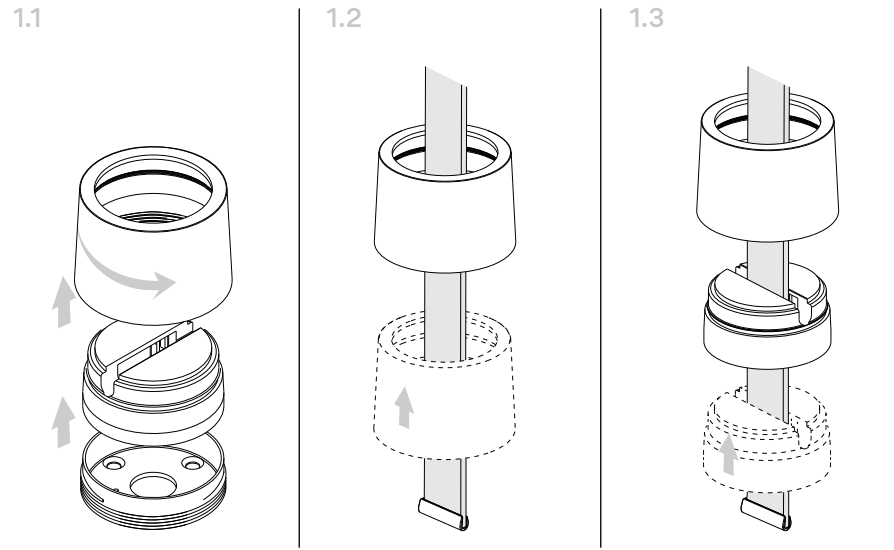

### F3 Belt Support



Watch video

1.1

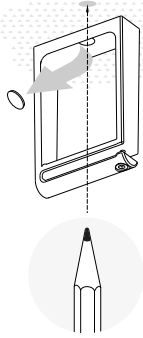

1.2

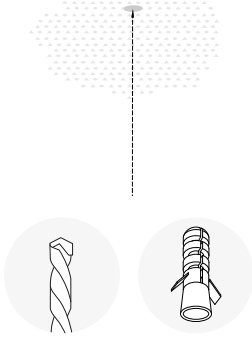

1.3

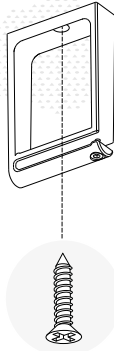

1.4

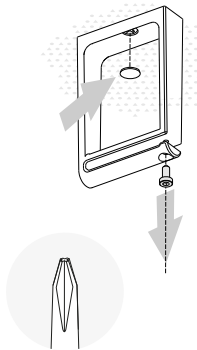

1.5

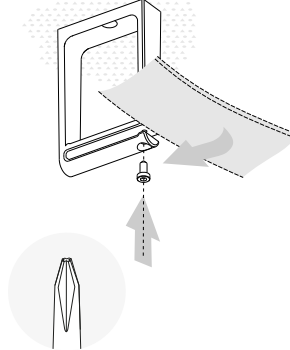

1.6

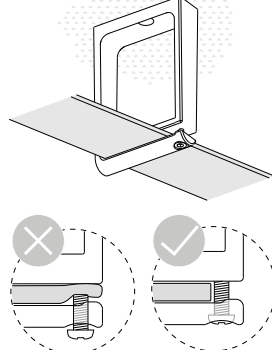

2.1 OPTIONAL

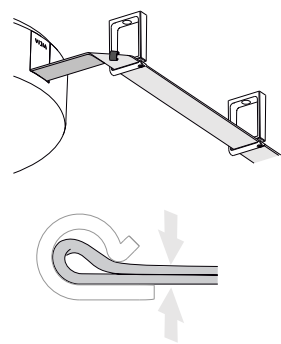

2.2

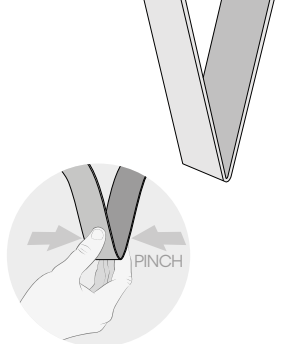

2.3

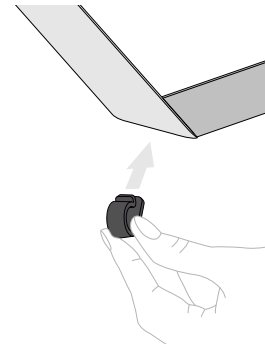

### F4 Counterweight



Watch video

1.1

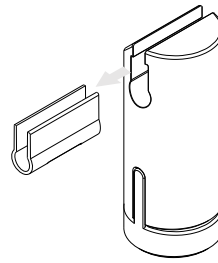

1.2

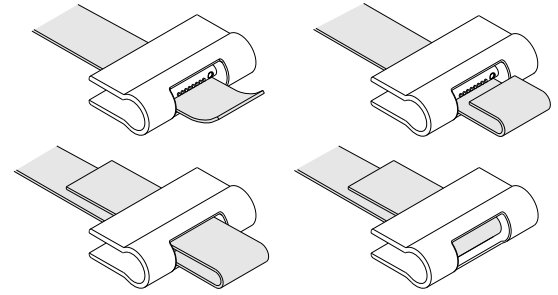

1.3

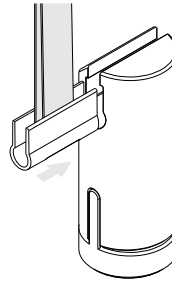

1.4

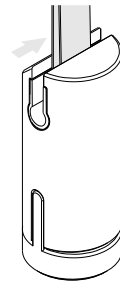

1.5

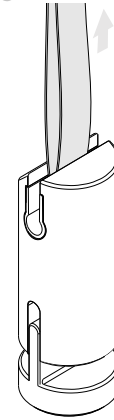

1.6

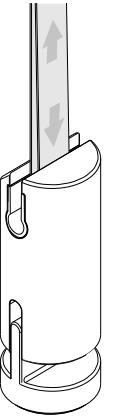

2.1

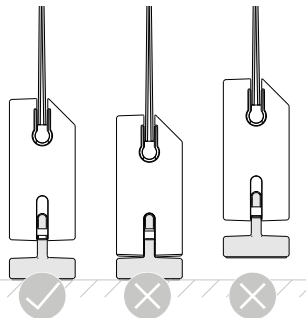

2.2

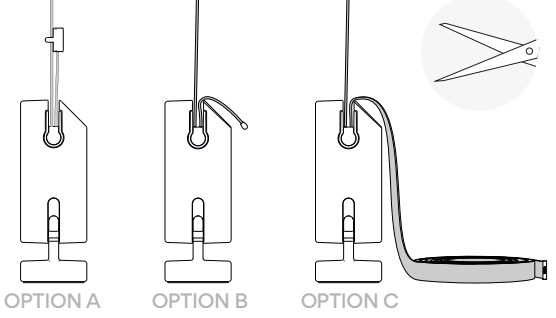

## F5 Corner Support

Watch video



1.1

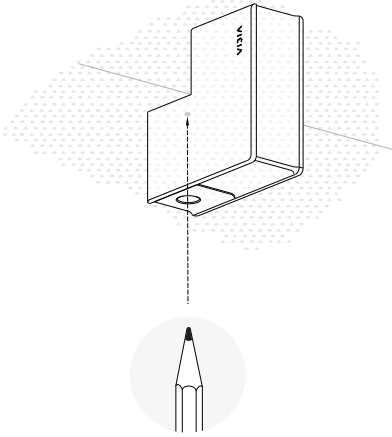

1.2

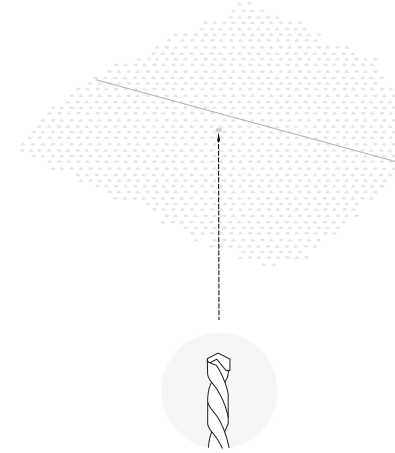

1.3

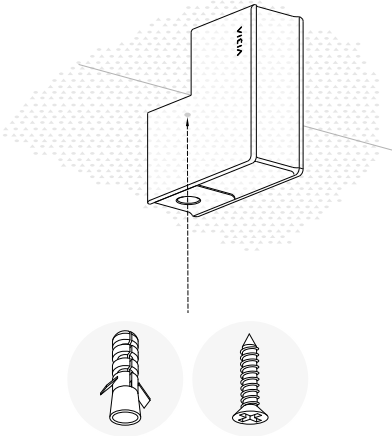

1.4

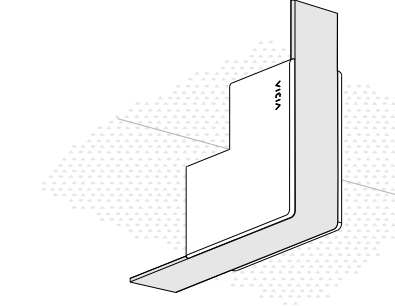

## T1 Suspension Clip

Watch video



1.1

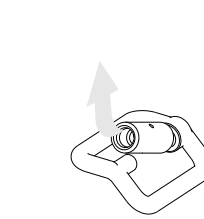

1.2

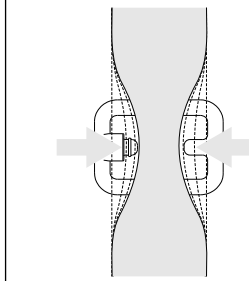

1.3

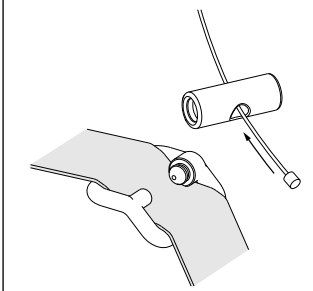

1.4

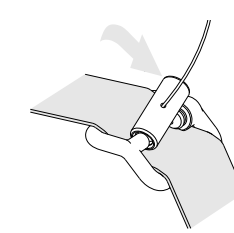

1.5

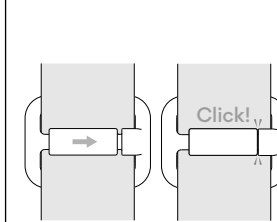

1.6

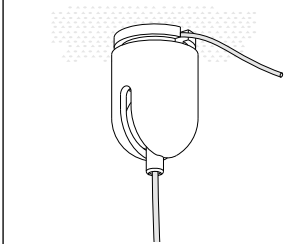

Follow steps on page 23

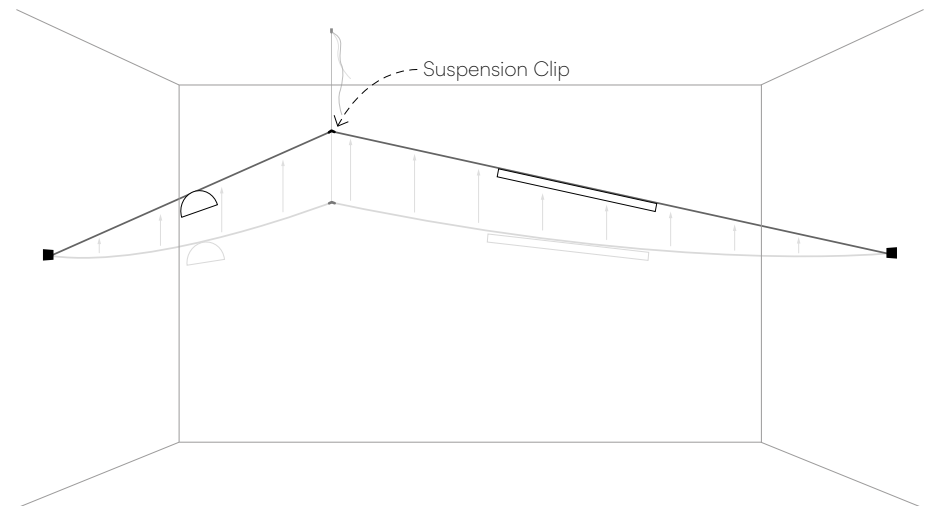

## T2 V Tension Clip

Watch video



<p>1.1</p>	<p>1.2</p>	<p>1.3</p>
<p>1.4</p>	<p>1.5</p>	<p>1.6</p>
<p>1.7</p>	<p>1.8</p> <p>LOCK THE CABLE</p>	<p>1.9</p>
<p>1.10</p>	<p>1.11</p> <p>Click!</p>	<p>1.12</p> <p>+ Follow steps on page 23</p>

## T3 T4 Parallel Tension Clip S & M

Watch video



<p>1.1</p>	<p>1.2</p> <p>Ref: 6220, 6230</p> <p>Ref: 6225, 6235, 6240, 6245</p>	<p>1.3</p>
<p>1.4</p>	<p>1.5</p>	<p>1.6</p>
<p>1.7</p>	<p>1.8</p>	<p>1.9</p>
<p>1.10</p>	<p>1.11</p> <p>Click!</p>	<p>1.12</p>



## T5 Cable End Cap

Watch video

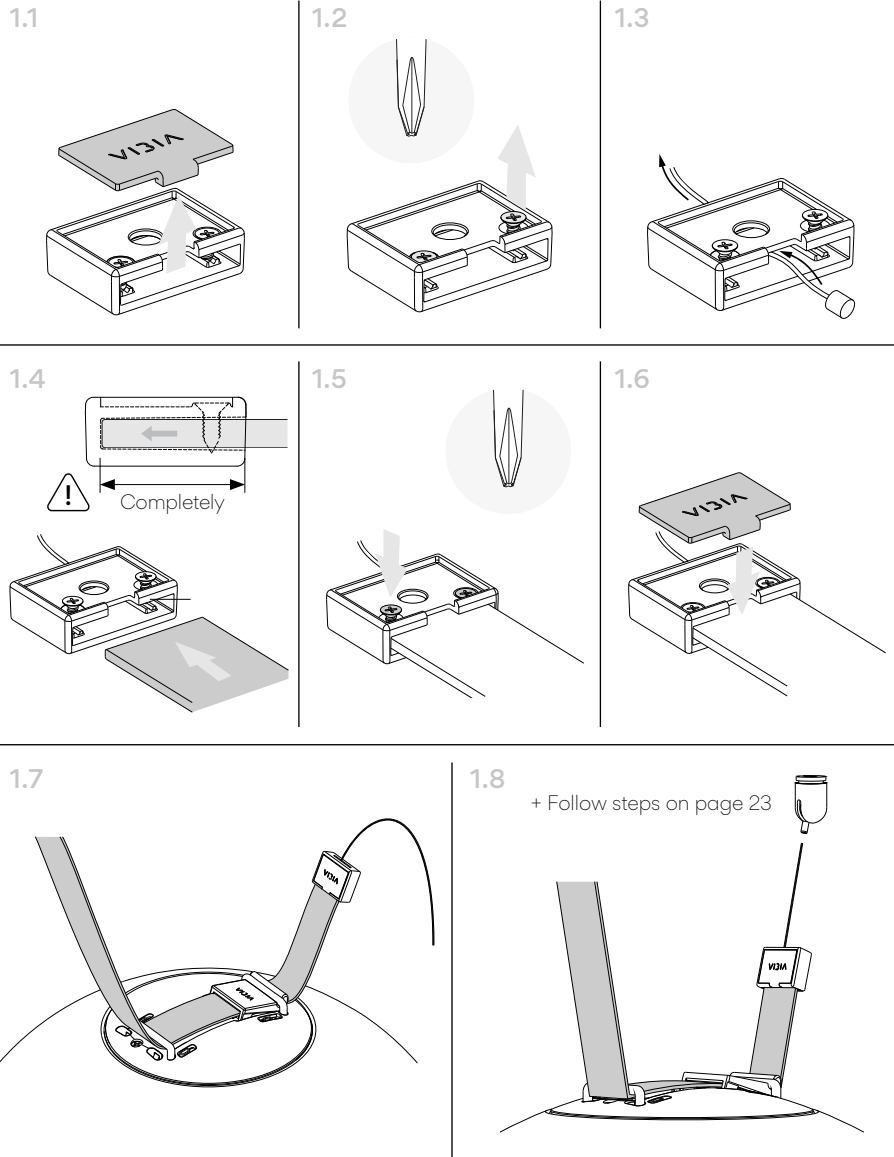

## T6 Pendant Cable S

Watch video

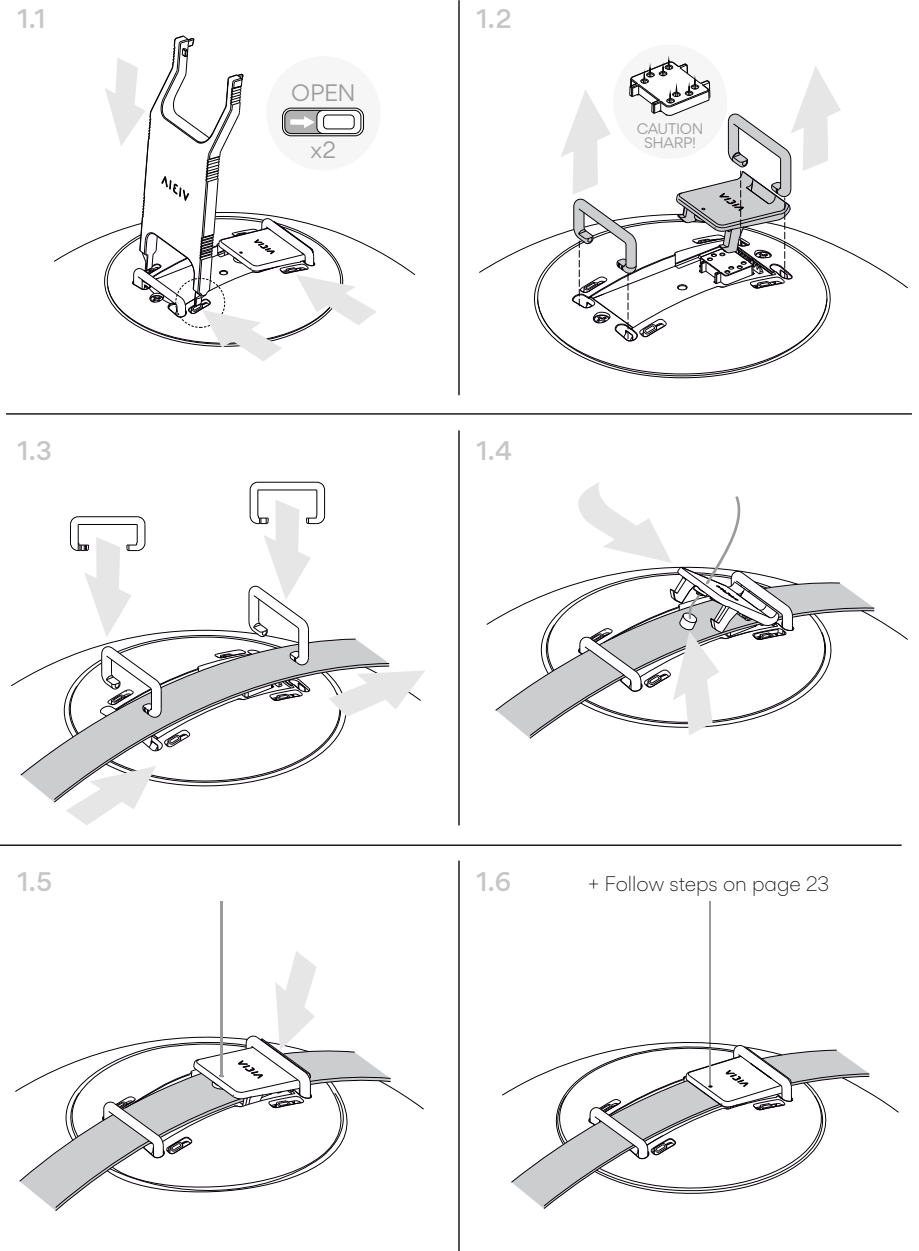

# T7 Pendant Cable M

Watch video

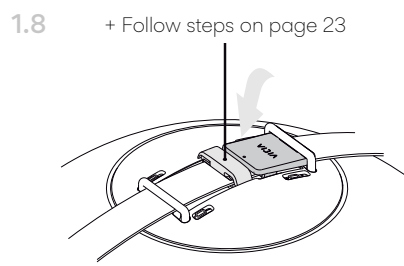
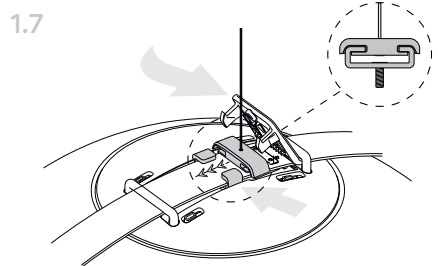
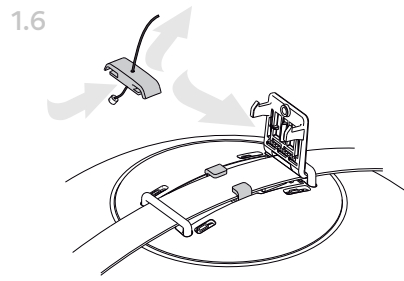
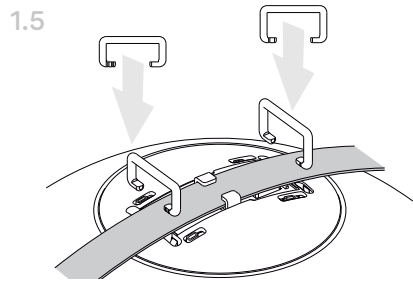
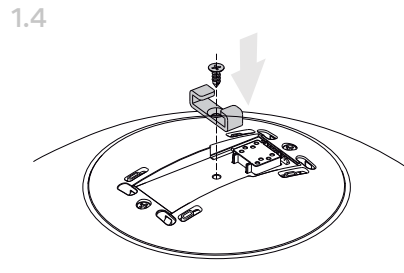
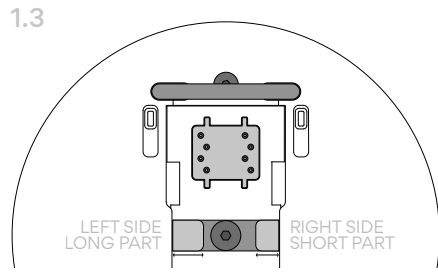
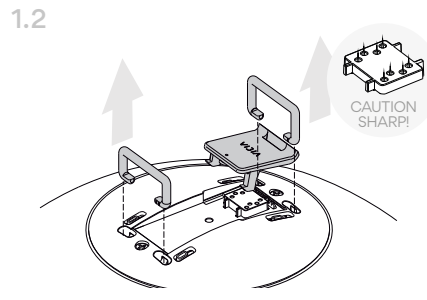
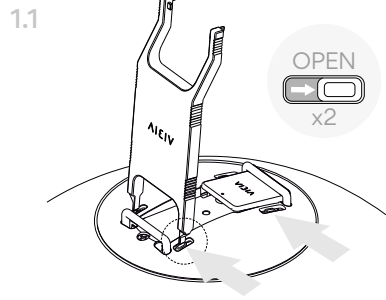

# + Tensor Support

Watch video

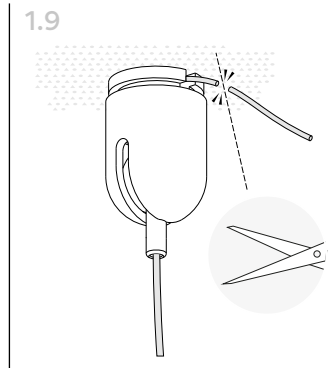
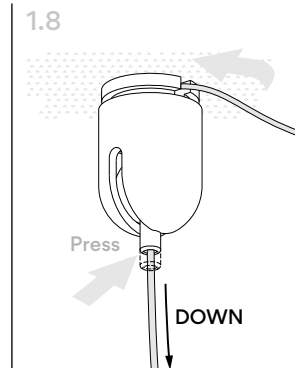
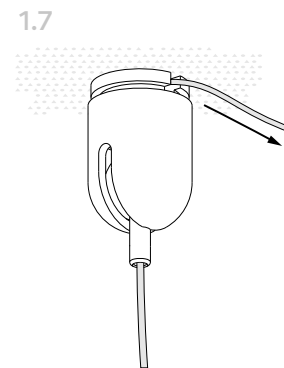
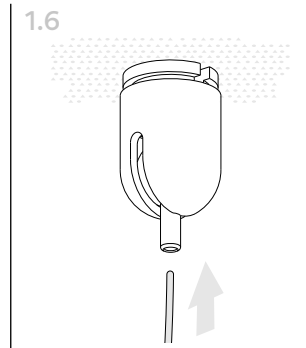
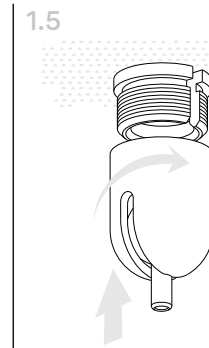
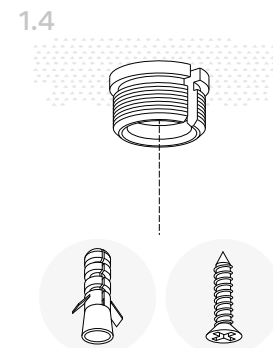
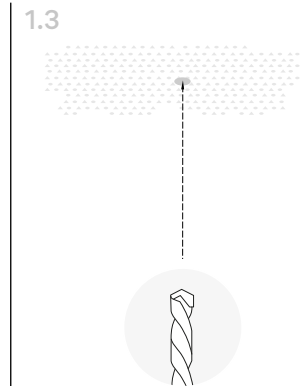
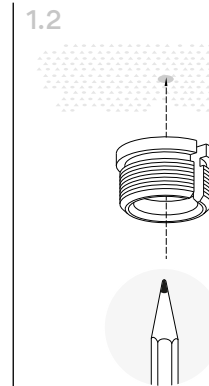
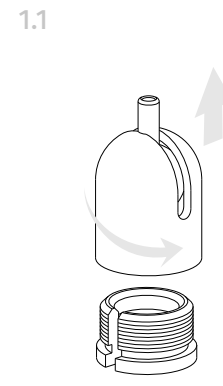

# Electrical Connection Accessories



## Surface

- E1** Surface Canopy S Ø 205 mm  
Page 26
- E2** Surface Canopy M Ø 260 mm  
Page 26

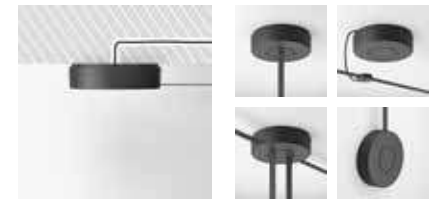

## Built-in

- E3** Built-in Canopy Ø 120 mm  
Page 46



## Remote

- E4** Remote Built-in Canopy Ø 70 mm  
Page 56
- E5** Remote Surface Canopy Ø 60 mm  
Page 62

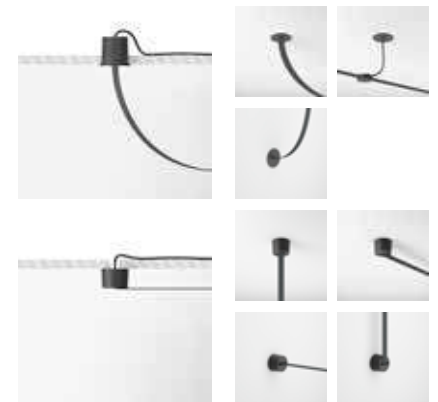

## Plug

- E6** Plug-in Floor Switch Ø 90 mm  
Page 66



## Optional Wire Connection

- E8** Wire Connector Ø 30 mm  
Page 68



# E1 E2 Surface Canopy

Technical specifications / Especificaciones técnicas / Technische Daten  
 Specifiche tecniche / Caractéristiques techniques

<b>ACPM000160</b> E1 - SURFACE CANOPY 25W ON-OFF	0,90 Kg.
<b>ACPM000161</b> E1 - SURFACE CANOPY 40W ON-OFF	0,90 Kg.
<b>ACPM000162</b> E1 - SURFACE CANOPY 60W ON-OFF	0,90 Kg.
<b>ACPM000190</b> E1 - SURFACE CANOPY 25W CASAMBI P2P	0,90 Kg.
<b>ACPM000191</b> E1 - SURFACE CANOPY 40W CASAMBI P2P	0,90 Kg.
<b>ACPM000192</b> E1 - SURFACE CANOPY 60W CASAMBI P2P	0,90 Kg.
<b>ACPM000170</b> E1 - SURFACE CANOPY 25W SIMULTANEOUS LINE DALI	0,90 Kg.
<b>ACPM000171</b> E1 - SURFACE CANOPY 40W SIMULTANEOUS LINE DALI	0,90 Kg.
<b>ACPM000172</b> E1 - SURFACE CANOPY 60W SIMULTANEOUS LINE DALI	0,90 Kg.
<b>ACPM000180</b> E1 - SURFACE CANOPY 25W SIMULTANEOUS LINE CASAMBI	0,90 Kg.
<b>ACPM000181</b> E1 - SURFACE CANOPY 40W SIMULTANEOUS LINE CASAMBI	0,90 Kg.
<b>ACPM000182</b> E1 - SURFACE CANOPY 60W SIMULTANEOUS LINE CASAMBI	0,90 Kg.
<b>ACPM000200</b> E1 - SURFACE CANOPY 25W SIMULTANEOUS LINE 1-10V	0,90 Kg.
<b>ACPM000201</b> E1 - SURFACE CANOPY 40W SIMULTANEOUS LINE 1-10V	0,90 Kg.
<b>ACPM000202</b> E1 - SURFACE CANOPY 60W SIMULTANEOUS LINE 1-10V	0,90 Kg.
<b>ACPM000350</b> E1 - SURFACE CANOPY 25W SIMULTANEOUS LINE PUSH	0,90 Kg.
<b>ACPM000351</b> E1 - SURFACE CANOPY 40W SIMULTANEOUS LINE PUSH	0,90 Kg.
<b>ACPM000352</b> E1 - SURFACE CANOPY 60W SIMULTANEOUS LINE PUSH	0,90 Kg.

<b>ACPM000163</b> E2 - SURFACE CANOPY 120W ON-OFF	1,60 Kg.
<b>ACPM000164</b> E2 - SURFACE CANOPY 240W ON-OFF	1,80 Kg.
<b>ACPM000193</b> E2 - SURFACE CANOPY 120W CASAMBI P2P	1,60 Kg.
<b>ACPM000194</b> E2 - SURFACE CANOPY 240W CASAMBI P2P	1,80 Kg.
<b>ACPM000173</b> E2 - SURFACE CANOPY 120W SIMULTANEOUS LINE DALI	1,60 Kg.
<b>ACPM000174</b> E2 - SURFACE CANOPY 240W SIMULTANEOUS LINE DALI	1,80 Kg.
<b>ACPM000183</b> E2 - SURFACE CANOPY 120W SIMULTANEOUS LINE CASAMBI	1,60 Kg.
<b>ACPM000184</b> E2 - SURFACE CANOPY 240W SIMULTANEOUS LINE CASAMBI	1,80 Kg.
<b>ACPM000203</b> E2 - SURFACE CANOPY 120W SIMULTANEOUS LINE 1-10V	1,60 Kg.
<b>ACPM000204</b> E2 - SURFACE CANOPY 240W SIMULTANEOUS LINE 1-10V	1,80 Kg.
<b>ACPM000353</b> E2 - SURFACE CANOPY 120W SIMULTANEOUS LINE PUSH	1,60 Kg.
<b>ACPM000354</b> E2 - SURFACE CANOPY 240W SIMULTANEOUS LINE PUSH	1,80 Kg.

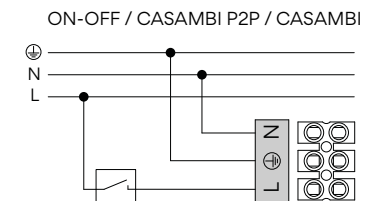
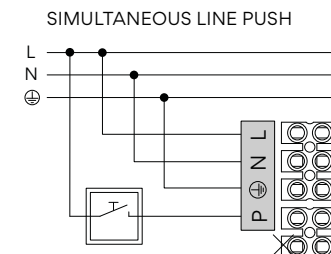
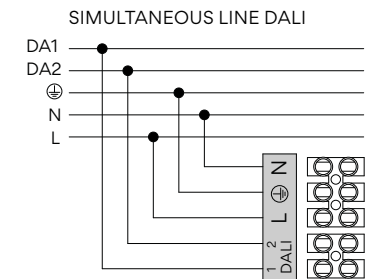
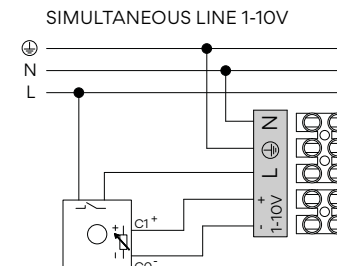

## Electrical Connection Point



### FIRST STEP

Check your creation manual to identify the location of the surface canopy in space.

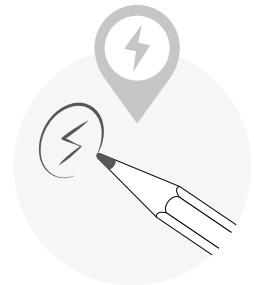

### SECOND STEP

Mark the location of the surface canopy in space so that you can trace the composition with the paper belt.

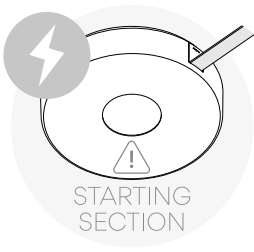

### THIRD STEP

Commence the installation of the lighting composition from the electrical connection.

STARTING SECTION

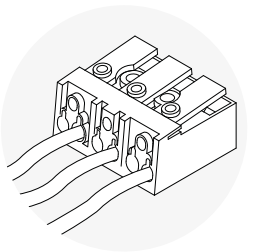

### LAST STEP

When having installed the surface canopy, make the wiring connection according to your dimming regulation.

## Belt Options Surface Canopy

### LATERAL



E1  
E2

Ceiling / Wall  
Page 30

### PARALLEL



E1

Ceiling  
Page 38

### LATERAL + LATERAL



E1  
E2

Ceiling / Wall  
Page 32

### PARALLEL



E2

Ceiling  
Page 40

### CENTER



E1  
E2

Ceiling  
Page 34

### LATERAL + PARALLEL + LATERAL



E1  
E2

Ceiling  
Page 42

### LATERAL + CENTER



E1  
E2

Ceiling  
Page 36

### LATERAL + PARALLEL



E1  
E2

Ceiling  
Page 44





STEPS: LATERAL

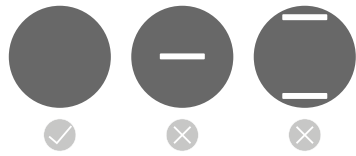

Watch video

E1 E2

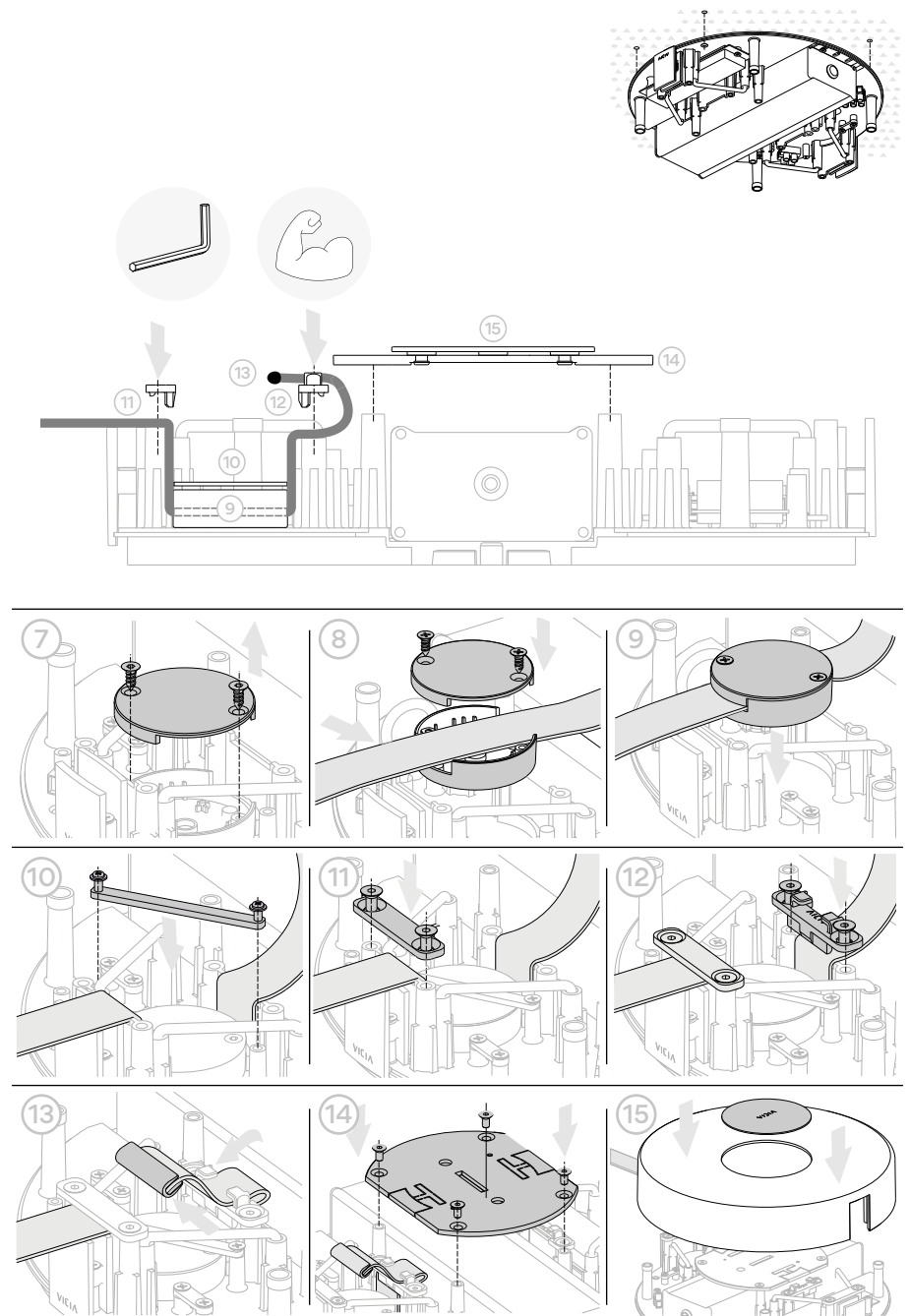
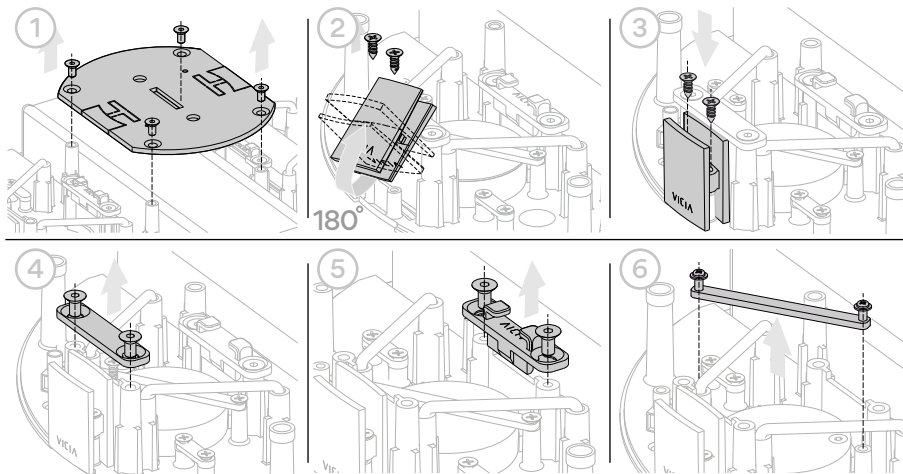
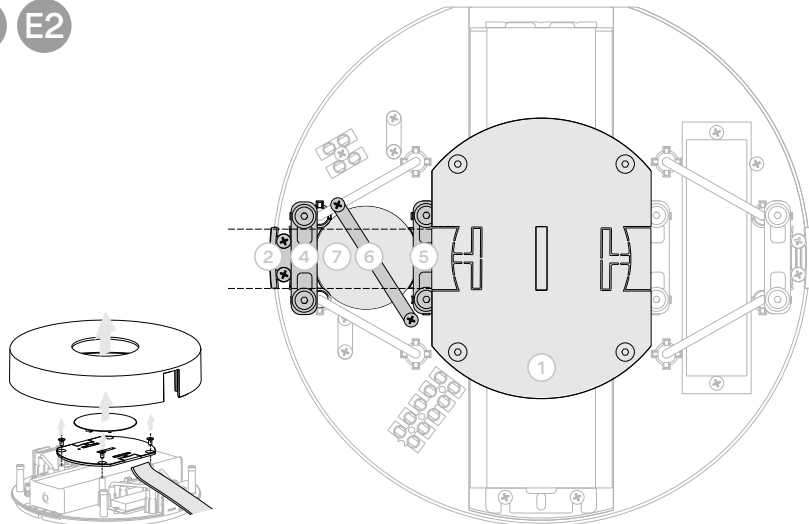





STEPS: **LATERAL + LATERAL**

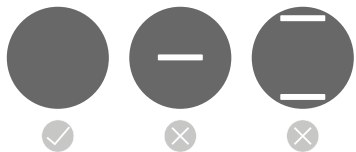

Watch video

E1 E2

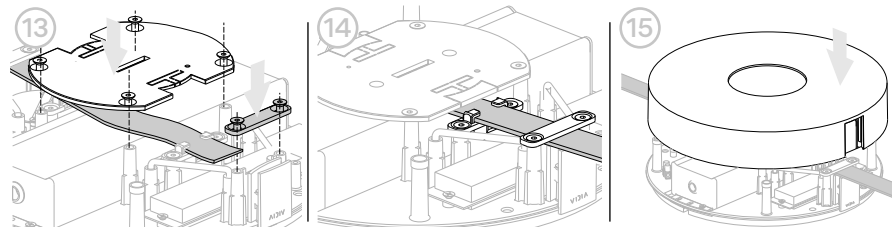
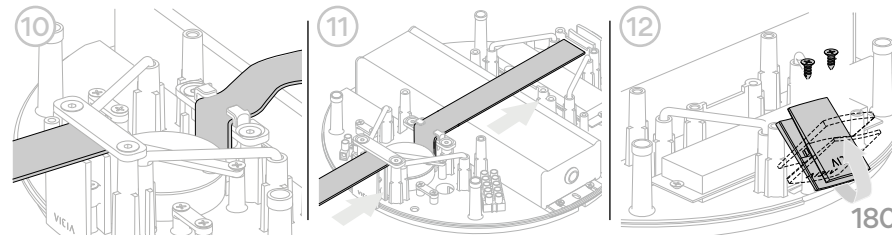
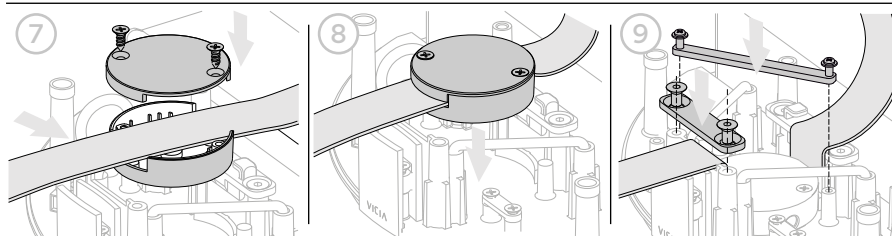
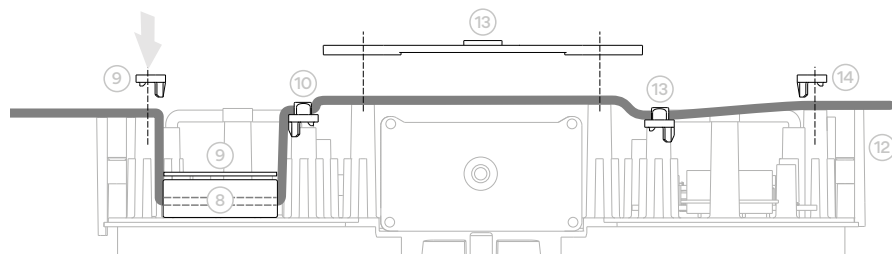
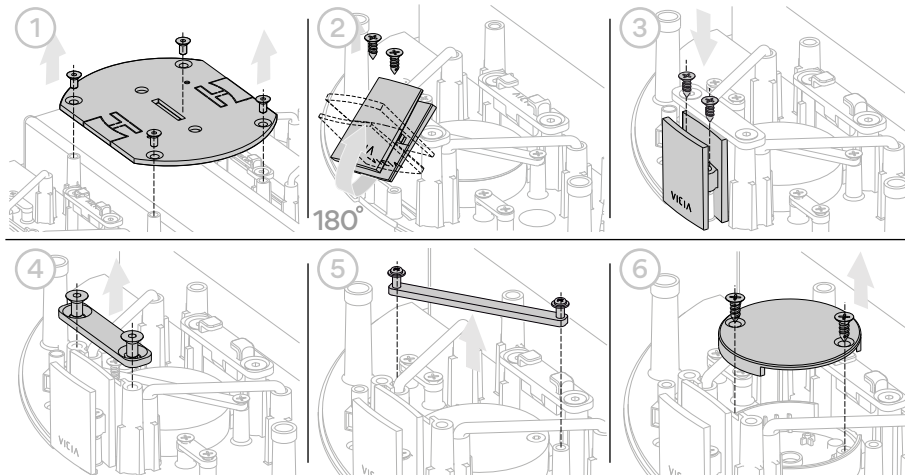
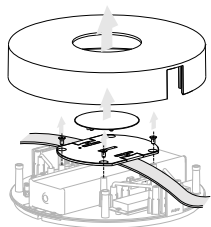
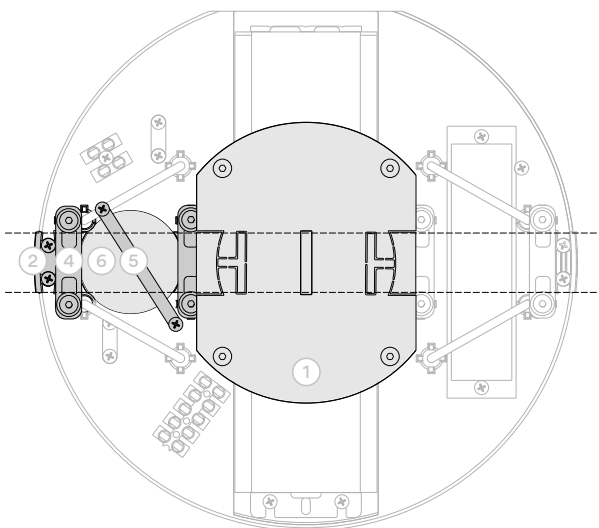



STEPS: CENTER

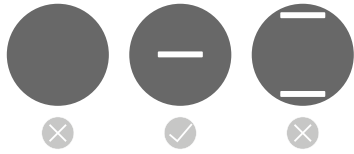

Watch video

E1 E2

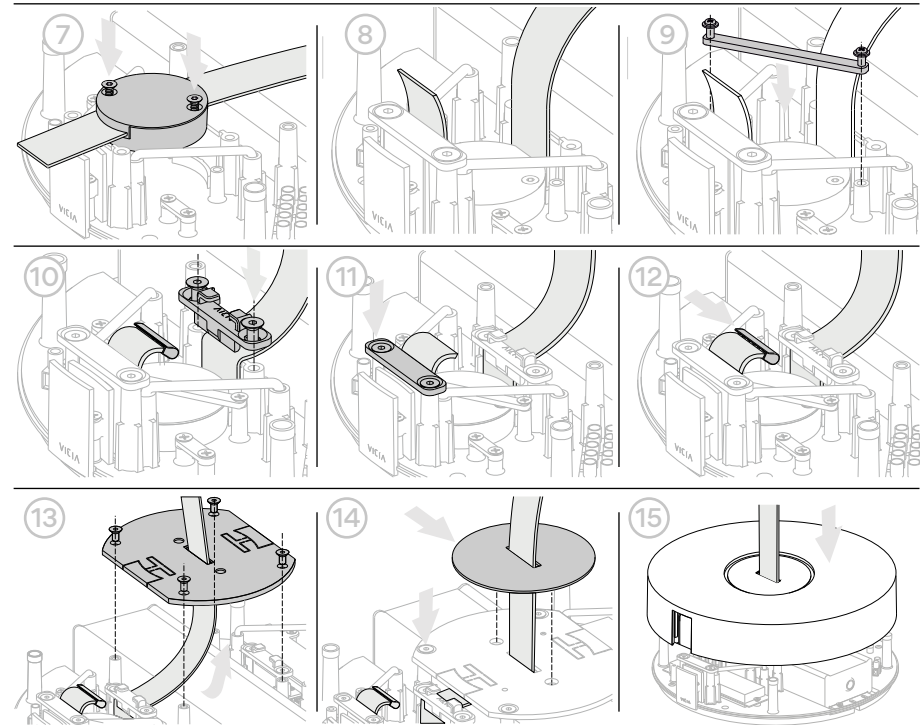
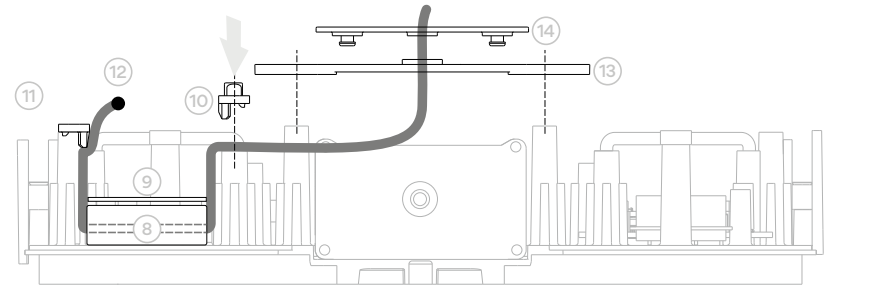
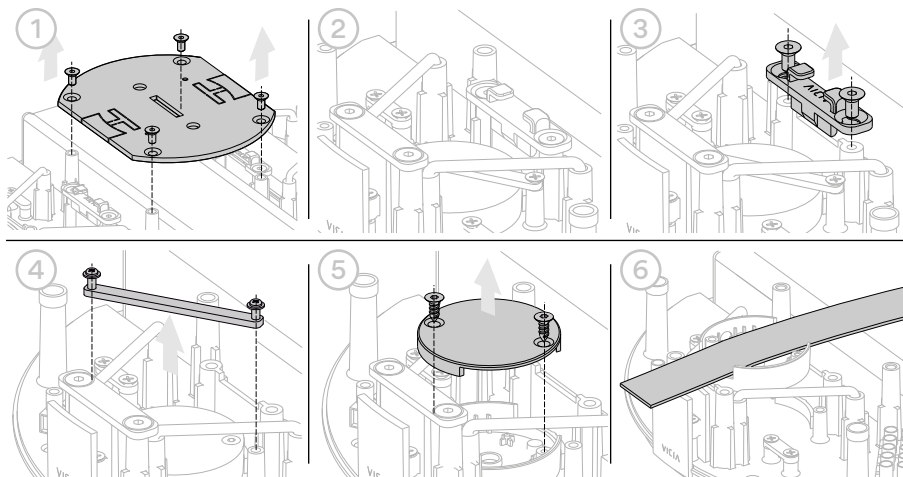
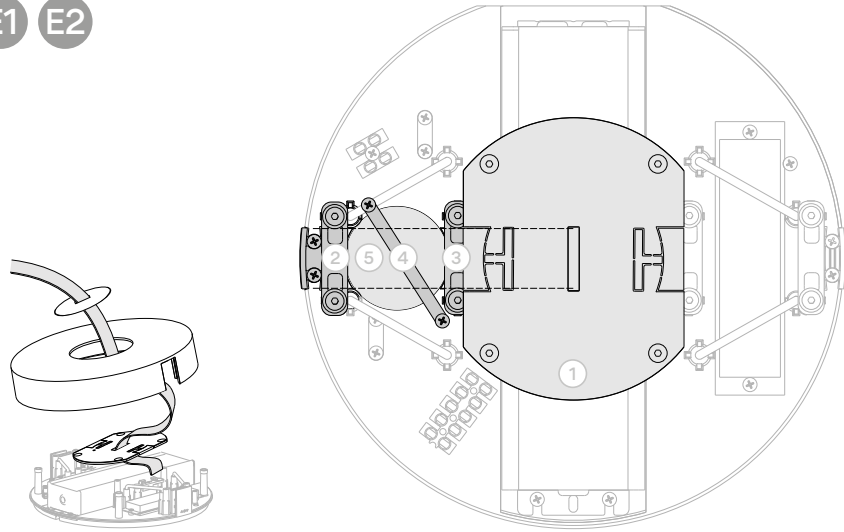



STEPS: **LATERAL + CENTER**

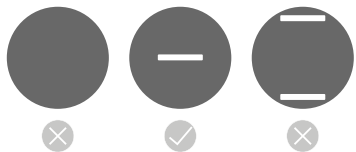

Watch video

E1 E2

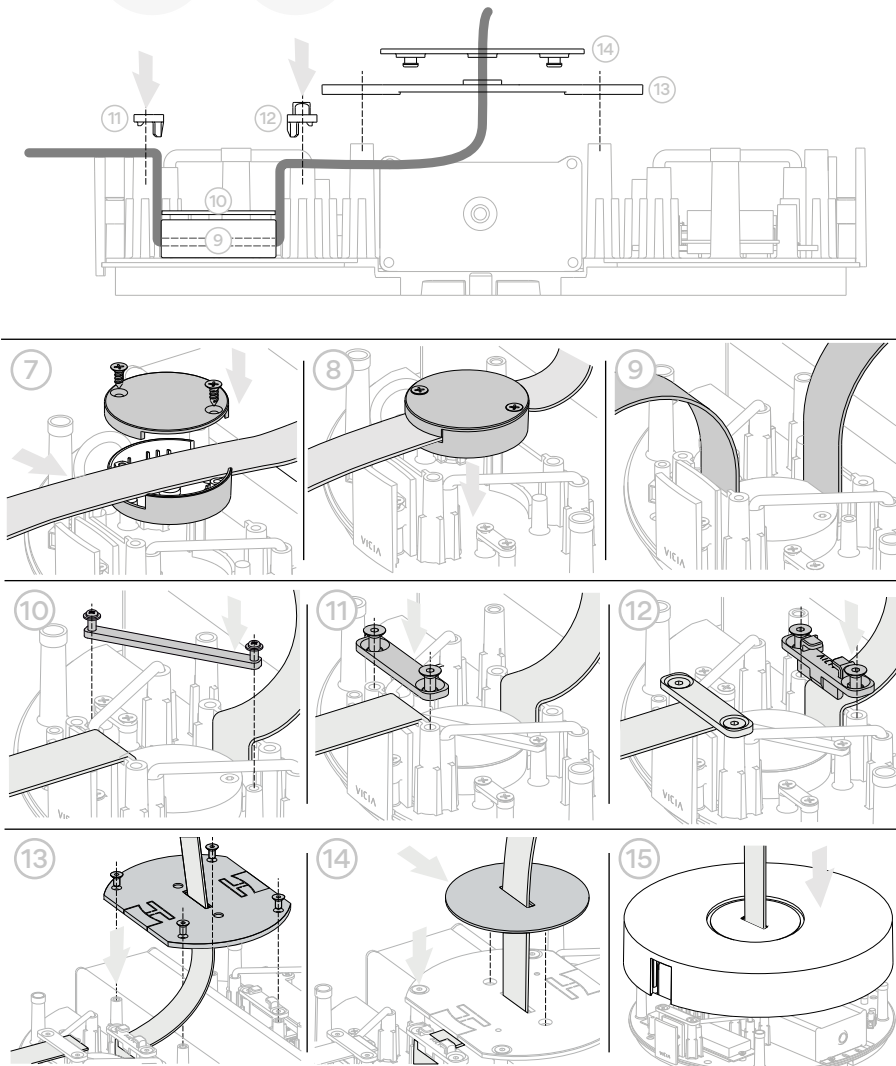
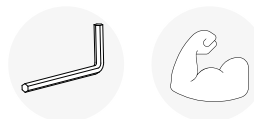
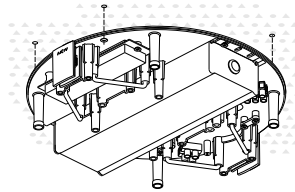
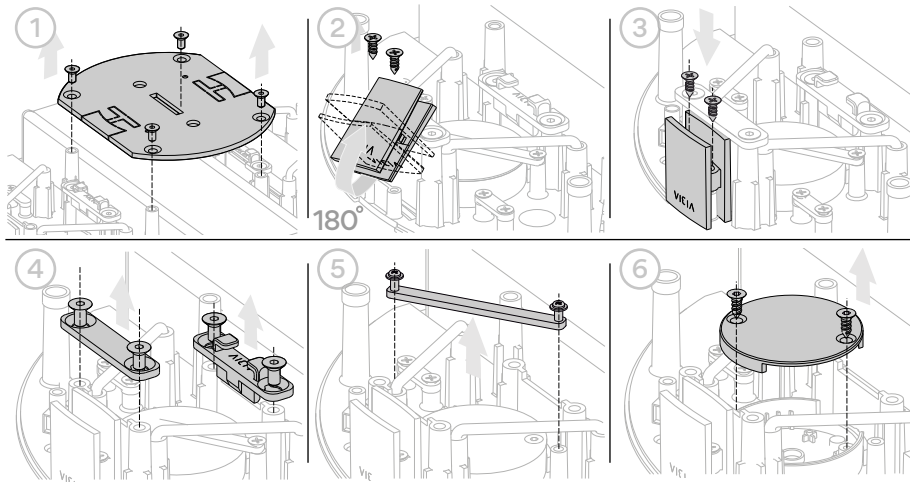
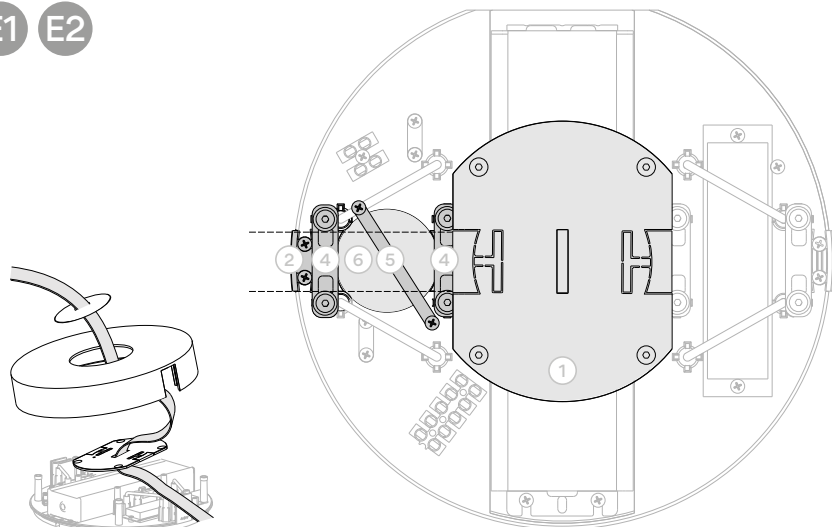



STEPS: **PARALLEL**

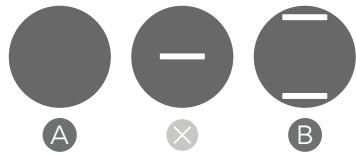

Watch video

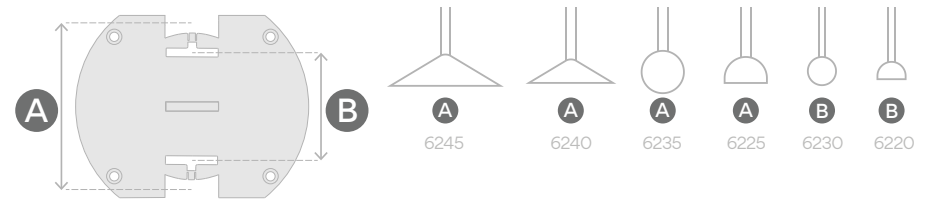

**E1** Surface Canopy S Ø 205 mm

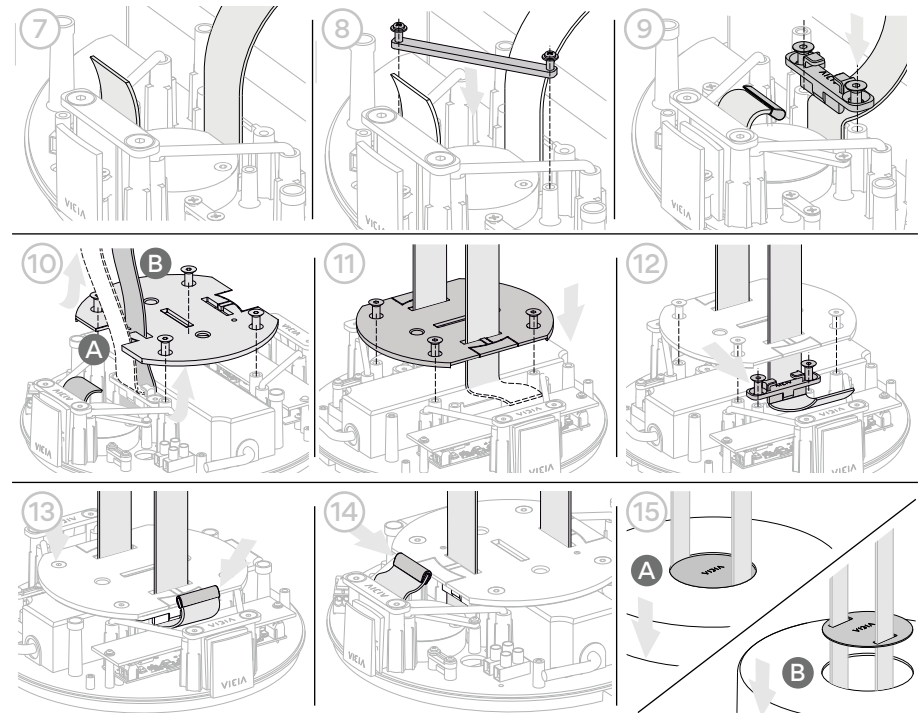
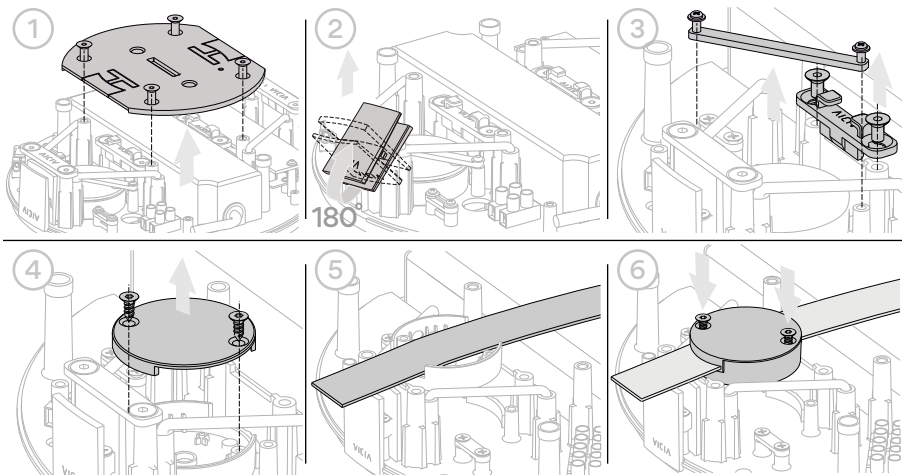
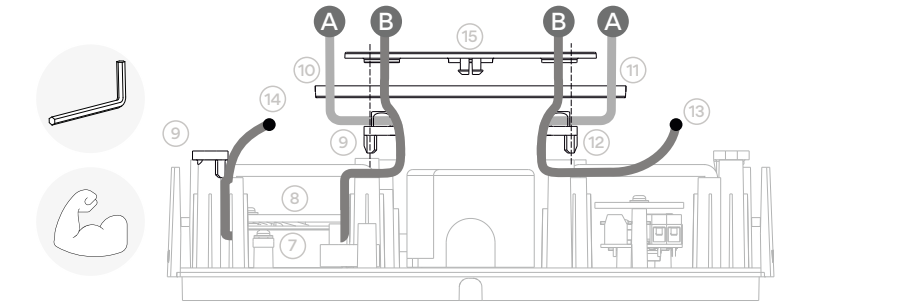
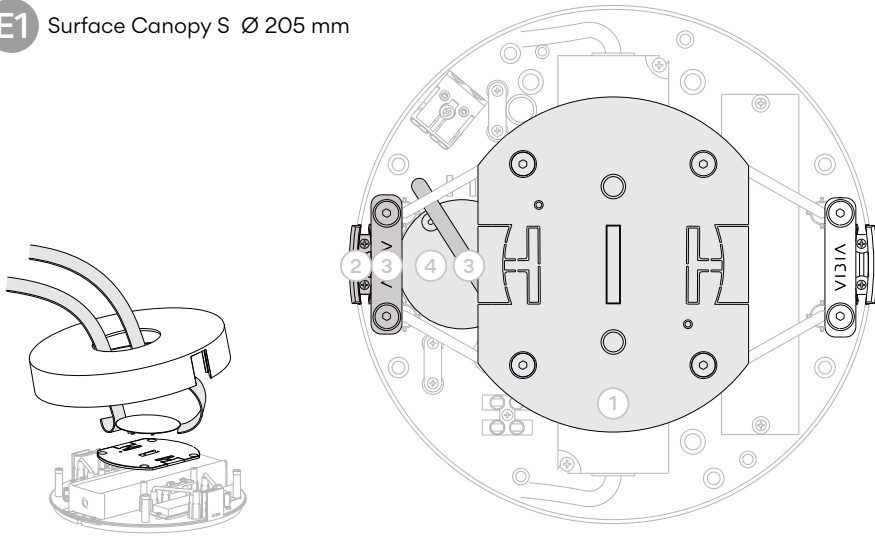





STEPS: **PARALLEL**

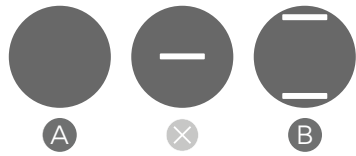

Watch video

**E2** Surface Canopy M Ø 260 mm

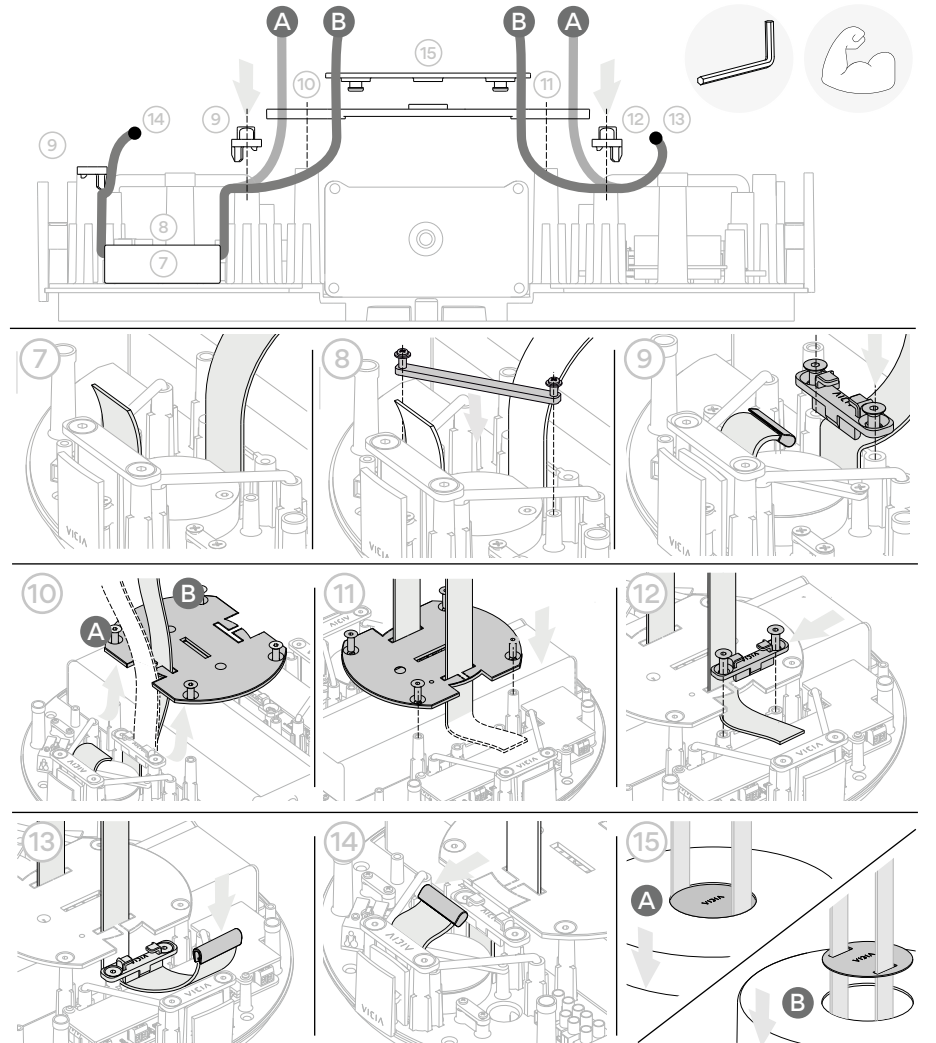
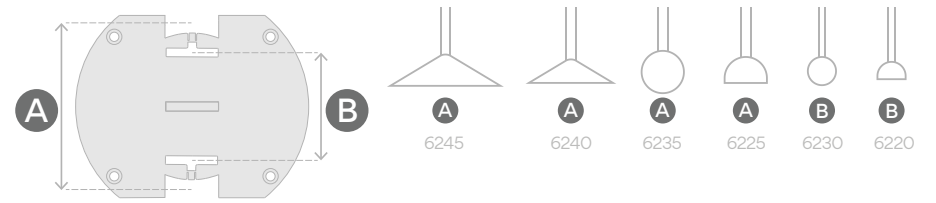
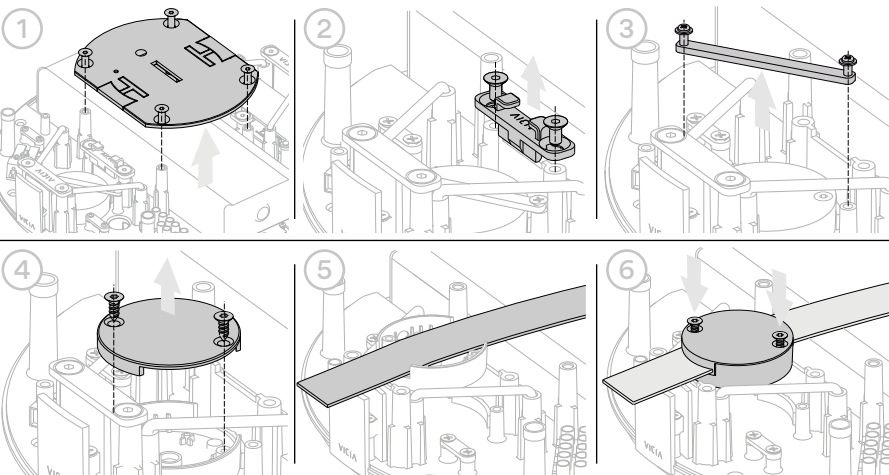
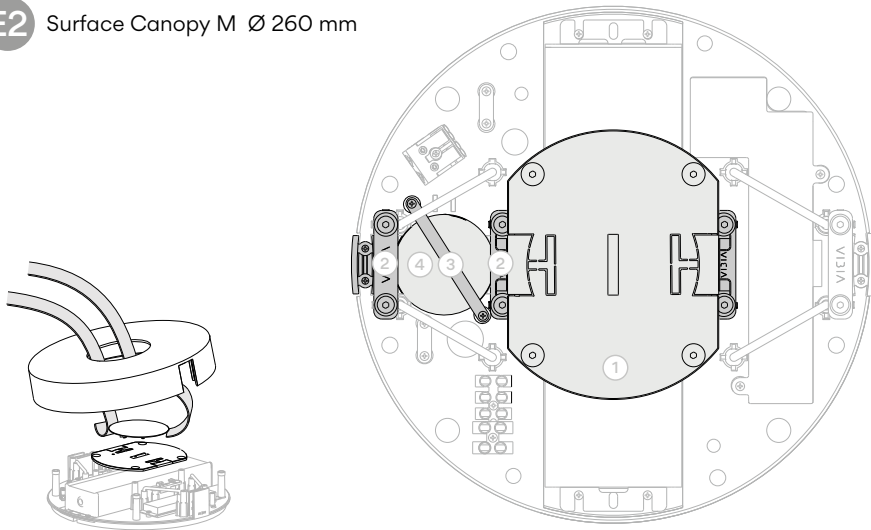

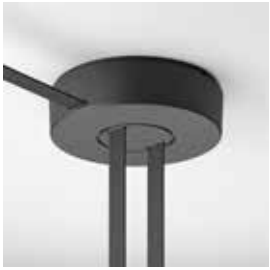

STEPS: LATERAL + PARALLEL

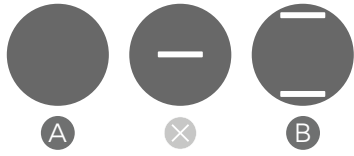

Watch video

E1 E2

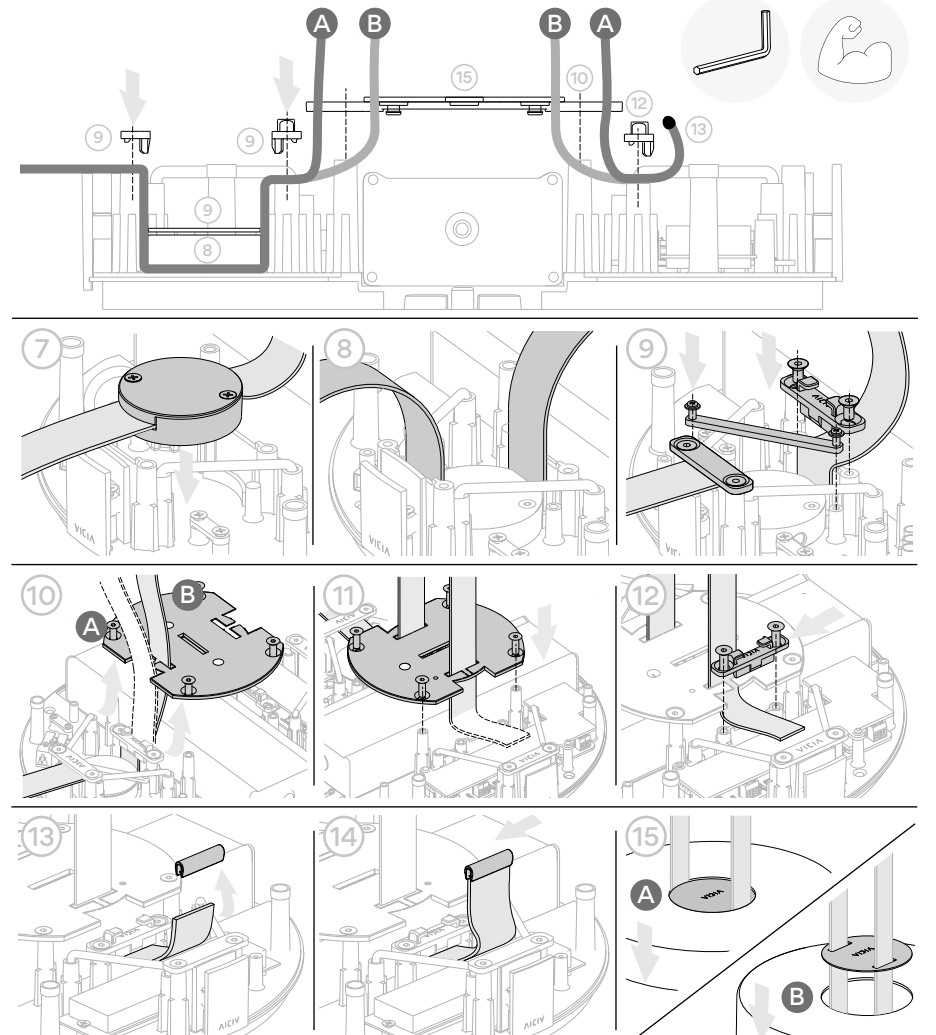
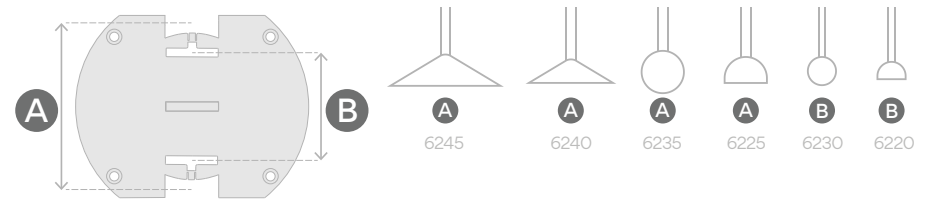
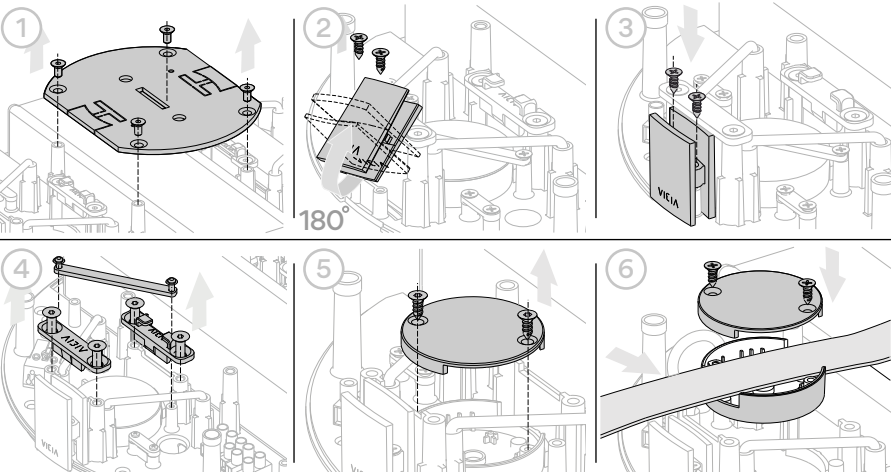
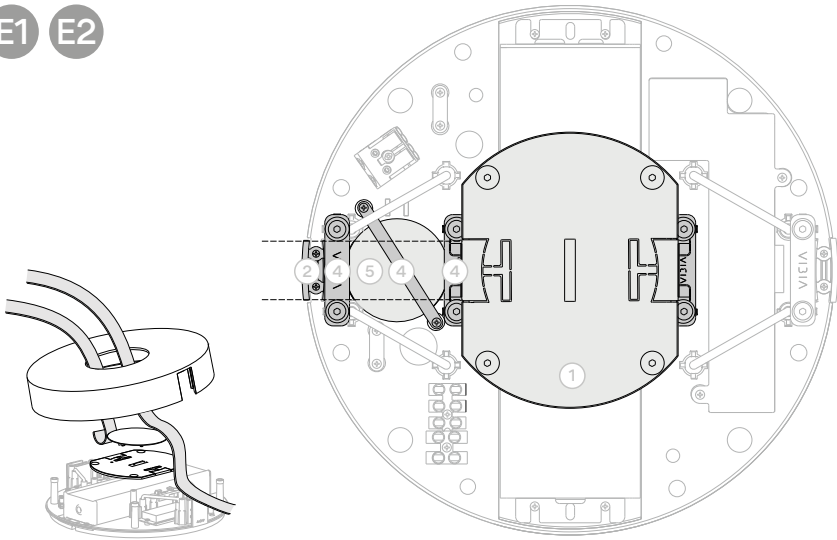





STEPS:  
LATERAL + PARALLEL + LATERAL

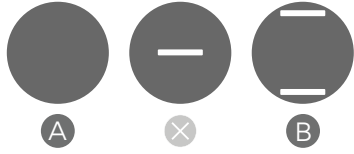

Watch video



E1 E2

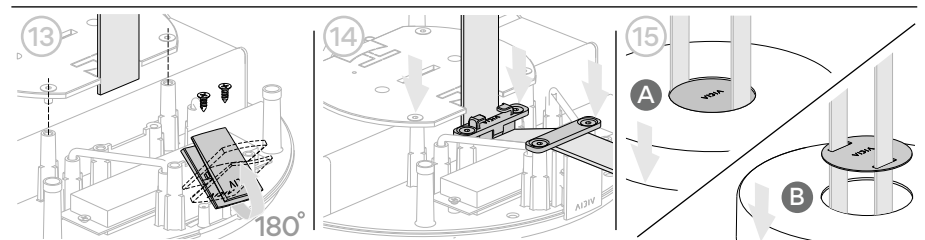
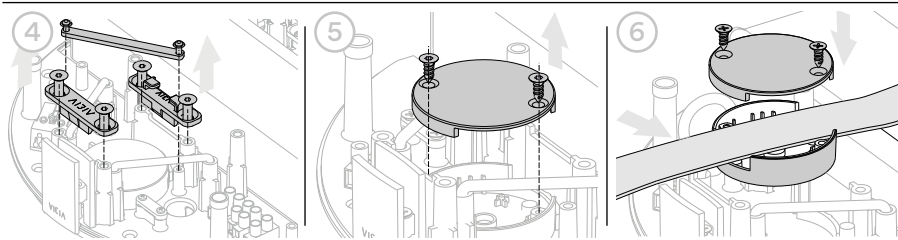
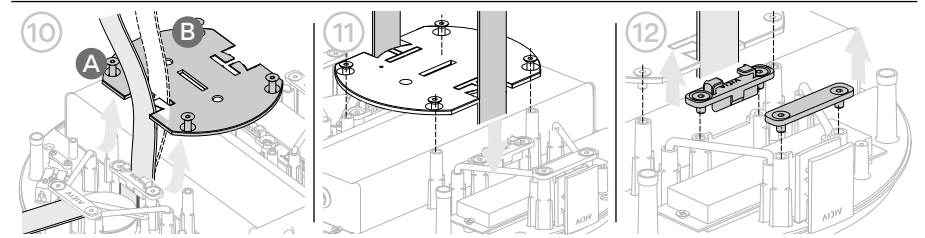
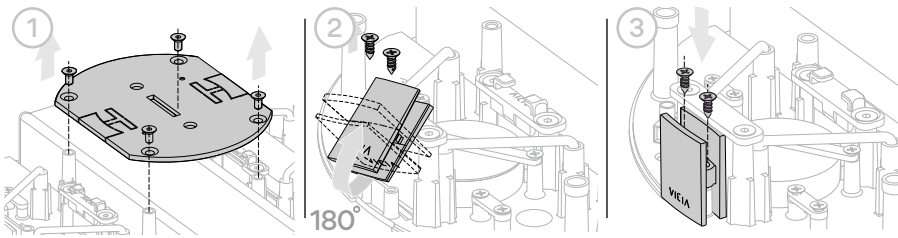
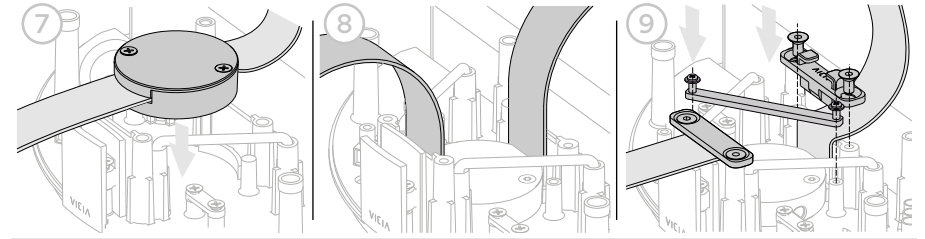
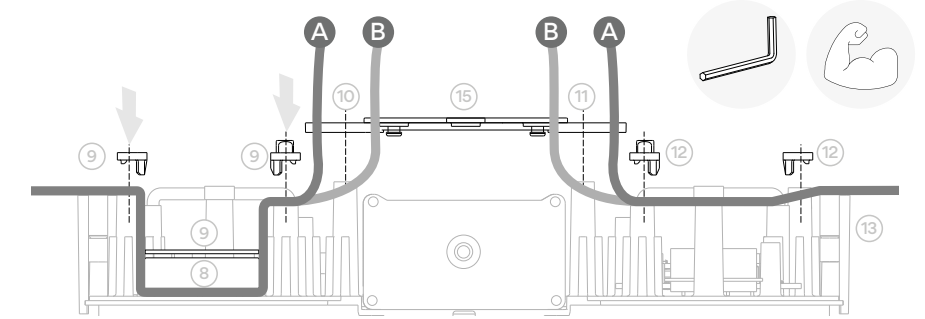
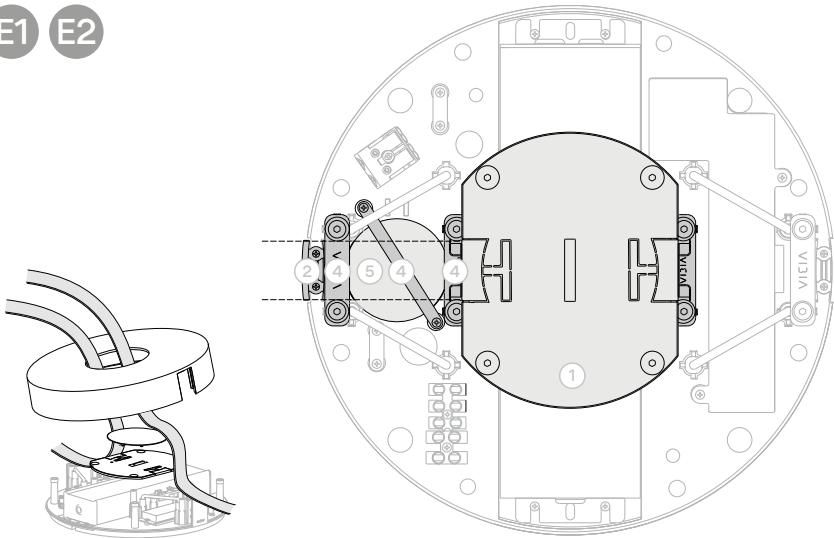

## E3 Built-in Canopy

Watch video



Technical specifications / Especificaciones técnicas / Technische Daten  
Specifiche tecniche / Caractéristiques techniques

<b>ACPM000243</b> BUILT IN CANOPY 25W ON-OFF	0,65 Kg.	CE IP20 90-305V Multi-volt
<b>ACPM000244</b> BUILT IN CANOPY 40W ON-OFF	0,65 Kg.	CE IP20 90-305V Multi-volt
<b>ACPM000245</b> BUILT IN CANOPY 60W ON-OFF	0,65 Kg.	CE IP20 90-305V Multi-volt
<b>ACPM000246</b> BUILT IN CANOPY 120W ON-OFF	1,25 Kg.	CE IP20 90-305V Multi-volt
<b>ACPM000247</b> BUILT IN CANOPY 240W ON-OFF	1,45 Kg.	CE IP20 90-305V Multi-volt
<b>ACPM000263</b> BUILT IN CANOPY 25W CASAMBI P2P	0,65 Kg.	CE IP20 90-305V Multi-volt
<b>ACPM000264</b> BUILT IN CANOPY 40W CASAMBI P2P	0,65 Kg.	CE IP20 90-305V Multi-volt
<b>ACPM000265</b> BUILT IN CANOPY 60W CASAMBI P2P	0,65 Kg.	CE IP20 90-305V Multi-volt
<b>ACPM000266</b> BUILT IN CANOPY 120W CASAMBI P2P	1,25 Kg.	CE IP20 90-305V Multi-volt
<b>ACPM000267</b> BUILT IN CANOPY 240W CASAMBI P2P	1,45 Kg.	CE IP20 90-305V Multi-volt
<b>ACPM000248</b> BUILT IN CANOPY 25W SIMULTANEOUS LINE DALI	1,10 Kg.	CE IP20 Dimmer 90-305V Multi-volt
<b>ACPM000249</b> BUILT IN CANOPY 40W SIMULTANEOUS LINE DALI	1,10 Kg.	CE IP20 Dimmer 90-305V Multi-volt
<b>ACPM000250</b> BUILT IN CANOPY 60W SIMULTANEOUS LINE DALI	1,10 Kg.	CE IP20 Dimmer 90-305V Multi-volt
<b>ACPM000251</b> BUILT IN CANOPY 120W SIMULTANEOUS LINE DALI	1,70 Kg.	CE IP20 Dimmer 90-305V Multi-volt
<b>ACPM000252</b> BUILT IN CANOPY 240W SIMULTANEOUS LINE DALI	1,90 Kg.	CE IP20 Dimmer 90-305V Multi-volt
<b>ACPM000253</b> BUILT IN CANOPY 25W SIMULTANEOUS LINE 1-10V	1,10 Kg.	CE IP20 Dimmer 90-305V Multi-volt
<b>ACPM000254</b> BUILT IN CANOPY 40W SIMULTANEOUS LINE 1-10V	1,10 Kg.	CE IP20 Dimmer 90-305V Multi-volt
<b>ACPM000255</b> BUILT IN CANOPY 60W SIMULTANEOUS LINE 1-10V	1,10 Kg.	CE IP20 Dimmer 90-305V Multi-volt
<b>ACPM000256</b> BUILT IN CANOPY 120W SIMULTANEOUS LINE 1-10V	1,70 Kg.	CE IP20 Dimmer 90-305V Multi-volt
<b>ACPM000257</b> BUILT IN CANOPY 240W SIMULTANEOUS LINE 1-10V	1,90 Kg.	CE IP20 Dimmer 90-305V Multi-volt

<b>ACPM000258</b> BUILT IN CANOPY 25W SIMULTANEOUS LINE CASAMBI	1,10 Kg.	CE IP20 Dimmer 90-305V Multi-volt
<b>ACPM000259</b> BUILT IN CANOPY 40W SIMULTANEOUS LINE CASAMBI	1,10 Kg.	CE IP20 Dimmer 90-305V Multi-volt
<b>ACPM000260</b> BUILT IN CANOPY 60W SIMULTANEOUS LINE CASAMBI	1,10 Kg.	CE IP20 Dimmer 90-305V Multi-volt
<b>ACPM000261</b> BUILT IN CANOPY 120W SIMULTANEOUS LINE CASAMBI	1,70 Kg.	CE IP20 Dimmer 90-305V Multi-volt
<b>ACPM000262</b> BUILT IN CANOPY 240W SIMULTANEOUS LINE CASAMBI	1,90 Kg.	CE IP20 Dimmer 90-305V Multi-volt
<b>ACPM000355</b> BUILT IN CANOPY 25W SIMULTANEOUS LINE PUSH	1,10 Kg.	CE IP20 Dimmer 90-305V Multi-volt
<b>ACPM000356</b> BUILT IN CANOPY 40W SIMULTANEOUS LINE PUSH	1,10 Kg.	CE IP20 Dimmer 90-305V Multi-volt
<b>ACPM000357</b> BUILT IN CANOPY 60W SIMULTANEOUS LINE PUSH	1,10 Kg.	CE IP20 Dimmer 90-305V Multi-volt
<b>ACPM000358</b> BUILT IN CANOPY 120W SIMULTANEOUS LINE PUSH	1,70 Kg.	CE IP20 Dimmer 90-305V Multi-volt
<b>ACPM000359</b> BUILT IN CANOPY 240W SIMULTANEOUS LINE PUSH	1,90 Kg.	CE IP20 Dimmer 90-305V Multi-volt

SIMULTANEOUS LINE 1-10V

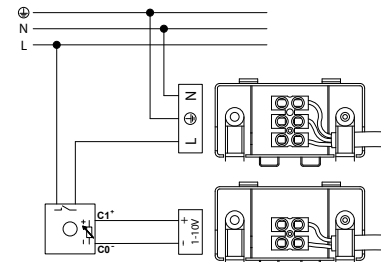

SIMULTANEOUS LINE DALI

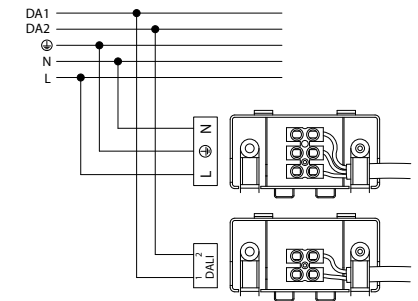

SIMULTANEOUS LINE PUSH

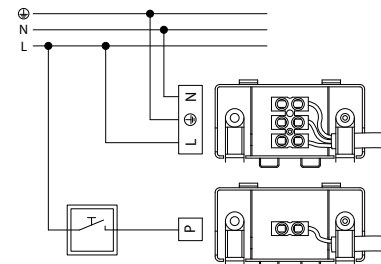

ON-OFF / CASAMBI P2P / CASAMBI

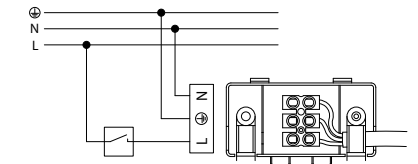

1.1

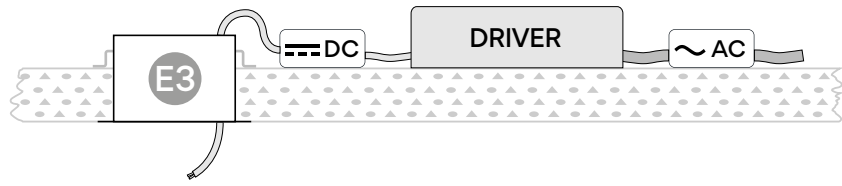

1.2

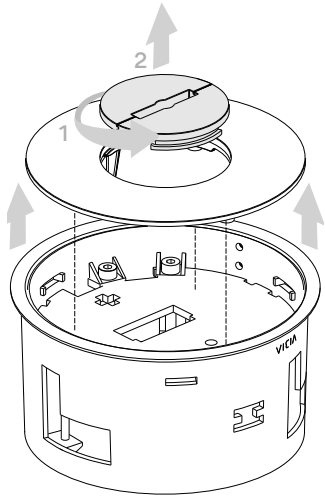

1.3

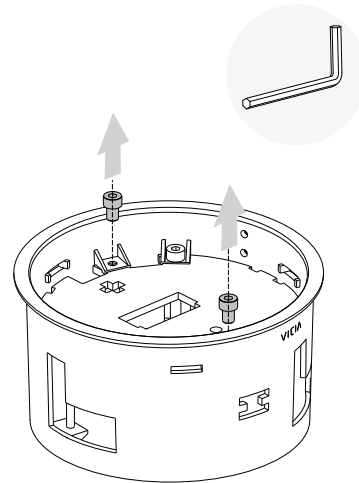

1.4

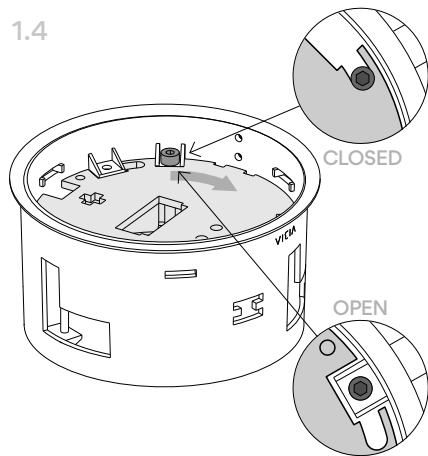

1.5

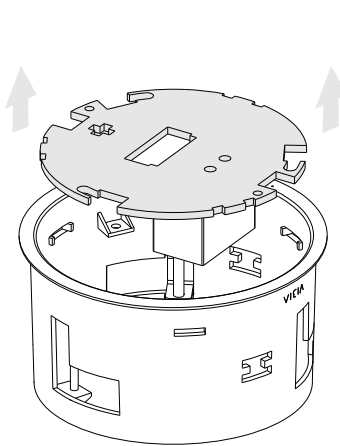

2.1

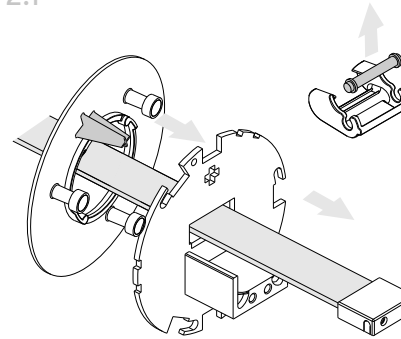

2.2

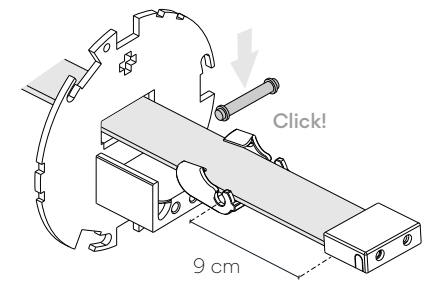

2.3

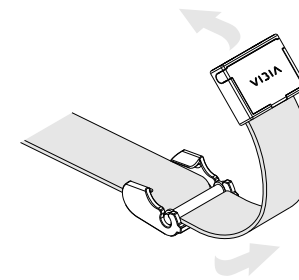

2.4

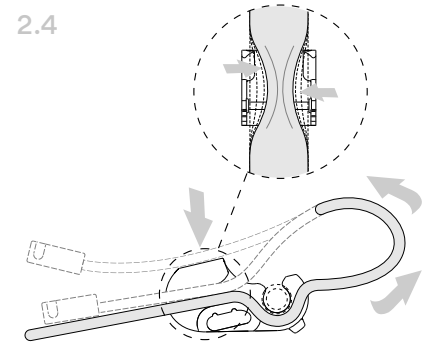

2.5

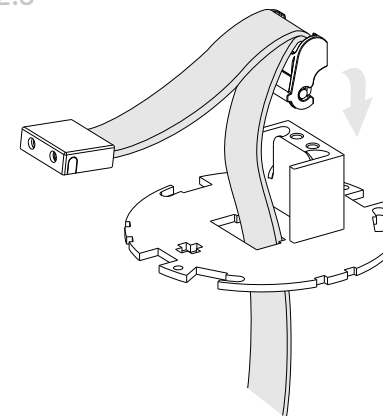

2.6

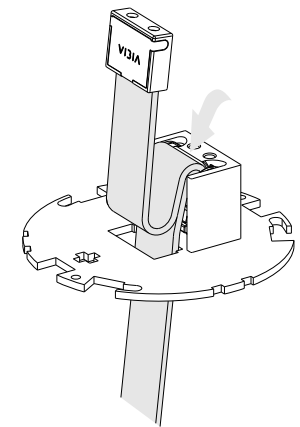

3.1

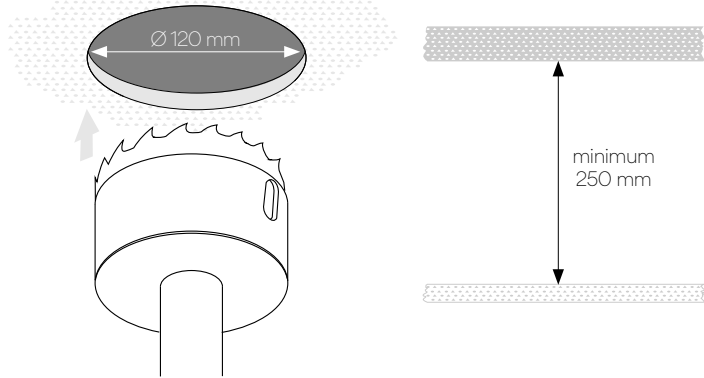

3.2

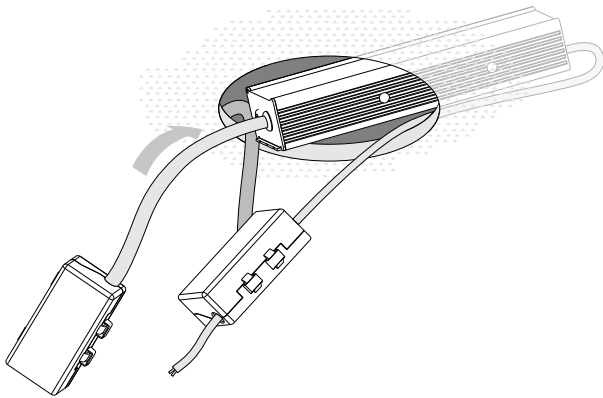

3.3

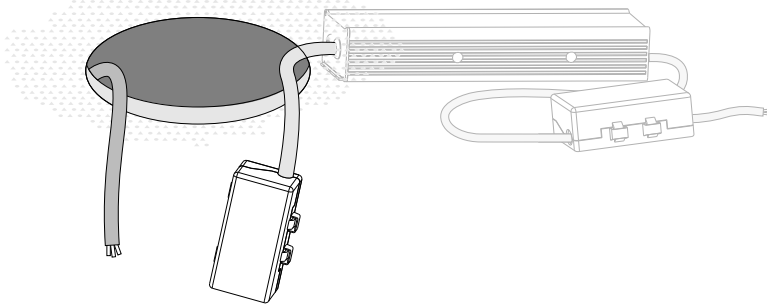

3.4



CAUTION: To avoid possible electrical shock, make certain electricity is shut off at main panel before wiring.

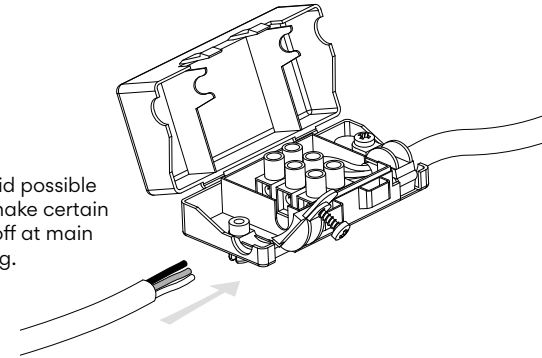

**DIMMING OPTIONS:**

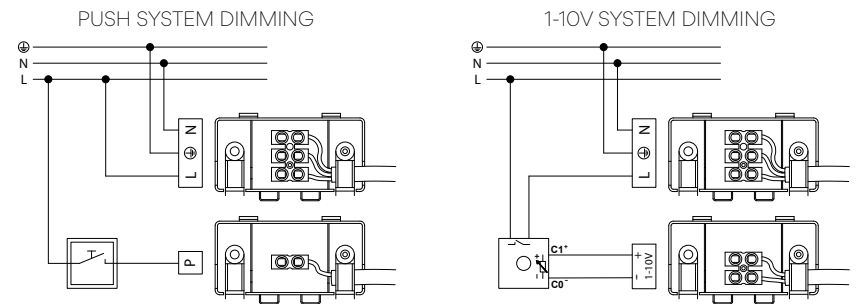
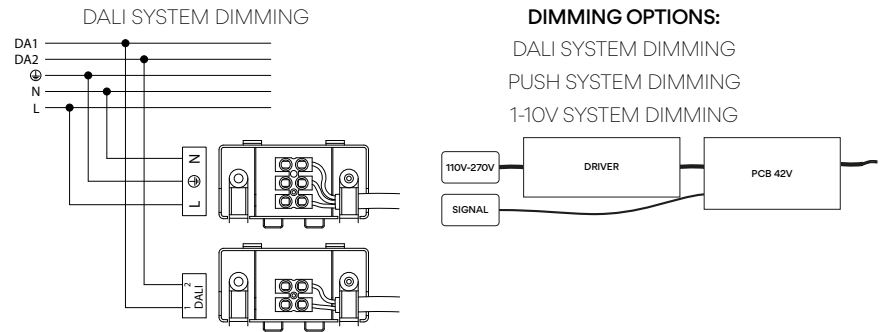
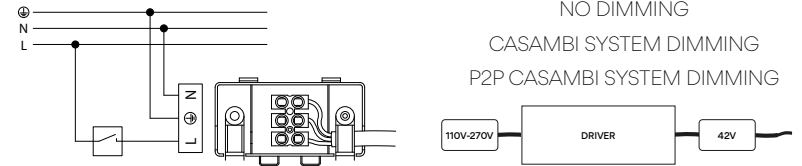

4.1

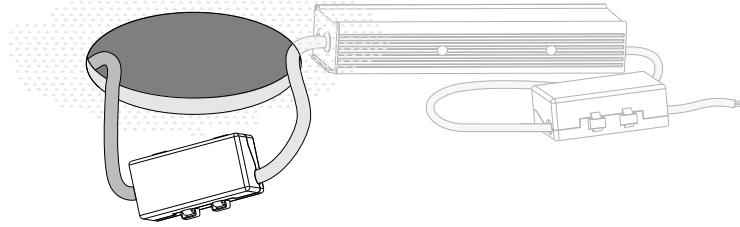

4.2

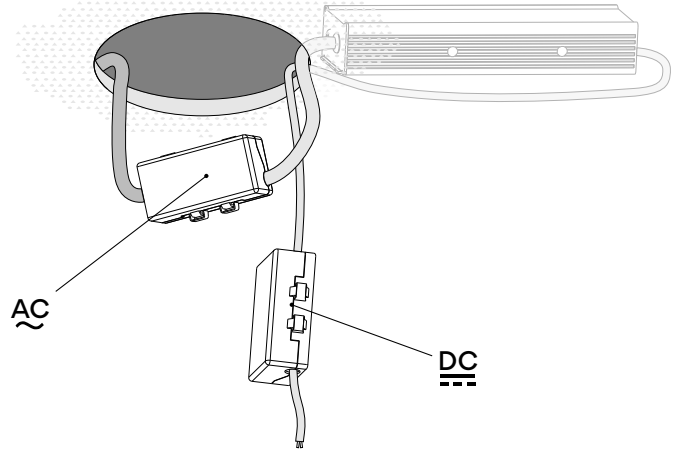

4.3

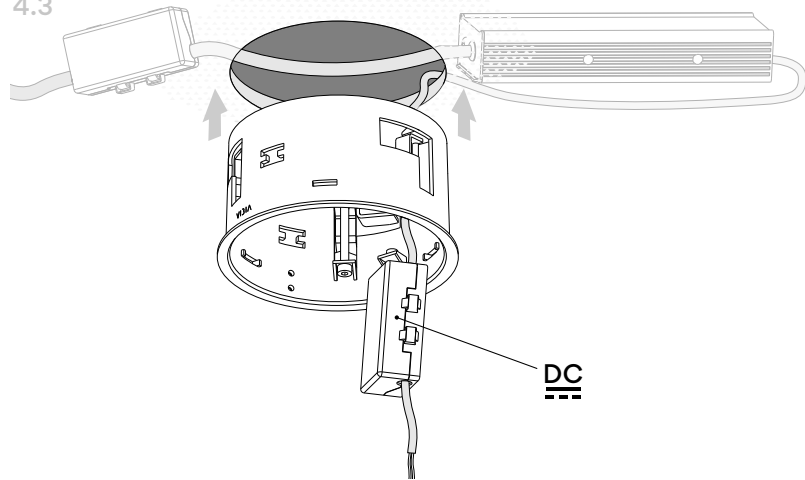

4.4

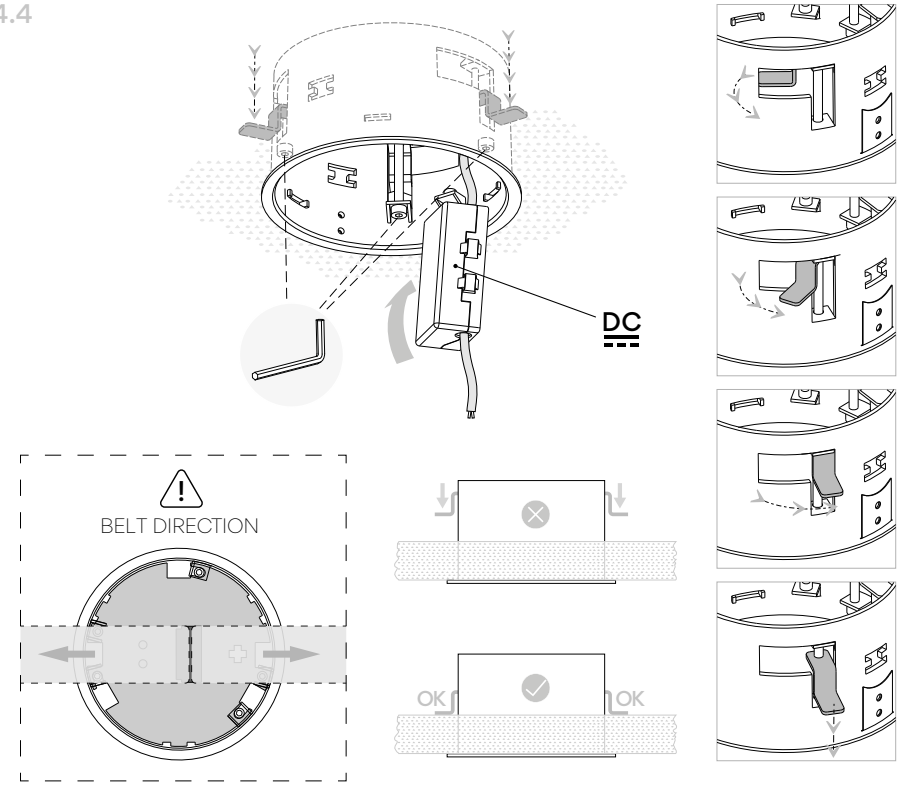

4.5

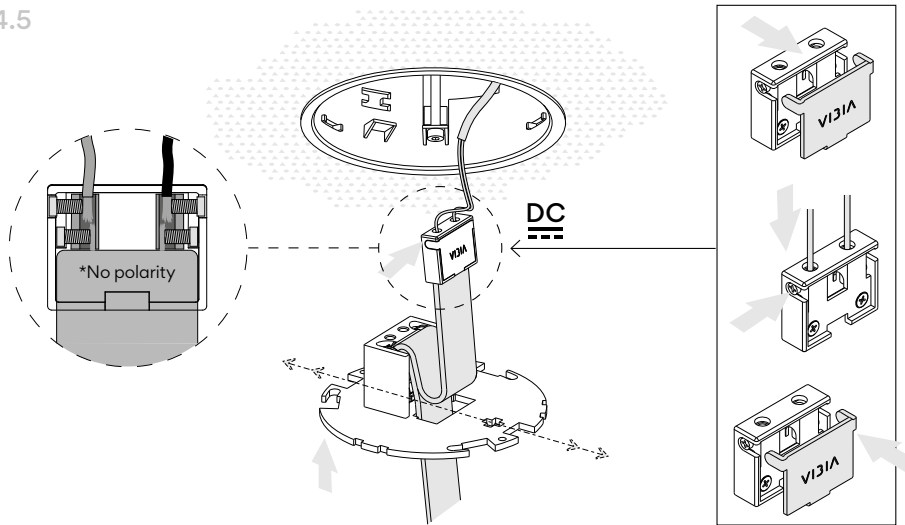

5.1

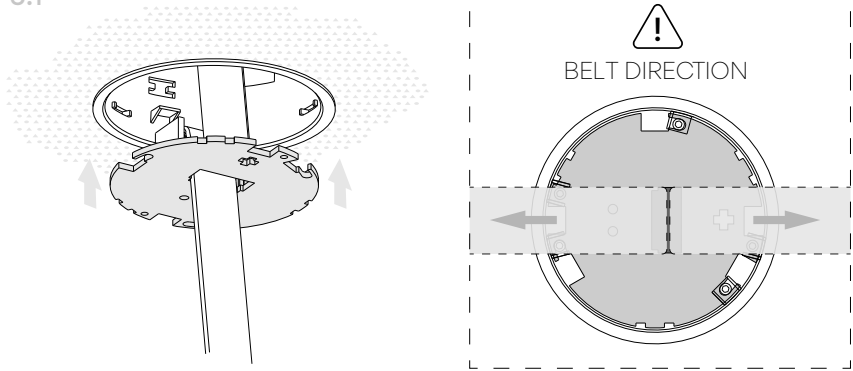

5.2

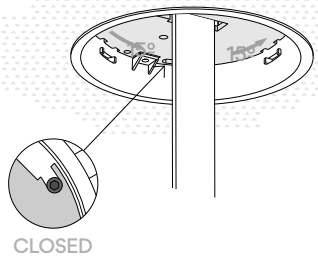

5.3

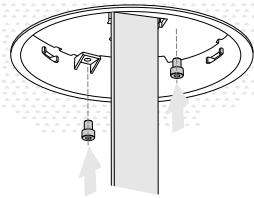

5.4

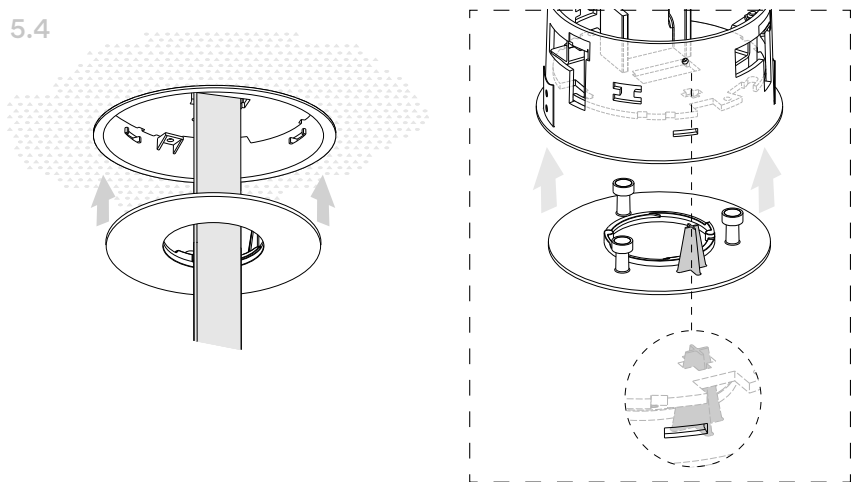

6.1

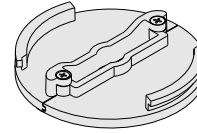

6.2

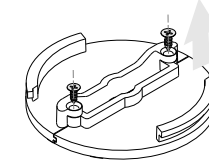

6.3

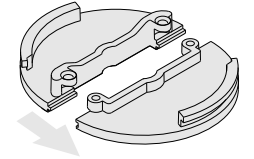

6.4

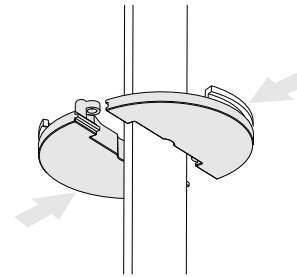

6.5

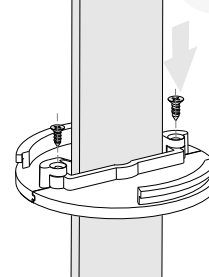

6.6

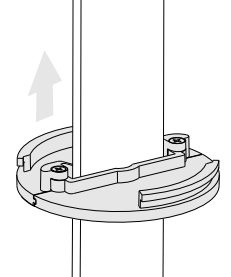

6.7

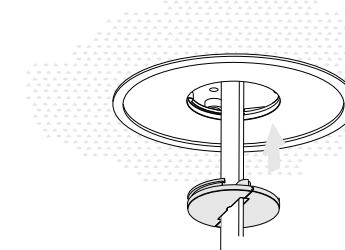

6.8

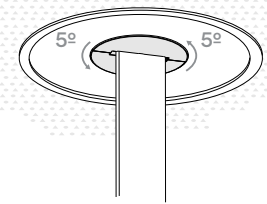



## E4 Remote Built-in Canopy

Watch video



Technical specifications / Especificaciones técnicas / Technische Daten  
Specifiche tecniche / Caractéristiques techniques

<b>ACPM000165</b> REMOTE BUILT IN CANOPY 25W ON-OFF	0,45 Kg.
<b>ACPM000166</b> REMOTE BUILT IN CANOPY 40W ON-OFF	0,45 Kg.
<b>ACPM000167</b> REMOTE BUILT IN CANOPY 60W ON-OFF	0,45 Kg.
<b>ACPM000168</b> REMOTE BUILT IN CANOPY 120W ON-OFF	1,10 Kg.
<b>ACPM000169</b> REMOTE BUILT IN CANOPY 240W ON-OFF	1,20 Kg.
<b>ACPM000195</b> REMOTE BUILT IN CANOPY 25W CASAMBI P2P	0,45 Kg.
<b>ACPM000196</b> REMOTE BUILT IN CANOPY 40W CASAMBI P2P	0,45 Kg.
<b>ACPM000197</b> REMOTE BUILT IN CANOPY 60W CASAMBI P2P	0,45 Kg.
<b>ACPM000198</b> REMOTE BUILT IN CANOPY 120W CASAMBI P2P	1,10 Kg.
<b>ACPM000199</b> REMOTE BUILT IN CANOPY 240W CASAMBI P2P	1,20 Kg.
<b>ACPM000175</b> REMOTE BUILT IN CANOPY 25W SIMULTANEOUS LINE DALI	0,90 Kg.
<b>ACPM000176</b> REMOTE BUILT IN CANOPY 40W SIMULTANEOUS LINE DALI	0,90 Kg.
<b>ACPM000177</b> REMOTE BUILT IN CANOPY 60W SIMULTANEOUS LINE DALI	0,90 Kg.
<b>ACPM000178</b> REMOTE BUILT IN CANOPY 120W SIMULTANEOUS LINE DALI	1,50 Kg.
<b>ACPM000179</b> REMOTE BUILT IN CANOPY 240W SIMULTANEOUS LINE DALI	1,70 Kg.
<b>ACPM000185</b> REMOTE BUILT IN CANOPY 25W SIMULTANEOUS LINE CASAMBI	0,90 Kg.
<b>ACPM000186</b> REMOTE BUILT IN CANOPY 40W SIMULTANEOUS LINE CASAMBI	0,90 Kg.
<b>ACPM000187</b> REMOTE BUILT IN CANOPY 60W SIMULTANEOUS LINE CASAMBI	0,90 Kg.
<b>ACPM000188</b> REMOTE BUILT IN CANOPY 120W SIMULTANEOUS LINE CASAMBI	1,50 Kg.
<b>ACPM000189</b> REMOTE BUILT IN CANOPY 240W SIMULTANEOUS LINE CASAMBI	1,70 Kg.

<b>ACPM000205</b> REMOTE BUILT IN CANOPY 25W SIMULTANEOUS LINE 1-10V	0,90 Kg.
<b>ACPM000206</b> REMOTE BUILT IN CANOPY 40W SIMULTANEOUS LINE 1-10V	0,90 Kg.
<b>ACPM000207</b> REMOTE BUILT IN CANOPY 60W SIMULTANEOUS LINE 1-10V	0,90 Kg.
<b>ACPM000208</b> REMOTE BUILT IN CANOPY 120W SIMULTANEOUS LINE 1-10V	1,50 Kg.
<b>ACPM000209</b> REMOTE BUILT IN CANOPY 240W SIMULTANEOUS LINE 1-10V	1,70 Kg.
<b>ACPM000360</b> REMOTE BUILT IN CANOPY 25W SIMULTANEOUS LINE PUSH	0,90 Kg.
<b>ACPM000361</b> REMOTE BUILT IN CANOPY 40W SIMULTANEOUS LINE PUSH	0,90 Kg.
<b>ACPM000362</b> REMOTE BUILT IN CANOPY 60W SIMULTANEOUS LINE PUSH	0,90 Kg.
<b>ACPM000363</b> REMOTE BUILT IN CANOPY 120W SIMULTANEOUS LINE PUSH	1,50 Kg.
<b>ACPM000364</b> REMOTE BUILT IN CANOPY 240W SIMULTANEOUS LINE PUSH	1,70 Kg.

SIMULTANEOUS LINE 1-10V

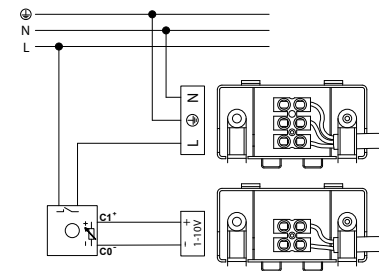

SIMULTANEOUS LINE DALI

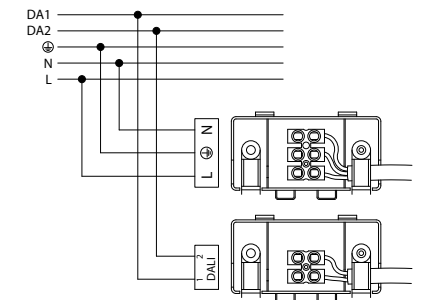

SIMULTANEOUS LINE PUSH

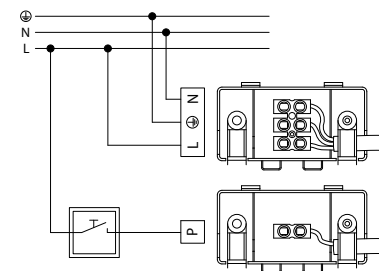

ON-OFF / CASAMBI P2P / CASAMBI

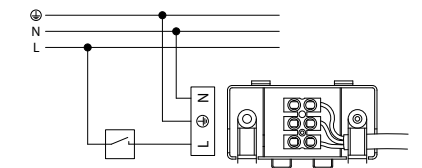

1.0

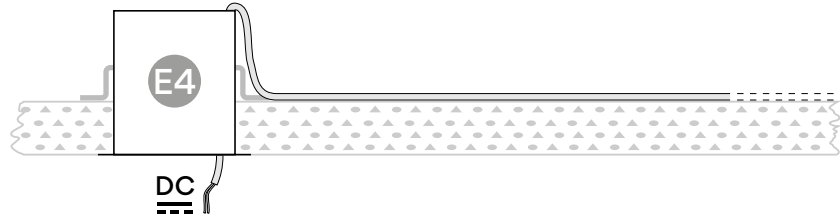

1.1

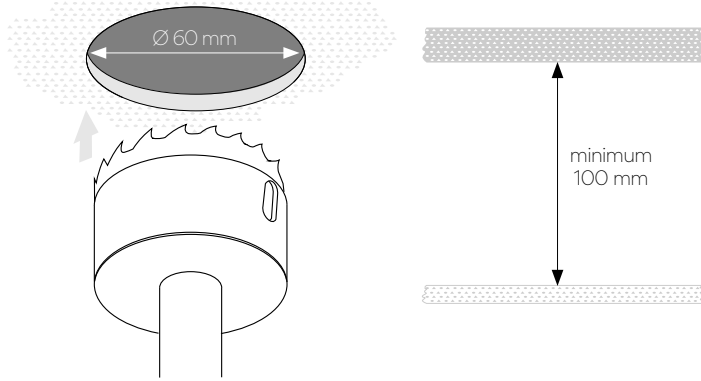

1.2

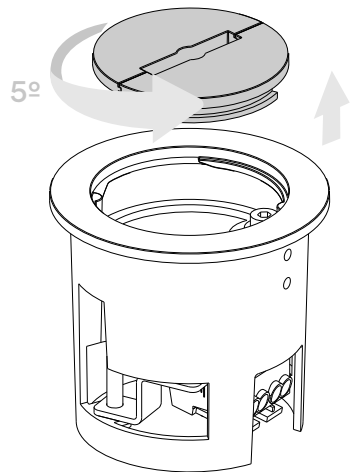

1.3

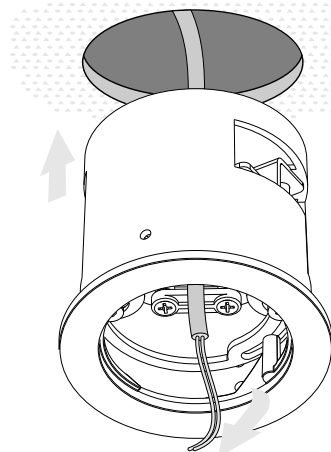

2.1

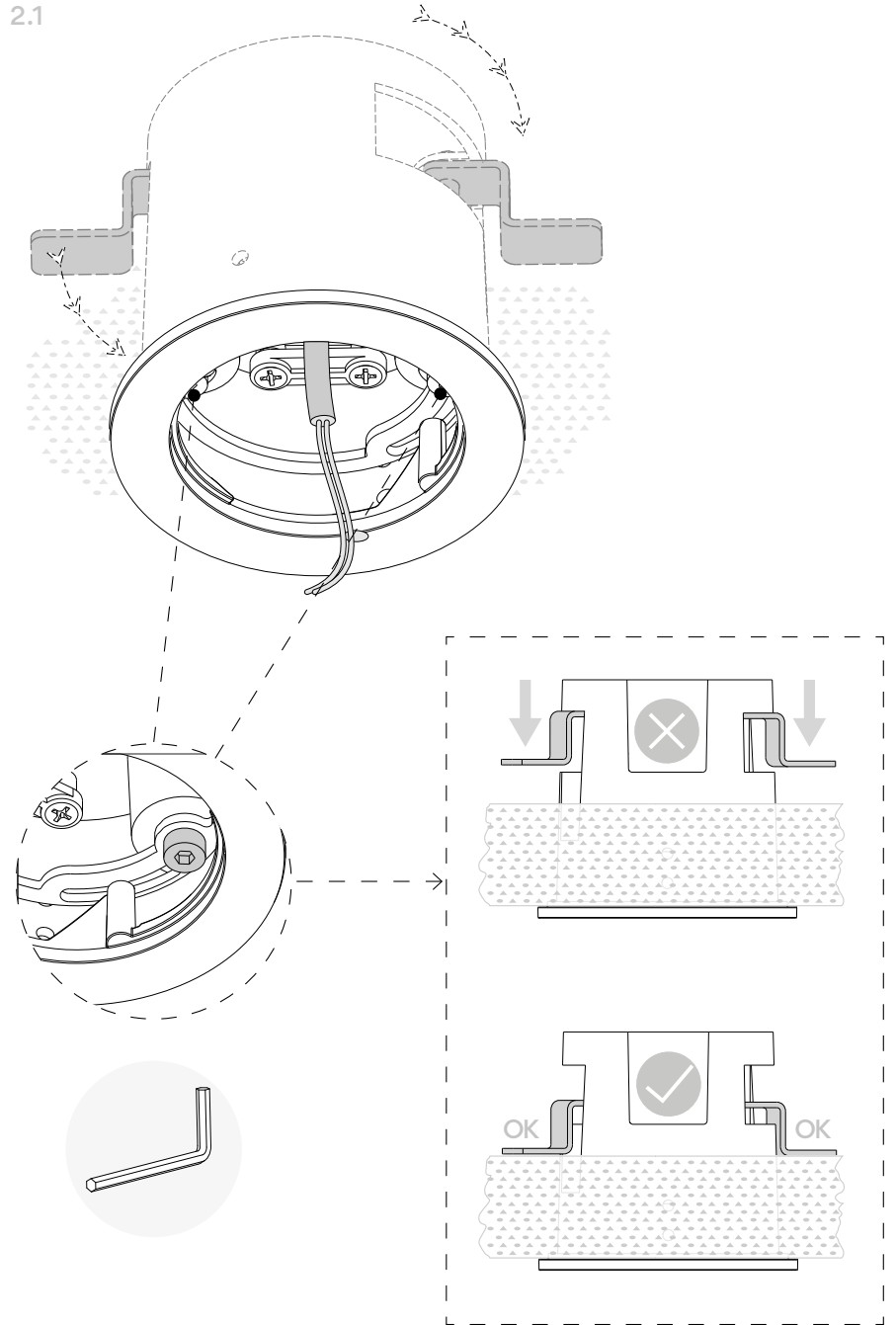

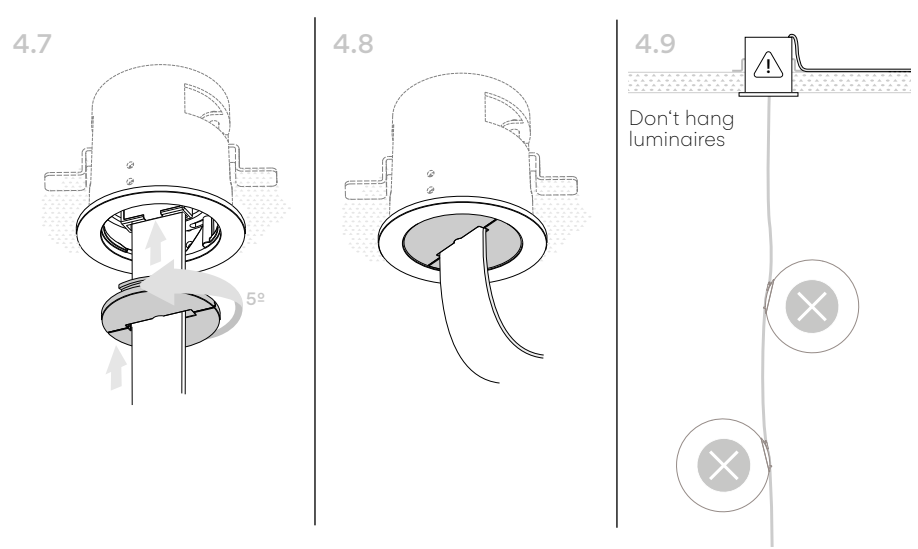
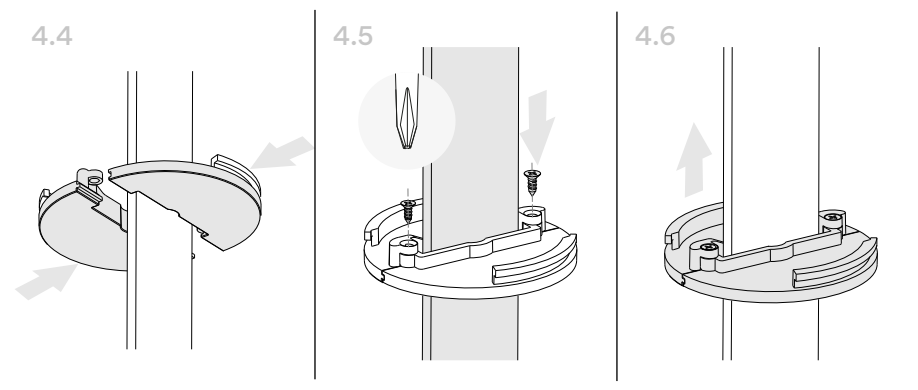
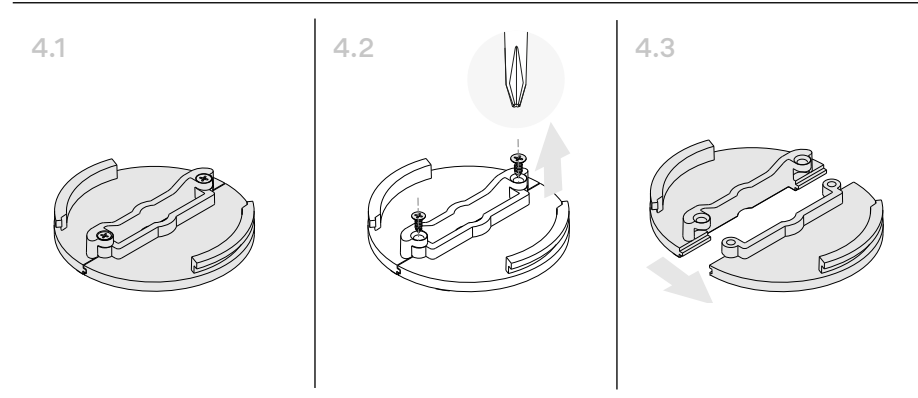
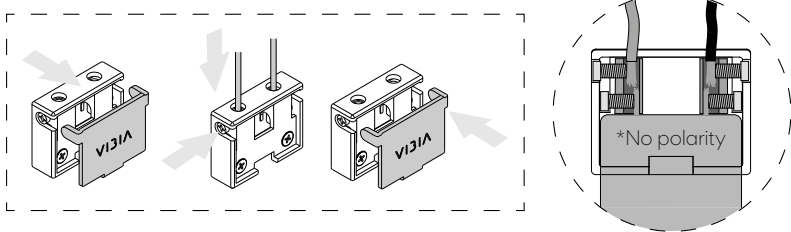
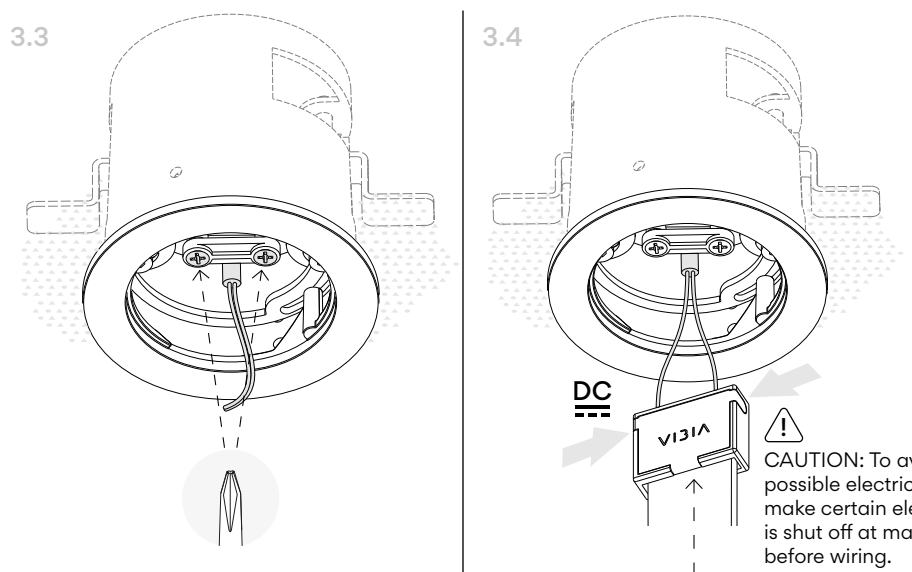
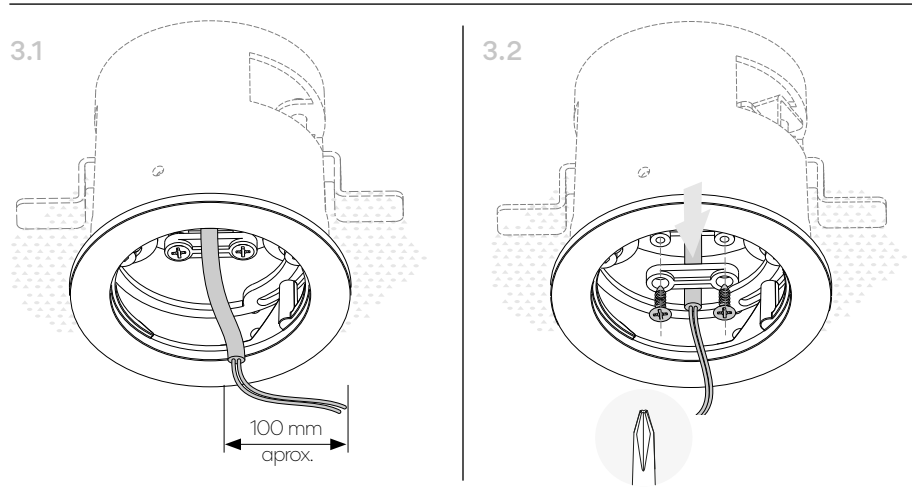

# E5 Remote Surface Canopy

Watch video



Technical specifications / Especificaciones técnicas / Technische Daten  
 Specifiche tecniche / Caractéristiques techniques

<b>ACPM000268</b> REMOTE SURFACE CANOPY 25W ON-OFF	0,45 Kg. □ CE IP20 90-305V Multi-volt
<b>ACPM000269</b> REMOTE SURFACE CANOPY 40W ON-OFF	0,45 Kg. □ CE IP20 90-305V Multi-volt
<b>ACPM000270</b> REMOTE SURFACE CANOPY 60W ON-OFF	0,45 Kg. □ CE IP20 90-305V Multi-volt
<b>ACPM000271</b> REMOTE SURFACE CANOPY 120W ON-OFF	1,10 Kg. ⊕ CE IP20 90-305V Multi-volt
<b>ACPM000272</b> REMOTE SURFACE CANOPY 240W ON-OFF	1,20 Kg. ⊕ CE IP20 90-305V Multi-volt
<b>ACPM000288</b> REMOTE SURFACE CANOPY 25W CASAMBI P2P	0,45 Kg. □ CE IP20 90-305V Multi-volt
<b>ACPM000289</b> REMOTE SURFACE CANOPY 40W CASAMBI P2P	0,45 Kg. □ CE IP20 90-305V Multi-volt
<b>ACPM000290</b> REMOTE SURFACE CANOPY 60W CASAMBI P2P	0,45 Kg. □ CE IP20 90-305V Multi-volt
<b>ACPM000291</b> REMOTE SURFACE CANOPY 120W CASAMBI P2P	1,10 Kg. ⊕ CE IP20 90-305V Multi-volt
<b>ACPM000292</b> REMOTE SURFACE CANOPY 240W CASAMBI P2P	1,20 Kg. ⊕ CE IP20 90-305V Multi-volt
<b>ACPM000273</b> REMOTE SURFACE CANOPY 25W SIMULTANEOUS LINE DALI	0,90 Kg. □ CE IP20 Dimmer 90-305V Multi-volt
<b>ACPM000274</b> REMOTE SURFACE CANOPY 40W SIMULTANEOUS LINE DALI	0,90 Kg. □ CE IP20 Dimmer 90-305V Multi-volt
<b>ACPM000275</b> REMOTE SURFACE CANOPY 60W SIMULTANEOUS LINE DALI	0,90 Kg. □ CE IP20 Dimmer 90-305V Multi-volt
<b>ACPM000276</b> REMOTE SURFACE CANOPY 120W SIMULTANEOUS LINE DALI	1,50 Kg. ⊕ CE IP20 Dimmer 90-305V Multi-volt
<b>ACPM000277</b> REMOTE SURFACE CANOPY 240W SIMULTANEOUS LINE DALI	1,70 Kg. ⊕ CE IP20 Dimmer 90-305V Multi-volt
<b>ACPM000278</b> REMOTE SURFACE CANOPY 25W SIMULTANEOUS LINE 1-10V	0,90 Kg. □ CE IP20 Dimmer 90-305V Multi-volt
<b>ACPM000279</b> REMOTE SURFACE CANOPY 40W SIMULTANEOUS LINE 1-10V	0,90 Kg. □ CE IP20 Dimmer 90-305V Multi-volt
<b>ACPM000280</b> REMOTE SURFACE CANOPY 60W SIMULTANEOUS LINE 1-10V	0,90 Kg. □ CE IP20 Dimmer 90-305V Multi-volt
<b>ACPM000281</b> REMOTE SURFACE CANOPY 120W SIMULTANEOUS LINE 1-10V	1,50 Kg. ⊕ CE IP20 Dimmer 90-305V Multi-volt
<b>ACPM000282</b> REMOTE SURFACE CANOPY 240W SIMULTANEOUS LINE 1-10V	1,70 Kg. ⊕ CE IP20 Dimmer 90-305V Multi-volt

<b>ACPM000283</b> REMOTE SURFACE CANOPY 25W SIMULTANEOUS LINE CASAMBI	0,90 Kg. □ CE IP20 Dimmer 90-305V Multi-volt
<b>ACPM000284</b> REMOTE SURFACE CANOPY 40W SIMULTANEOUS LINE CASAMBI	0,90 Kg. □ CE IP20 Dimmer 90-305V Multi-volt
<b>ACPM000285</b> REMOTE SURFACE CANOPY 60W SIMULTANEOUS LINE CASAMBI	0,90 Kg. □ CE IP20 Dimmer 90-305V Multi-volt
<b>ACPM000286</b> REMOTE SURFACE CANOPY 120W SIMULTANEOUS LINE CASAMBI	1,50 Kg. ⊕ CE IP20 Dimmer 90-305V Multi-volt
<b>ACPM000287</b> REMOTE SURFACE CANOPY 240W SIMULTANEOUS LINE CASAMBI	1,70 Kg. ⊕ CE IP20 Dimmer 90-305V Multi-volt
<b>ACPM000365</b> REMOTE SURFACE CANOPY 25W SIMULTANEOUS LINE PUSH	0,90 Kg. □ CE IP20 Dimmer 90-305V Multi-volt
<b>ACPM000366</b> REMOTE SURFACE CANOPY 40W SIMULTANEOUS LINE PUSH	0,90 Kg. □ CE IP20 Dimmer 90-305V Multi-volt
<b>ACPM000367</b> REMOTE SURFACE CANOPY 60W SIMULTANEOUS LINE PUSH	0,90 Kg. □ CE IP20 Dimmer 90-305V Multi-volt
<b>ACPM000368</b> REMOTE SURFACE CANOPY 120W SIMULTANEOUS LINE PUSH	1,50 Kg. ⊕ CE IP20 Dimmer 90-305V Multi-volt
<b>ACPM000369</b> REMOTE SURFACE CANOPY 240W SIMULTANEOUS LINE PUSH	1,70 Kg. ⊕ CE IP20 Dimmer 90-305V Multi-volt

SIMULTANEOUS LINE 1-10V

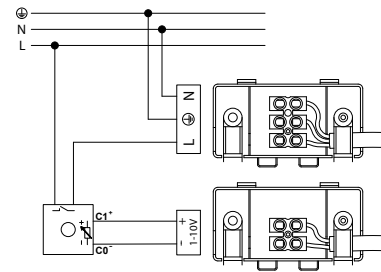

SIMULTANEOUS LINE DALI

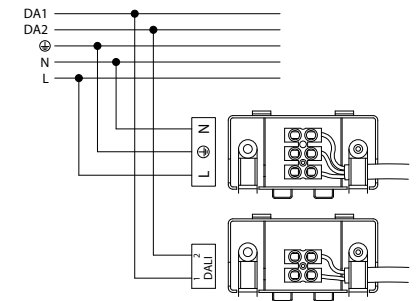

SIMULTANEOUS LINE PUSH

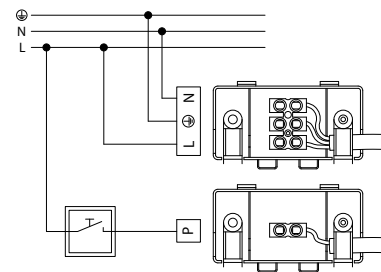

ON-OFF / CASAMBI P2P / CASAMBI

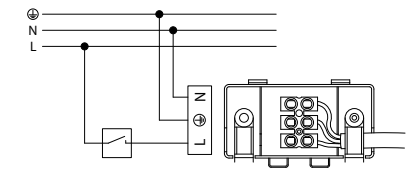

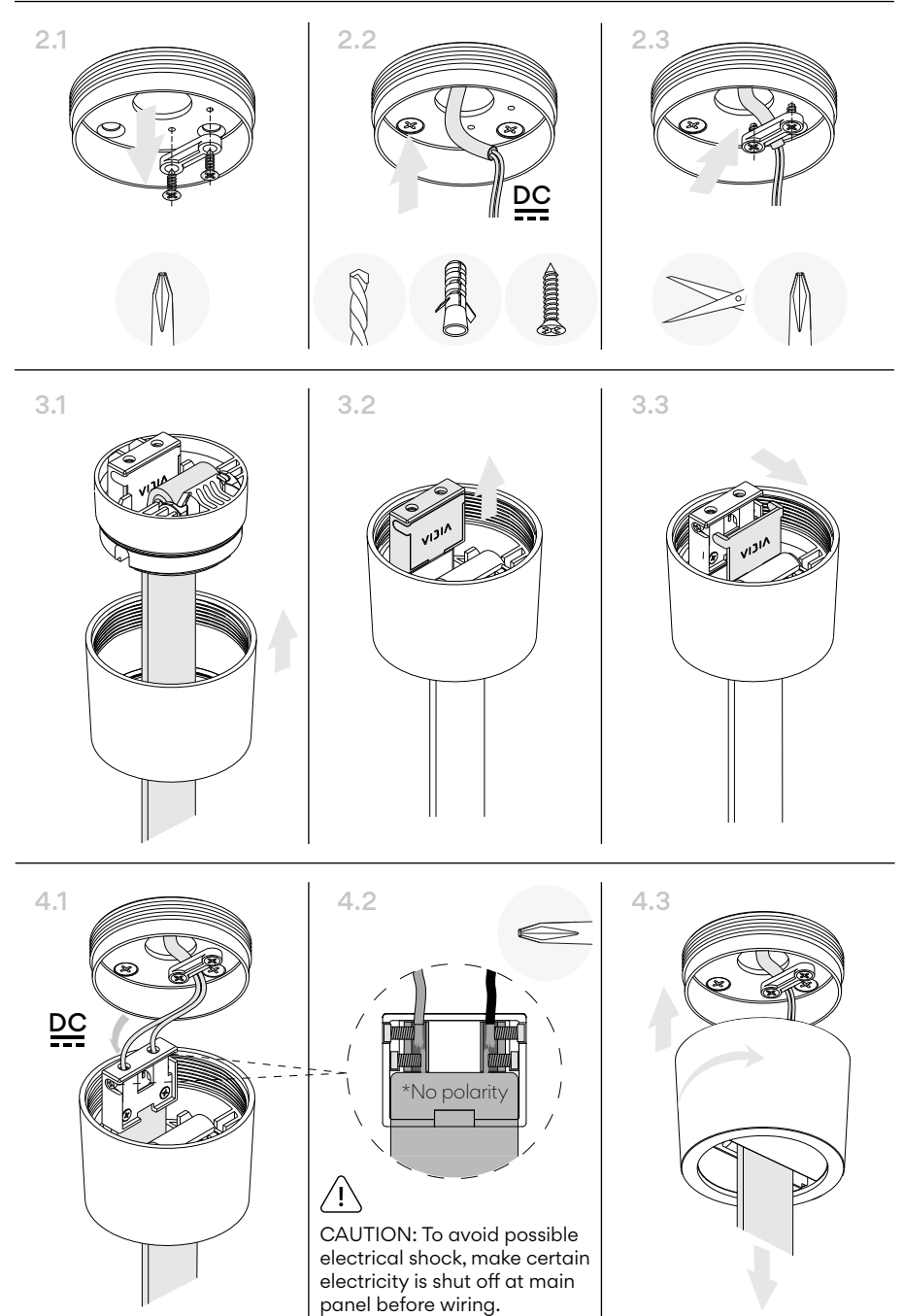
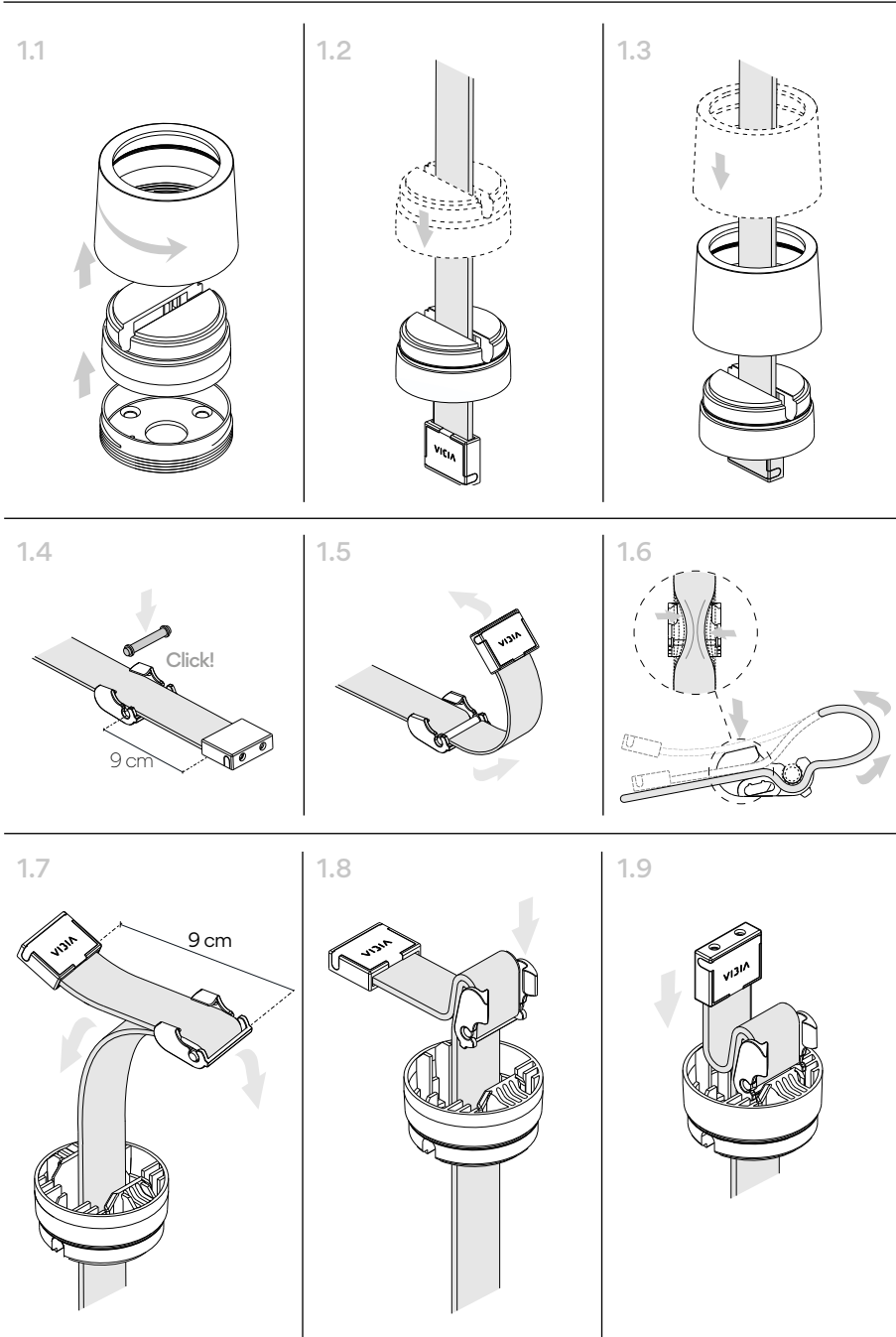

# E6 Plug-in Floor Switch



Watch video



**ACPM000373**  
PLUG IN FLOOR SWITCH 60W ON-OFF

0,45 Kg.

**ACPM000374**  
PLUG IN FLOOR SWITCH 60W PUSH

0,45 Kg.

**ACPM000375**  
PLUG IN FLOOR SWITCH 60W CASAMBI P2P

0,45 Kg.

1.1

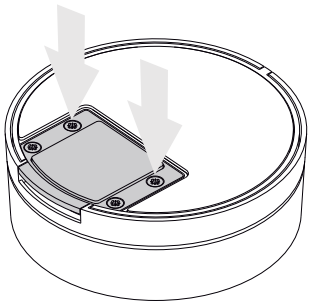

1.2

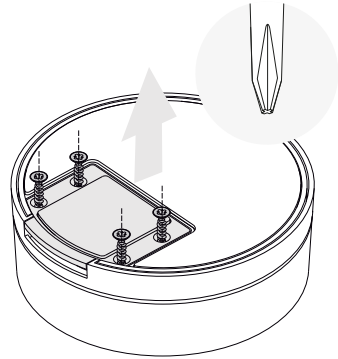

1.3

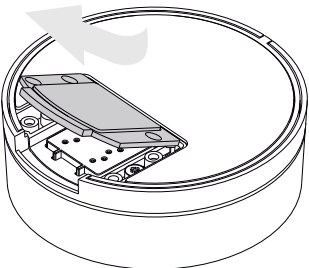

1.4

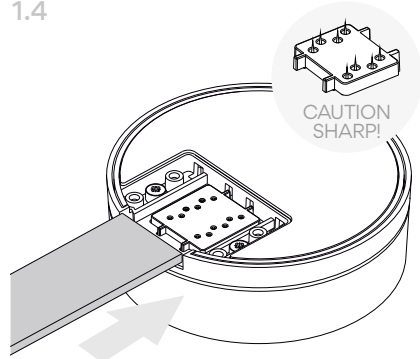

1.5

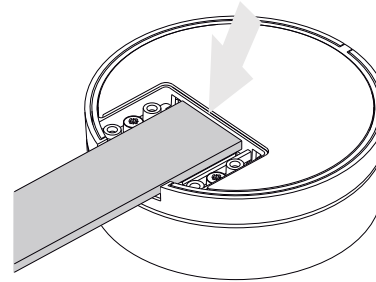

1.6

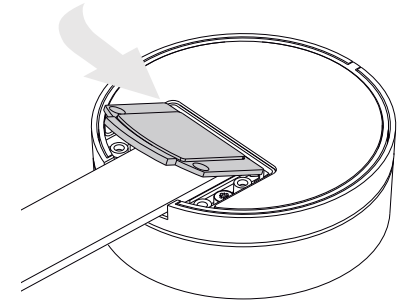

1.7

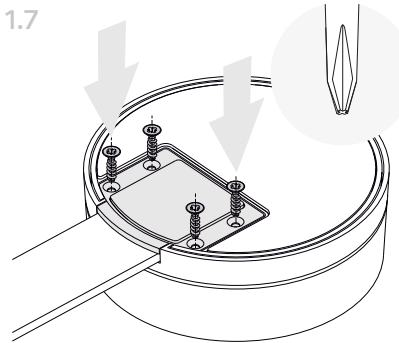

1.8

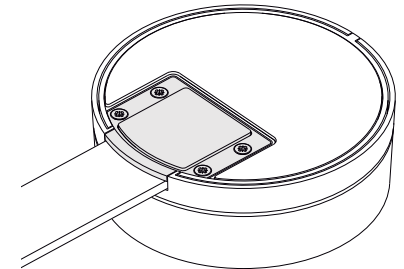

2.1

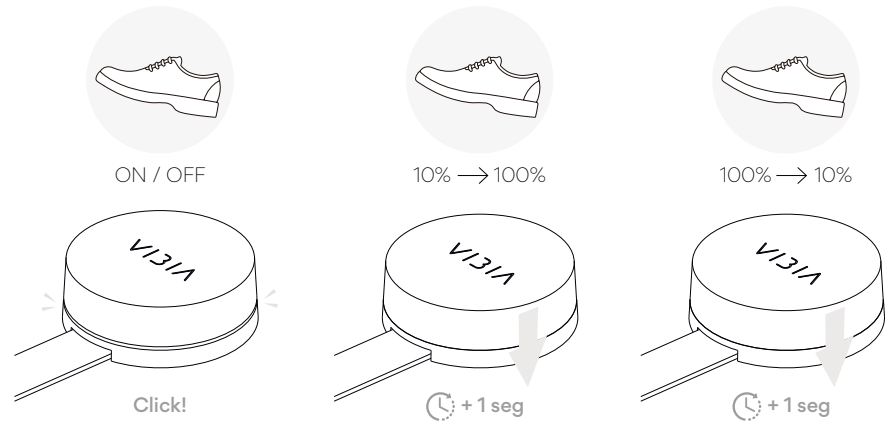



# E8 Wire Connector

Watch video



## ACPM000293

Wire Connector < 60W Cable length: 3 meters / Cable section: Ø 3,1 mm ⚖️ 0,40 Kg. CE IP20

## ACPM000294

Wire Connector < 60W Cable length: 9 meters / Cable section: Ø 3,1 mm ⚖️ 1,20 Kg. CE IP20

## ACPM000295

Wire Connector > 60W Cable length: 3 meters / Cable section: Ø 5,8 mm ⚖️ 0,60 Kg. CE IP20

## ACPM000296

Wire Connector > 60W Cable length: 9 meters / Cable section: Ø 5,8 mm ⚖️ 1,80 Kg. CE IP20

1.1A

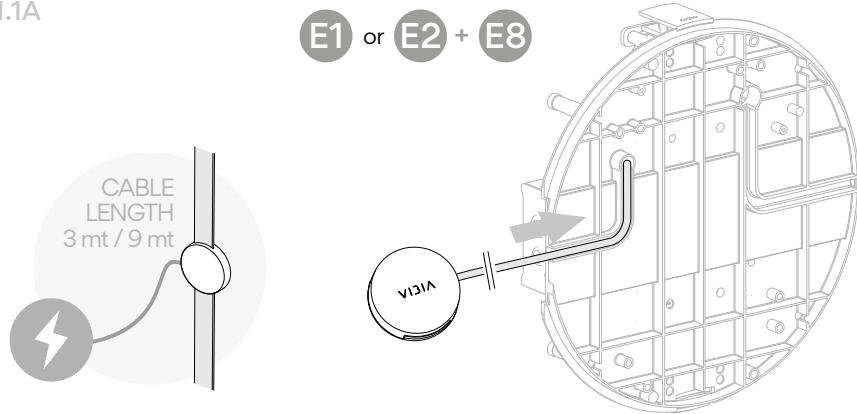

1.2A

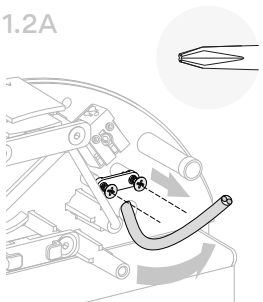

1.3A

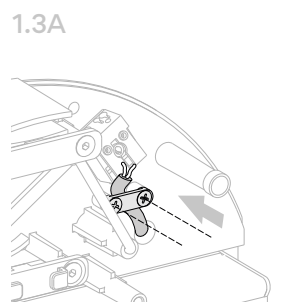

1.4A

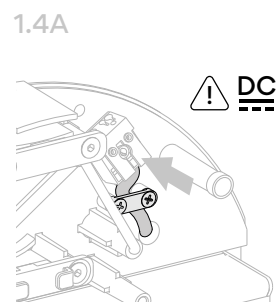

1.B

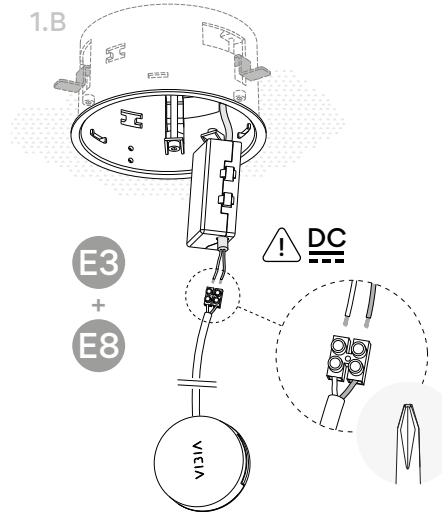

1.C

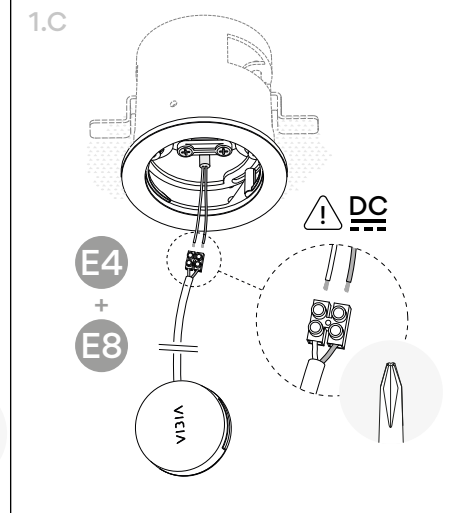

2.1

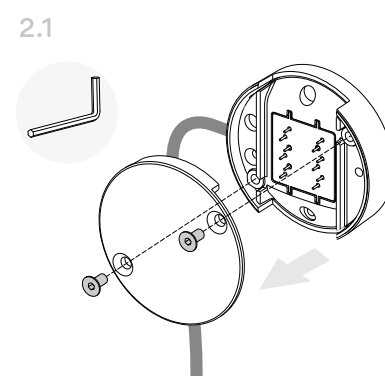

2.2

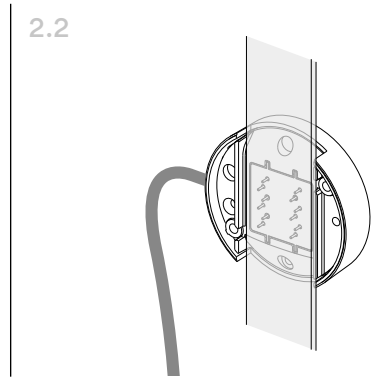

2.3

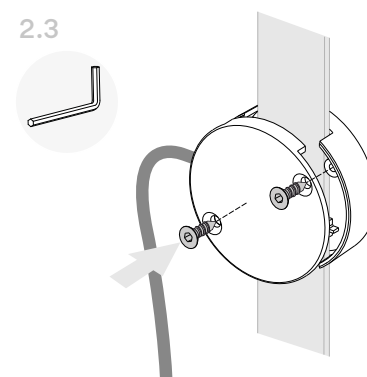

2.4

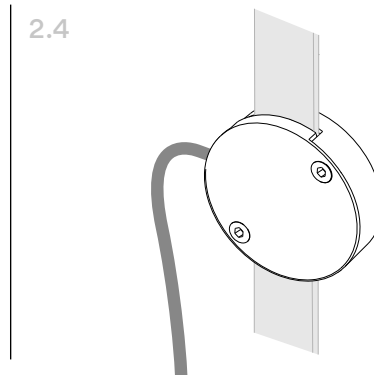

## Caution

**Before assembling and installing this product, carefully read the following:**

- Switch off the mains before installing the luminaire.
- For ceiling, wall or floor installations choose the most suitable fixing elements based on the relevant construction materials.
- Before the installation, make sure the installation surface will not be damaged. If this happens, it will be the installer's responsibility.
- If the belt part of the light fitting is damaged the replacement strap must be ordered through the manufacturer or its technical service to avoid risks.
- This lamp is for indoor use only, excluding bathrooms or any type of damp surface.
- Make sure that the ceiling, wall or floor are capable of supporting the weight and tensile strength of the light.
- We recommend reading the manual before installing the lamp. Keep these instructions for future reference.
- At least 2 people are needed to install and uninstall the lamp.
- Use these gloves to touch the lamp during the installation to avoid smudges and dirt on its surface.
- Once the light fittings are attached to the strap do not force them in any direction. There is a risk of damaging connecting pins.

## Precaución

**Antes de proceder al montaje e instalación de esta luminaria, leer detenidamente las siguientes consideraciones:**

- Desconectar el suministro eléctrico antes de proceder a la instalación de la luminaria.
- Para el montaje de la luminaria al techo, pared o suelo elegir los elementos de fijación más adecuados en función del material constructivo.
- Asegurarse antes de realizar esta operación que no se producirán daños irreparables en el soporte de instalación. En caso contrario la responsabilidad será del instalador.
- Si la cinta de esta luminaria está dañada, deberá ser solicitado el repuesto exclusivamente al fabricante o su servicio técnico, para evitar cualquier riesgo.
- Esta luminaria es apta únicamente para su uso en interior, excepto en baños o cualquier tipo de superficie húmeda.
- Asegúrese de que su techo, pared o suelo sea capaz de soportar el peso y la tensión de esta luminaria.
- Recomendamos leer el manual antes de iniciar la instalación de la luminaria. Guardar estas instrucciones para futuras consultas.
- Para el montaje y desmontaje de esta luminaria se recomienda la participación de un mínimo de 2 personas.
- Utilice estos guantes para manipular la luminaria durante el montaje y evitar un posible trasvase de suciedad de sus manos.
- Una vez instaladas las luminarias en la cinta, no forzar en ningún sentido. Riesgo de rotura de las agujas de conexión.

## Vorsicht

**Bevor Sie mit der Montage dieser Leuchte beginnen, sollten Sie die folgenden Hinweise in aller Ruhe lesen und berücksichtigen:**

- Schalten Sie vor dem elektrischen Anschluss den Strom ab.
- Für die Montage der Leuchte an der Decke, der Wand oder dem Boden sind je nach vorhandenen Baubedingungen die am besten geeigneten Befestigungselemente zu wählen.
- Vergewissern Sie sich vor diesem Prozess, dass die Vorrichtung hierdurch nicht dauerhaft beschädigt wird. Im entgegengesetzten Falle wäre der Installateur hierfür verantwortlich.
- Wenn das Band dieser Leuchte beschädigt ist, darf nur ein vom Hersteller oder seinem Kundendienst bereitgestellter Ersatz verwendet werden, um Risiken zu vermeiden.
- Diese Leuchte ist ausschließlich für den Gebrauch im Innenbereich vorgesehen, außer Bädern oder anderen Feuchträumen.
- Stellen Sie sicher, dass die Decke, Wand oder Boden dem Gewicht und der Spannung dieser Leuchte standhalten.
- Wir empfehlen vor Montagebeginn die Anleitung zu lesen. Bewahren Sie die Anleitung für etwaige zukünftige Fragen auf.
- Für Montage und Demontage dieser Leuchte wird die Beteiligung von mindestens 2 Personen empfohlen.
- Benutzen Sie diese Handschuhe während der Montage, um keinen Schmutz der Hände auf die Leuchte zu übertragen.
- Sobald die Leuchten auf dem Band installiert sind, darf auf sie keinerlei Druck in irgendeine Richtung ausgeübt werden. Es besteht die Gefahr des Bruchs der Verbindungs-Pins.

## Attention

**Prima di procedere al montaggio e all'installazione di questo apparecchio, leggere attentamente le seguenti considerazioni:**

- Scollegare l'alimentazione prima di procedere all'installazione dell'apparecchio.
- Per il montaggio della lampada al soffitto, alla parete o al pavimento usare gli strumenti di fissaggio più adeguati in base al materiale di costruzione.
- Prima di eseguire questa operazione, assicurarsi che la superficie di installazione non venga danneggiata irrimediabilmente. In caso contrario, la responsabilità sarà del montatore.
- Se il nastro di questa lampada è danneggiato, è necessario richiederne la sostituzione esclusivamente al produttore o all'assistenza tecnica per evitare qualsiasi rischio.
- La lampada è adatta solamente per uso interno, eccetto bagni o qualsiasi tipo di superficie umida.
- Assicurarsi che il soffitto, la parete o il pavimento sia in grado di reggere il peso e la tensione della lampada.
- Si raccomanda di leggere il manuale prima di installare la lampada. Conservare le presenti istruzioni per future consultazioni.
- Le operazioni di montaggio e smontaggio della lampada devono essere eseguite da un minimo di 2 persone.
- Indossare i guanti inclusi nella confezione per maneggiare la lampada durante il montaggio ed evitare di contaminare la superficie.
- Una volta installate le lampade sul nastro, non forzare in nessuna direzione. Rischio di rottura degli spilli di collegamento.

## Attenzione

**Avant de procéder à l'assemblage et à l'installation de ce luminaire, lisez attentivement les considérations suivantes:**

- Débrancher l'alimentation avant de procéder à l'installation du luminaire.
- Si le luminaire doit être fixé au plafond, au mur ou au sol, assurez-vous de choisir les éléments de fixation les mieux adaptés au matériau du support.
- Avant de réaliser cette opération, assurez-vous que le support d'installation ne subira aucun dommage irréversible. Dans le cas contraire, la responsabilité des dommages incombera à l'installateur.
- Si la sangle de ce luminaire était endommagée et qu'il vous fallait la remplacer, pour éviter tout risque, adressez-vous exclusivement au fabricant ou à son service technique.
- Ce luminaire est exclusivement destiné à une utilisation en intérieur, à l'exception des salles de bain et autre environnement humide.
- Assurez-vous que le plafond, le mur ou le sol peuvent supporter le poids et la tension exercés par ce luminaire.
- Nous vous recommandons de lire le manuel avant de commencer l'installation du luminaire. Conservez ces instructions pour de futures consultations.
- Pour le montage et le démontage de ce luminaire, la présence de 2 personnes est recommandée.
- Lors du montage, manipulez ce luminaire à l'aide des gants fournis pour éviter toute trace de doigts.
- Une fois les lampes installées sur la sangle, ne forcez jamais dans l'autre. Les aiguilles de connexion pourraient se briser.

## Caution

- Do not disassemble, modify or try to repair this fitting. In order to get technical assistance contact [VIBIA.com/support](http://VIBIA.com/support). Any change or modification to the light fitting can null the manufacturer's guarantee.
- Make sure that the assembly of the area around the light fitting clips is correct. Be careful with the pins!
- Never leave the end of the belt exposed. Always use an End Cap. Danger of electrical discharge.
- Never splice two different belt together under any circumstances.
- Do not connect the belt to the electrical current.
- Never hang any other objects off the light fitting belt.
- While carrying out the installation keep the belt within the original packaging box to avoid getting dirty.
- Use the tools provided by VIBIA.com to regulate the belt tension and the light fitting fixings.
- Always commence the belt anchoring from the point of the lighting configuration.
- When starting the installation always use the paper tape provided by VIBIA to correctly determine the fabric strap distances.
- Under no circumstances should any additional lights be added to the belt other than those specified in the configuration manual.

## Precaución

- No desmonte, modifique, ni intente reparar la luminaria. Para recibir asistencia técnica, póngase en contacto con [VIBIA.com/support](http://VIBIA.com/support). Cualquier cambio o modificación en la luminaria puede anular la garantía del fabricante.
- Asegurarse de que el montaje en la zona de clipaje de las luminarias es el correcto. ¡Atención con las agujas!
- Nunca deje el final de la cinta al descubierto. Utilizar siempre un "End Cap". Peligro de descarga eléctrica.
- No unir de ninguna manera diferentes trozos de cinta.
- Nunca manipular ni cortar la cinta cuando está conectada a la corriente.
- No conectar la cinta directamente a la red eléctrica.
- No colgar otros objetos sobre la cinta de la luminaria.
- Durante la instalación conservar la cinta dentro de su caja original para evitar la suciedad.
- Utilizar siempre las herramientas facilitadas por VIBIA.com para la tensión de la cinta y la fijación de las luminarias.
- Iniciar siempre la fijación de la cinta desde el punto eléctrico de la composición.
- Al inicio de la instalación emplear la cinta de papel suministrada por VIBIA para definir correctamente las distancias de la cinta textil.
- En ningún caso añadir en la cinta textil más luminarias de las especificadas en el manual de la composición. Cada composición con sus luminarias, no mezclar.

## Vorsicht

- Die Leuchte nicht auseinanderbauen, baulich ändern oder reparieren. Für technische Hilfe kontaktieren. Eigenmächtig vorgenommene Änderungen an der Leuchte führen zu einem Verlust der Garantie.
- Es ist darauf zu achten, dass die Montage im Schnittbereich der Leuchte korrekt ausgeführt wird. Mit den Pins ist sorgsam umzugehen!
- Das Ende des Bandes darf niemals offengelassen werden. Die Endkappe muss stets genutzt werden. Es besteht sonst die Gefahr eines elektrischen Schlags.
- Unterschiedliche Abschnitte des Bandes keinesfalls verbinden.
- Es dürfen keine Arbeiten oder Schnitte am Band durchgeführt werden, solange elektrische Spannung anliegt.
- Das Band ist niemals direkt an das elektrische Netz anzuschließen.
- Keine Fremdgegenstände an das Band der Leuchte hängen.
- Das Band während der Originalverpackung aufbewahren, um Verschmutzungen zu vermeiden.
- Zum Spannen des Bandes und zur Befestigung der Leuchten sind stets die von VIBIA.com mitgelieferten Werkzeuge zu verwenden.
- Die Befestigung des Bandes immer am elektrischen Anschlusspunkt der Leuchtenkomposition beginnen.
- Zu Beginn der Installation sollte das von VIBIA mitgelieferte Papierband verwendet, um die Abstände des Textilbands korrekt festzulegen.
- Auf keinen Fall dürfen dem Textilband mehr Leuchten hinzugefügt werden als im Handbuch der Leuchtenkomposition angegeben. Jede Komposition verfügt über ihre eigenen Leuchten. Diese können nicht beliebig getauscht werden.

## Attention

- Non smontare, modificare né cercare di riparare la lampada. Per richiedere assistenza tecnica, mettersi in contatto con [VIBIA.com/support](http://VIBIA.com/support). Qualsiasi cambiamento o modifica alla lampada può annullare la garanzia del fabbricante.
- Assicurarsi che il montaggio nell'area di clipaggio delle lampade sia corretto. Attenzione agli spilli!
- Non lasciare allo scoperto l'estremità del nastro. Utilizzare sempre un "End Cap". Pericolo di scosse elettriche.
- Non unire in alcun modo pezzi di nastro differenti.
- Non maneggiare o tagliare il nastro quando è collegato alla corrente.
- Non collegare il nastro direttamente alla rete elettrica.
- Non appendere altri oggetti sul nastro della lampada.
- Durante l'installazione, conservare il nastro nella scatola originale per evitare che si sporchi.
- Utilizzare sempre gli strumenti forniti da VIBIA.com per tendere il nastro e fissare le lampade.
- Inizia sempre a fissare il nastro dal punto elettrico della composizione.
- All'inizio dell'installazione, utilizzare il nastro di carta fornito da VIBIA per definire correttamente le distanze del nastro in tessuto.
- Non aggiungere in nessun caso più lampade sul nastro in tessuto di quelle specificate nel manuale di composizione. Ogni composizione con le relative lampade; non mischiare.

## Attenzione

- Ne démontez pas le luminaire, ne le modifiez pas et n'essayez pas de le réparer. Pour bénéficier d'une assistance technique, contactez [VIBIA.com/support](http://VIBIA.com/support). Toute altération ou modification du luminaire peut annuler la garantie du fabricant.
- Assurez-vous que le montage des lampes dans la partie à clipser est correct. Attention aux aiguilles de connexion!
- Ne laissez jamais l'extrémité de la sangle à découvert. Utilisez toujours un "End Cap". Risque d'électrocution.
- Ne reliez jamais différents morceaux de sangle.
- Ne manipulez et ne coupez jamais la sangle lorsqu'elle est branchée.
- Ne branchez jamais la sangle directement au réseau électrique.
- N'accrochez pas d'autres objets à la sangle du luminaire.
- Pendant l'installation, laissez la sangle dans son emballage d'origine pour éviter qu'elle ne soit salie.
- Utilisez toujours les outils fournis par VIBIA.com pour tendre la sangle et fixer les lampes.
- Pour fixer la sangle, partez toujours du point de raccordement électrique de la composition.
- Commencez votre installation en utilisant le ruban de papier fourni par VIBIA pour définir correctement les distances de la sangle.
- N'ajoutez jamais sur la sangle plus de lampes que celles qui ont été prévues et qui sont spécifiées dans le manuel de la composition. Chaque composition a ses propres luminaires. Ne pas mélanger.





Plusminus video  
installation

Vibia Lighting, S.L.U.

Spain & Portugal T. +34 934 796 970

International T. +34 934 796 971

[customer.service@vibia.com](mailto:customer.service@vibia.com)

[www.vibia.com](http://www.vibia.com)

VIBIA